

CERTIFIED RECORD OF LAND CORNER MONUMENTATION

**HISTORY OF ORIGINAL CORNER ESTABLISHMENT:**

Corner originally established by D.P. Thompson under GLO contract number 103, dated Sept. 3, 1863. Surveyor General record states:

Set Post for corner to 1,2,11,12 in mound of earth with charred stake, and pit trench as per instructions.

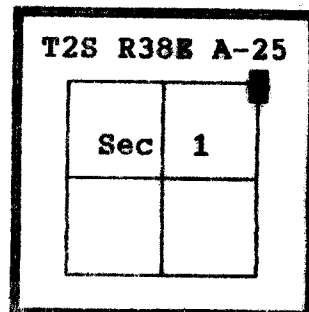

DIAGRAM

**DESCRIPTION OF CORNER EVIDENCE FOUND:**

NONE

Area is in the intersection of Sandridge Road and Monroe Lane.

See Map of Survey No. 017-1993.

**DESCRIPTION OF MONUMENT AND ACCESSORIES I ESTABLISHED**

**TO PERPETUATE THE ORIGINAL LOCATION OF THIS CORNER:**

At the intersection of the center line of Sandridge Road and Monroe Lane, I set an aluminum pipe with cap marked as shown 36" in the ground, Approximately 6" below the surface of the road, from which;

- A 5/8" X 30" Rebar with aluminum cap mk'd "UNION COUNTY SURVEYOR NE RP" bears East, 30.42 ft.
- A 5/8" X 30" Rebar with aluminum cap mk'd "UNION COUNTY SURVEYOR SE RP" bears S24°E, 27.55 ft.
- A 12" Power pole with a PK nail in the right side, bears S32°W, 67.50 feet.
- A 5/8" X 30" Rebar with aluminum cap mk'd "UNION COUNTY SURVEYOR NW RP" bears N52°W, 32.03 ft.

I hereby certify that the above corner point was perpetuated as hereon described on April 24, 1993.

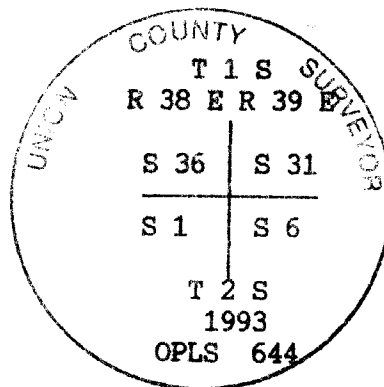

REGISTERED PROFESSIONAL LAND SURVEYOR

*Duane I. Griffith*

OREGON  
JULY 10 1964  
DUANE I. GRIFFITH  
644

I used a steel tape and magnetic compass in the establishment of new accessories. I used 20° East magnetic declination and the distances are to the point as noted.

UNION COUNTY SURVEYOR

Date Received 4/26/93

Date Filed 5/6/93

By Gregory T. Blakely

File No. 010-1993R

A-1  
A-25 (5125)

# HORIZONTAL CONTROL DATA

## UNION COUNTY, OREGON

### OREGON STATE PLANE, NORTH ZONE (3601)

STA NAME: 200902

SECTION CORNER COMMON TO SECTIONS: 31, 36, 1 and 6

TWP. 1 S. RGE. 38 E.  
& 2 & 39

GEODETIC COORD: NAD 83(91)

DATE TIED: February 11, 2009

LAT: 45 ° 25 ' 39.76665 " N

SURVEYOR: RICK G. ROBINSON  
OPLS 2219

LONG: 117 ° 59 ' 37.46939 " W

FIRM: BAGETT, GRIFFITH, & BLACKMAN  
2006 ADAMS AVENUE  
LAGRANDE, OR 97850  
(541) 963-6092

SP. COOR: NAD 83(91)

N: 652010.148 INT FT.

E: 8845422.190 INT FT.

TYPE: GPS

THETA: 1 ° 46 ' 38.6525481 "

ORDER: SECOND CLASS: 1

SCALE FACTOR: 0.9999047792

ELEV: 2788.35 US FT.

ELEV: DATUM: NGVD 29

**COMMENTS:**

Corner is 2 1/2"x30" aluminum pipe with  
2 1/2" aluminum cap marked as shown:  
Monument is set 6" below surface of the  
roadway at the intersection of Monroe  
Lane and Sandridge Road

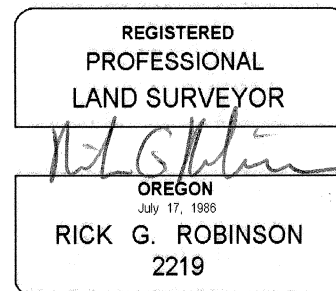
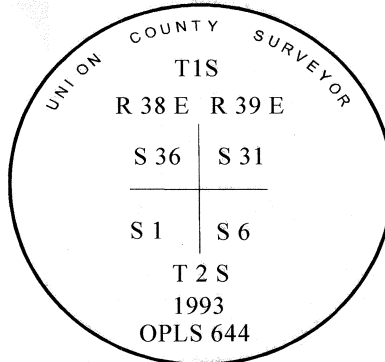

1 METER = 3.2808333333... US FEET = 39.37 INCHES

1 METER = 3.280839895 INT'L FEET OR 1 INCH = 2.54 CM

TO CALCULATE ELEVATION FACTOR ( IN THE NORTH AMERICAN CONTINENT)

DIVIDE 20,906,000 BY (20,906,000 + ELLIPSOID ELEV. IN FEET)