

UNION COUNTY SURVEYOR

CERTIFIED RECORD OF LAND CORNER MONUMENTATION

HISTORY OF ORIGINAL CORNER ESTABLISHMENT:

Corner originally established by David P. Thompson under GLO contract number 103, dated September 3, 1863. Surveyor General records states:

Set post for 1/4 sec cor in mound of stone.

No record of subsequent monumentation found in Union County survey records.

T 2 S R 38 E V-15

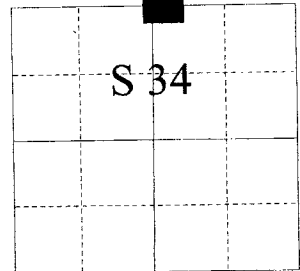

DESCRIPTION OF CORNER EVIDENCE FOUND:

NONE

See Survey No. 033-1995

DESCRIPTION OF MONUMENT AND ACCESSORIES I ESTABLISHED

TO PERPETUATE THE ORIGINAL LOCATION OF THIS CORNER:

At position determined by Survey No. 033-1995 I set a 2 1/2" x 30" copper clad monument in a water valve box, marked as shown below, 36" in the ground from which:

A 5/8" x 30" rebar with 1 1/2" aluminum cap bears N49°E, a distance of 36.44 feet, marked UNION COUNTY SURVEYOR NE RP.

A 5/8" x 30" rebar with 1 1/2" aluminum cap bears S39°E, a distance of 35.18 feet, marked UNION COUNTY SURVEYOR SE RP.

A 5/8" x 30" rebar with 1 1/2" aluminum cap bears S45°W, a distance of 34.67 feet, marked UNION COUNTY SURVEYOR SW RP.

A 5/8" x 30" rebar with 1 1/2" aluminum cap bears N45°W, a distance of 39.07 feet, marked UNION COUNTY SURVEYOR NW RP.

I hereby certify that the corner was monumented on January 22, 2001
Witness: Norbert W. Volny and Gregory T. Blackman, Jr.

REGISTERED
PROFESSIONAL
LAND SURVEYOR

Gregory T. Blackman
OREGON
JULY 13, 1973
GREGORY T. BLACKMAN
991

Renewal Date: Dec. 31, 2001

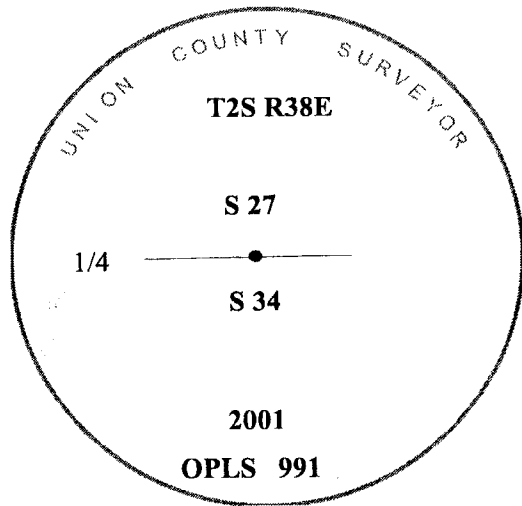

UNION COUNTY SURVEYOR

Date Received 2/13/01

Date Filed 3/2/01

Filed By R. ROBINSON, DEPUTY

File Number 005-2001R

I used a compass and steel tape in the establishment of the new accessories. I used 18° East declination. The distances are to the center of a 5/8"x30" rebar with 1 1/2" aluminum cap marked Union County Survey Marker.

HORIZONTAL CONTROL DATA
UNION COUNTY, OREGON
OREGON STATE PLANE, NORTH ZONE (3601)

STA NAME: 200114

QUARTER COMMON TO: 34 & 27

TWP. 2 S. RGE. 38 E.

GEODETIC COORD: NAD 83(91)

DATE TIED: 26 JAN. 2001

LAT: 45 ° 21 ' 17.45778 " N

SURVEYOR: GREGORY T. BLACKMAN
OPLS 991

LONG: 118 ° 2 ' 42.97062 " W

FIRM: BAGETT, GRIFFITH, & BLACKMAN
2006 ADAMS AVENUE
LAGRANDE, OR 97850
(541) 963-6092

SP. COOR: NAD 83(91)

N: 625050.623 INT FT.

E: 8833006.777 INT FT.

TYPE: GPS

THETA: 1 ° 44 ' 27.0976703 "

ORDER: SECOND CLASS: 1

SCALE FACTOR: 0.9998998465

ELEV: 2733.93 US FT.

ELEV: DATUM: NGVD 29

COMMENTS:

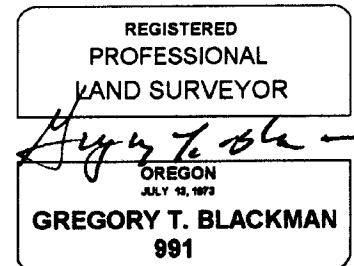

Renewal Date: Dec. 31, 2001

1 METER = 3.280833333... US FEET = 39.37 INCHES

1 METER = 3.280839895 INT'L FEET OR 1 INCH = 2.54 CM

TO CALCULATE ELEVATION FACTOR (IN THE NORTH AMERICAN CONTINENT)

DIVIDE 20,906,000 BY (20,906,000 + ELLIPSOID ELEV. IN FEET)