

**UNION COUNTY SURVEYOR**

**CERTIFIED RECORD OF LAND CORNER MONUMENTATION**

**HISTORY OF ORIGINAL CORNER ESTABLISHMENT:**

Corner originally established by David P. Thompson under GLO contract number 103, dated September 3, 1863. Surveyor General records states:

Set post for 1/4 sec cor in mound of stone

No record of subsequent monumentation found in Union County survey records.

T 2 S R 38 E V-07

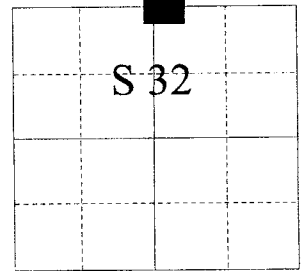

**DESCRIPTION OF CORNER EVIDENCE FOUND:**

NONE

See Survey No. 62-78

**DESCRIPTION OF MONUMENT AND ACCESSORIES I ESTABLISHED TO PERPETUATE THE ORIGINAL LOCATION OF THIS CORNER:**

At position determined by Survey No. 62-78, I set a 2 1/2" x 30" aluminum monument, marked as shown below, 27" in the ground from which:

A 5/8" x 30" rebar with 1 1/2" aluminum cap bears N43°E, a distance of 7.63 feet, marked UNION COUNTY SURVEYOR NE RP.

A 5/8" x 30" rebar with 1 1/2" aluminum cap bears S40°E, a distance of 10.73 feet, marked UNION COUNTY SURVEYOR SE RP.

A 5/8" x 30" rebar with 1 1/2" aluminum cap bears S46°W, a distance of 12.80 feet, marked UNION COUNTY SURVEYOR SW RP.

A 5/8" x 30" rebar with 1 1/2" aluminum cap bears N57°W, a distance of 10.62 feet, marked UNION COUNTY SURVEYOR NW RP.

I set a steel fence post approximately 2 ft. North of the monument. I hereby certify that the corner was monumented on January 17, 2001  
Witness: Norbert W. Volny and Gregory T. Blackman, Jr.

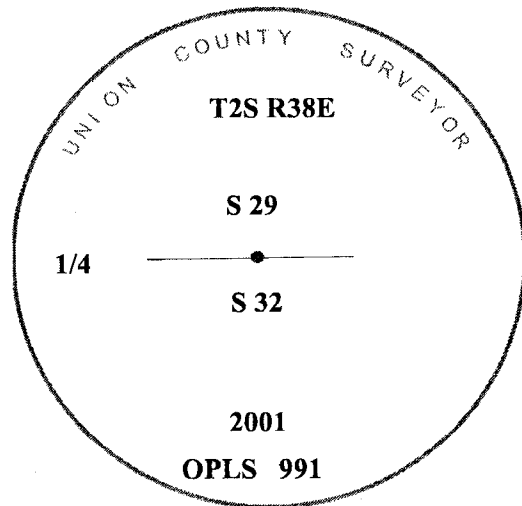
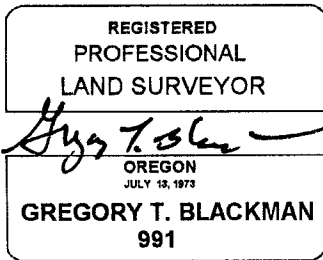

**UNION COUNTY SURVEYOR**

Date Received 2/13/01

Date Filed 3/2/01

Filed By R. Robinson, Deputy

File Number 006-2001R

I used a compass and steel tape in the establishment of the new accessories. I used 18° East declination. The distances are to the center of a 5/8"x30" rebar with 1 1/2" aluminum cap marked Union County Survey Marker.

**HORIZONTAL CONTROL DATA  
UNION COUNTY, OREGON  
OREGON STATE PLANE, NORTH ZONE (3601)**

STA NAME: 200115

QUARTER COMMON TO: 32 & 29

TWP. 2 S. RGE. 38 E.

GEODETIC COORD: NAD 83(91)

DATE TIED: 26 JAN. 2001

LAT: 45 ° 21 ' 17.29855 " N

SURVEYOR: GREGORY T. BLACKMAN  
OPLS 991

LONG: 118 ° 5 ' 11.26984 " W

FIRM: BAGETT, GRIFFITH, & BLACKMAN  
2006 ADAMS AVENUE  
LAGRANDE, OR 97850  
(541) 963-6092

SP. COOR: NAD 83(91)

N: 624715.511 INT FT.

E: 8822422.825 INT FT.

TYPE: GPS

THETA: 1 ° 42 ' 41.9259343 "

ORDER: SECOND CLASS: 1

SCALE FACTOR: 0.999899844

ELEV: 2944.61 US FT.

ELEV: DATUM: NGVD 29

COMMENTS:

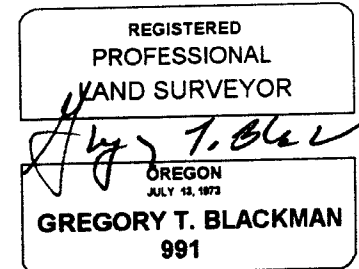

Renewal Date: Dec. 31, 2001

1 METER = 3.2808333333... US FEET = 39.37 INCHES

1 METER = 3.280839895 INT'L FEET OR 1 INCH = 2.54 CM

TO CALCULATE ELEVATION FACTOR ( IN THE NORTH AMERICAN CONTINENT)

DIVIDE 20,906,000 BY (20,906,000 + ELLIPSOID ELEV. IN FEET)