

**CERTIFIED RECORD OF LAND CORNER MONUMENTATION**

**HISTORY OF ORIGINAL CORNER ESTABLISHMENT:**

Corner originally established by DAVID P. THOMPSON under GLO contract number 103, dated September 3, 1863

Set post in mound of earth with charcoal stake with pits for 1/4 section corner as per instructions.

No record of subsequent monumentation found in Union County survey records. See Survey Number 038-2006

**DESCRIPTION OF CORNER EVIDENCE FOUND:**

None

**DESCRIPTION OF MONUMENT AND ACCESSORIES I ESTABLISHED TO PERPETUATE THE ORIGINAL LOCATION OF THIS CORNER:**

At proportioned position, I set a 2 1/2" x 30" Copper Clad monument marked as shown below, buried 36" deep on the West Edge of Hunter road.

**NEW BEARING OBJECTS:**

- A 5/8" Rebar with 1 1/2" aluminum cap bears N49°36'05"E, 44.45 feet marked NE RP.
- A 5/8" Rebar with 1 1/2" aluminum cap bears S39°11'55"E, 52.48 feet marked SE RP.
- A 5/8" Rebar with 1 1/2" aluminum cap bears S49°21'03"W, 30.19 feet marked SW RP.
- A 5/8" Rebar with 1 1/2" aluminum cap bears N12°45'43"W, 22.21 feet marked NW RP.

I hereby certify that the corner was monumented on November 1, 2006  
Witness: Leo Castillo

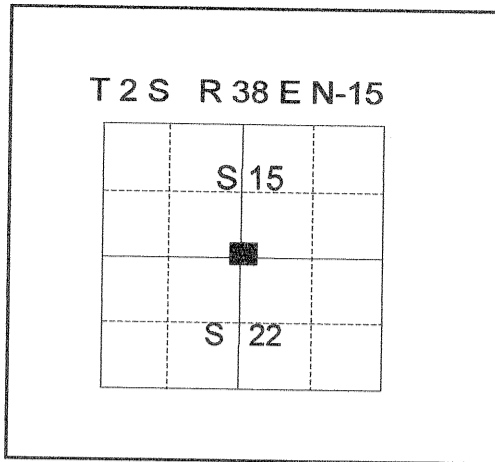

REGISTERED  
PROFESSIONAL  
LAND SURVEYOR

OREGON  
JULY 13, 1973  
GREGORY T. BLACKMAN  
991

Renewal Date: Dec. 31, 2007

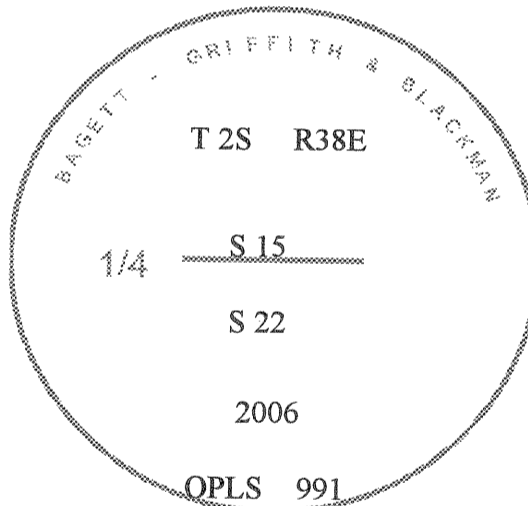

**UNION COUNTY SURVEYOR**

Date Received 11/16/06

Date Filed 12/01/06

Filed By R. Robinson, Deputy

File Number 030-2006R

I used a Leica 500 GPS in the establishment of the new accessories. The distances are to the center of a 5/8" rebar with a 1 1/2" aluminum cap marked BGB RP.

# HORIZONTAL CONTROL DATA

## UNION COUNTY, OREGON

### OREGON STATE PLANE, NORTH ZONE (3601)

STA NAME: 200616

1/4 SECTION CORNER COMMON TO SECTIONS 15 and 22

TWP. 2 S. RGE. 38 E.

GEODETIC COORD: NAD 83(91)

DATE TIED: November 6, 2006

LAT: 45 ° 23 ' 2.53818 " N

SURVEYOR: RICK G. ROBINSON  
OPLS 2219

LONG: 118 ° 2 ' 43.29443 " W

FIRM: BAGETT, GRIFFITH, & BLACKMAN  
2006 Adams Avenue  
La Grande, OR 97850  
(541) 963-6092

SP. COOR: NAD 83(91)

N: 635687.116 INT FT.

E: 8832660.381 INT FT.

TYPE: GPS

THETA: 1 ° 44 ' 26.8680284 "

ORDER: SECOND CLASS: 1

SCALE FACTOR: 0.9999016283

ELEV: 2719.71 US FT.

ELEV: DATUM: NGVD 29

**COMMENTS:**

Corner is a 5/8"x30" "copper clad pin with  
2 1/2" brass cap marked:

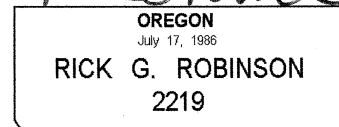
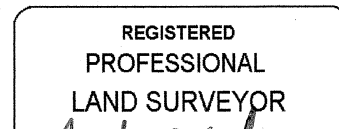
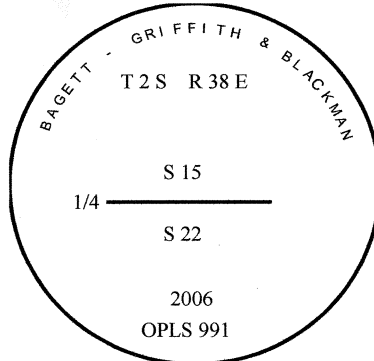

Renewal Date: December 31, 2006

1 METER = 3.280833333... US FEET = 39.37 INCHES

1 METER = 3.280839895 INT'L FEET OR 1 INCH = 2.54 CM

TO CALCULATE ELEVATION FACTOR ( IN THE NORTH AMERICAN CONTINENT)

DIVIDE 20,906,000 BY (20,906,000 + ELLIPSOID ELEV. IN FEET)