

CERTIFIED RECORD OF LAND CORNER MONUMENTATION

HISTORY OF ORIGINAL CORNER ESTABLISHMENT:

Corner originally established by DAVID P. THOMPSON under GLO contract number 103, dated September 3, 1863.

Set post for 1/4 section corner from which, A Pine 24" diameter bears S15°E, 125 LKS distance.

A Pine 15" diameter bears S10°W, 185 LKS distance..

Surveys 2-65 and 61-71 call finding a 1" iron pipe.

Surveys 51-72 and 57-72 call finding a 3/4" iron pipe.

Survey 58-77 calls finding monument of record.

No record of subsequent monumentation found in UNION COUNTY survey records.

DESCRIPTION OF CORNER EVIDENCE FOUND:

Found 1" iron pipe as per survey # 61-71.

DESCRIPTION OF MONUMENT AND ACCESSORIES I ESTABLISHED TO PERPETUATE THE ORIGINAL LOCATION OF THIS CORNER:

In place of found iron pipe, I set a 2 1/2" x 30" aluminum pipe with 2 1/2" aluminum cap marked as shown below, 26" in the ground.

NEW BEARING OBJECTS:

A 5/8" x 30" iron pin with 1 1/2" aluminum cap bears N5°E, 14.13 feet marked UNION COUNTY SURVEYOR NE RP.

A 5/8" x 30" iron pin with 1 1/2" aluminum cap bears S43°E, 1.92 feet marked UNION COUNTY SURVEYOR SE RP.

A 5/8" x 30" iron pin with 1 1/2" aluminum cap bears S54°W, 4.18 feet marked UNION COUNTY SURVEYOR SW RP.

A 5/8" x 30" iron pin with 1 1/2" aluminum cap bears N43°W, 17.87 feet marked UNION COUNTY SURVEYOR NW RP.

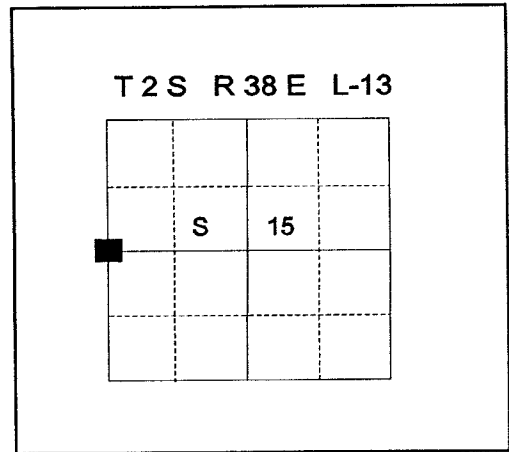

I hereby certify that the corner was monumented on October 7, 1996.
Witness: Mark Durbin

REGISTERED
PROFESSIONAL
LAND SURVEYOR

Gregory T. Blackman
OREGON
JULY 13, 1973
GREGORY T. BLACKMAN
991

Renewal Date: December, 31 1997

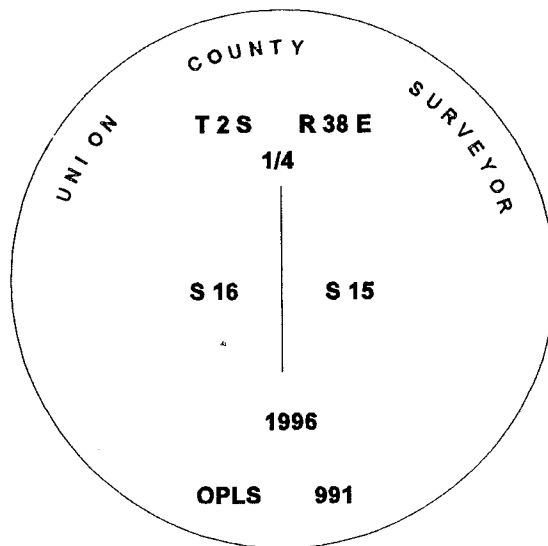

UNION COUNTY SURVEYOR

Date Received 10-30-96

Date Filed 12-18-96

Filed By R. ROBINSON, DEPUTY

File Number 120-1996 R

I used a steel tape and magnetic compass in the establishment of the new accessories. I used 18° East declination.

HORIZONTAL CONTROL DATA

UNION COUNTY, OREGON

OREGON STATE PLANE, NORTH ZONE (3601)

STA NAME: 200710

1/4 SECTION CORNER COMMON TO SECTIONS: 15 and 16

TWP. 2 S. RGE. 38 E.

GEODETIC COORD: NAD 83(91)

DATE TIED: February 27, 2007

LAT: 45 ° 23 ' 28.70206 " N

SURVEYOR: RICK G. ROBINSON
OPLS 2219

LONG: 118 ° 3 ' 20.10790 " W

FIRM: BAGETT, GRIFFITH, & BLACKMAN
2006 ADAMS AVENUE
LAGRANDE, OR 97850
(541) 963-6092

SP. COOR: NAD 83(91)

N: 638256.038 INT FT.

E: 8829954.126 INT FT.

TYPE: GPS

THETA: 1 ° 44 ' 0.76042858 "

ORDER: SECOND CLASS: 1

SCALE FACTOR: 0.9999021123

ELEV: 2758.07 US FT.

ELEV: DATUM: NGVD 29

COMMENTS:

Corner is 2 1/2"x30" aluminum pipe with
2 1/2" aluminum cap marked as shown:

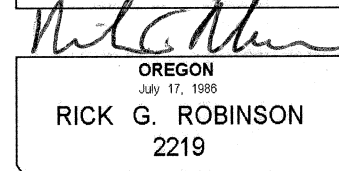
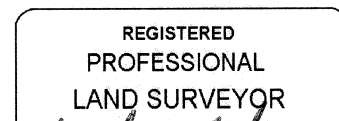
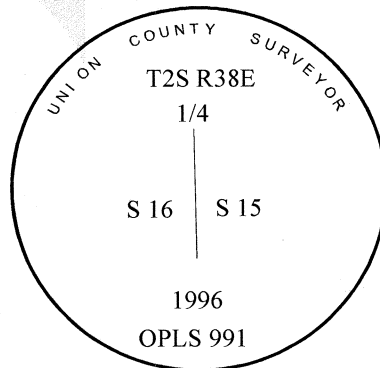

Renewal Date: December 31, 2008

1 METER = 3.280833333... US FEET = 39.37 INCHES

1 METER = 3.280839895 INT'L FEET OR 1 INCH = 2.54 CM

TO CALCULATE ELEVATION FACTOR (IN THE NORTH AMERICAN CONTINENT)

DIVIDE 20,906,000 BY (20,906,000 + ELLIPSOID ELEV. IN FEET)