

UNION COUNTY SURVEYOR

CERTIFIED RECORD OF LAND CORNER MONUMENTATION

HISTORY OF ORIGINAL CORNER ESTABLISHMENT:

Corner originally established Herman D. Gradon, under GLO Contract No. 452, dated March 31, 1882. Surveyor General record states: Set basalt stone 17x11x4 marked 1/4 for corner, from which:
A fir 17 ins diam, bears S65°E, 32 lks dist marked 1/4S BT
A fir 6 ins diam, bears S75°W, 15 lks dist marked 1/4S BT

No record of subsequent monumentation found in the Union County monumentation records

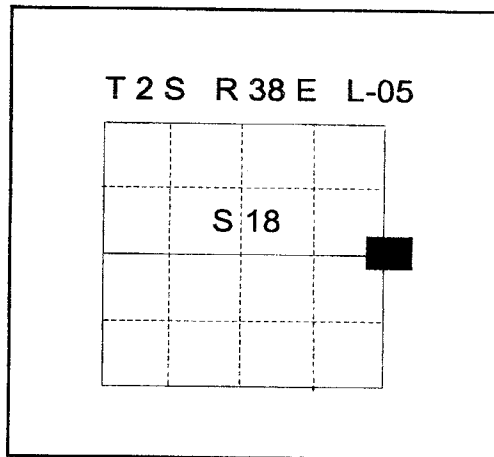

DESCRIPTION OF CORNER EVIDENCE FOUND:

No evidence found of original corner monument or its' accessories
Survey Number 87-79 established a position for the 1/4 corner, but set no monument.

See Survey Number 042-2001

DESCRIPTION OF MONUMENT AND ACCESSORIES I ESTABLISHED TO PERPETUATE THE ORIGINAL LOCATION OF THIS CORNER:

At the position of the 1/4 corner established by survey number 87-79, I set a 2 1/2" x 30" aluminum pipe with aluminum cap marked as shown below, 36" in the ground, from which;

NEW BEARING TREES:

- A 13" diameter Douglas Fir bears North 81° East, a distance of 25.95 feet marked X BT.
- A 13" diameter Douglas Fir bears South 46° East, a distance of 87.50 feet, marked 1/4 S17 BT.
- A 11" diameter White Fir bears South 59° West, a distance of 100.20 feet, marked 1/4 S18 BT.
- A 9" diameter Ponderosa Pine bears North 50° West, a distance of 103.85 feet, marked 1/4 S18 BT.

I hereby certify that the corner was monumented on November 1, 2001.
Witness: Norbert W. Volny and Gregory T. Blackman Jr.

REGISTERED
PROFESSIONAL
LAND SURVEYOR



OREGON
July 17, 1986
RICK G. ROBINSON
2219

Renewal Date December 31, 2002

BAGETT - GRIFFITH & BLACKMAN

T 2 S R 38 E

1/4

S 18 | S 17

2001

OPLS 2219

**UNION COUNTY
SURVEYOR**

Date Received 11/29/01

Date Filed 12/05/01

Filed By Gregory T. Blackman

File Number 047-2001R

I used a steel tape and magnetic compass in the establishment of the new accessories. I used 18° East declination, the distances are to a 60d spike driven into the right side of the root crown of the bearing tree. I attached a brass washer marked OPLS 2219 to the BT blaze.

HORIZONTAL CONTROL DATA

UNION COUNTY, OREGON

OREGON STATE PLANE, NORTH ZONE (3601)

STA NAME: 200518

1/4 SECTION CORNER COMMON TO SECTIONS: 17 and 18

TWP. 2 S. RGE. 38 E.

GEODETIC COORD: NAD 83(91)

DATE TIED: August 3, 2005

LAT: 45 ° 23 ' 28.088230 " N

SURVEYOR: RICK G. ROBINSON
OPLS 2219

LONG: 118 ° 5 ' 48.39298 " W

FIRM: BAGETT, GRIFFITH, & BLACKMAN
2006 ADAMS AVENUE
LAGRANDE, OR 97850
(541) 963-6092

SP. COOR: NAD 83(91)

N: 637876.491 INT FT.

E: 8819379.284 INT FT.

TYPE: GPS

THETA: 1 ° 42 ' 15.5987257 "

ORDER: SECOND CLASS: 1

SCALE FACTOR: 0.9999021007

ELEV: 3620.86 US FT.

ELEV: DATUM: NGVD 29

COMMENTS:

Corner is a 2 1/2" aluminum monument in the
Westerly track of a road.
Cap is marked as shown:

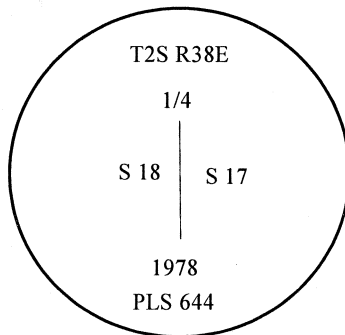

REGISTERED
PROFESSIONAL
LAND SURVEYOR

Rick G. Robinson
OREGON
July 17, 1888
RICK G. ROBINSON
2219

Renewal Date: December 31, 2006

1 METER = 3.280833333... US FEET = 39.37 INCHES

1 METER = 3.280839895 INT'L FEET OR 1 INCH = 2.54 CM

TO CALCULATE ELEVATION FACTOR (IN THE NORTH AMERICAN CONTINENT)

DIVIDE 20,906,000 BY (20,906,000 + ELLIPSOID ELEV. IN FEET)

UNION COUNTY SURVEYOR

CERTIFIED RECORD OF LAND CORNER MONUMENTATION

HISTORY OF ORIGINAL CORNER ESTABLISHMENT:

Corner originally established by Herman D. Gradon, under GLO Contract No. 452, dated March 31, 1882. Surveyor General record states: Set basalt stone 17x11x4 marked 1/4 for corner, from which:

A fir 17 ins diam, bears S65°E, 32 lks dist marked 1/4S BT

A fir 6 ins diam, bears S75°W, 15 lks dist marked 1/4S BT

Corner remonumented by Rick G. Robinson 11/01/01, corner record states:

I set a 2 1/2"X30" aluminum pipe with aluminum cap marked as shown below, 36" in the ground, from which;

New Bearing Trees:

A 13" diameter douglas fir bears north 81° east, a distance of 25.95 Feet marked X BT.

A 13" diameter douglas fir bears south 46° east, a distance of 87.50 feet, marked 1/4 S17 BT.

A 11" diameter white fir bears south 59° west, a distance of 100.20 feet, marked 1/4 S18 BT.

A 9" diameter ponderosa pine bears north 50° west, a distance of 103.85 feet, marked 1/4 S18 BT.

No record of subsequent monumentation found in the Union County monumentation records

DESCRIPTION OF CORNER EVIDENCE FOUND:

No evidence found of original corner monument or its' accessories Survey Number 87-79 established a position for the 1/4 corner, but set no monument.

Found 2001 corner accessories as stated above, corner monument destroyed.

DESCRIPTION OF MONUMENT AND ACCESSORIES I ESTABLISHED

TO PERPETUATE THE ORIGINAL LOCATION OF THIS CORNER:

At record bearing and distance from 2001 accessories I set a 2 1/2"X30" aluminum pipe with aluminum cap marked as shown below, 32" in the ground.

I hereby certify that the corner was monumented on August 30, 2004.

Witness: Mike Spicer

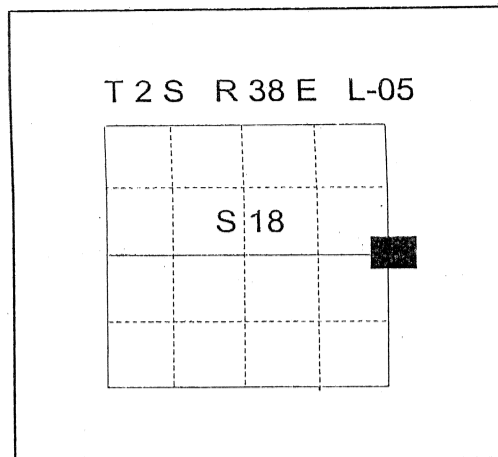

REGISTERED
PROFESSIONAL
LAND SURVEYOR

Gregory T. Blackman
OREGON
JULY 13, 1973
GREGORY T. BLACKMAN
991

Renewal Date: December 31, 2005

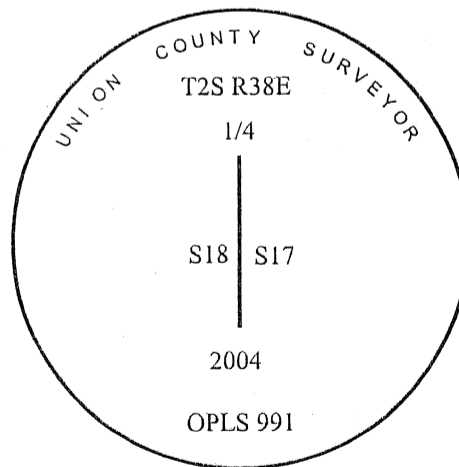

UNION COUNTY SURVEYOR

Date Received 10/15/04

Date Filed 12/21/04

Filed By *Gregory T. Blackman*

File Number 086-2004

I used a steel tape and magnetic compass in the retracement of the new accessories. I used 18° East declination, the distances are to a 60d spike driven into the right side of the root crown of the bearing tree.

L-05