

**CERTIFIED RECORD OF LAND CORNER MONUMENTATION**

**HISTORY OF ORIGINAL CORNER ESTABLISHED:**

Corner originally established by John A. Hurlburt under GLO contract number 201, dated August 5, 1873. Surveyor General field notes state:

Set pine post 4 ft. long 3 in. thick 2 ft. in ground for 1/4 sec. cor.  
Pine 12 in. dia. S63°E 32 lks.  
Fir 5 in. dia. North 30 lks.

Corner noted by Roscoe Neal in 1930. Union County Survey record "Stoddard LMBR. Co. Survey of Perry", dated 12-20-30 and recorded as 033-1991 states:  
2" iron pipe.

Corner found by Ronald Brazeau in 1974. Union County Survey record 59-74 states:  
Found E 1/4 cor. sec. 34, 2" iron pipe.

Corner found by James Voelz in 1976. Union County Survey record 67-76 states:  
Found 2" iron pipe, 1/4 cor. 34/35.

Corner found by Howard Perry in 1980. Union County Survey record 40-80 states:  
Found 2" iron pipe. See Stoddard LMBR. Co. Survey, 12-20-30 by Roscoe Neal, PE 904. Copy in custody of Union Co. Assessor.

Corner found by Peter Elder in 2013. Union County Survey record 003-2013 states:  
Found a 2" diam. iron pipe, up 7" on steep slope in brush, approximately 20 ft. vertical above flat with locust grove, approx. 200' North of railroad.

T 2 S R 37 E X-17

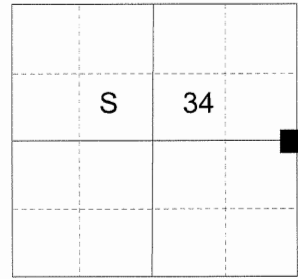

**DESCRIPTION OF CORNER EVIDENCE FOUND:**

Found a 2" iron pipe, 2" above ground.

**DESCRIPTION OF MONUMENT AND ACCESSORIES I ESTABLISHED TO PERPETUATE THE ORIGINAL LOCATION OF THIS CORNER:**

At the center of the found iron pipe I set a 1/2" x 30" copper clad iron pin, driven into the center of the pipe and set in concrete, with 2 1/2" brass cap marked as shown below, from which:

**NEW BEARING OBJECTS:**

- A 5/8" x 30" iron pin with 1 1/2" aluminum cap bears North, a dist. of 25.00 ft., marked Union County Surveyor N RP.
- A 5/8" x 30" iron pin with 1 1/2" aluminum cap bears South, a dist. of 25.00 ft., marked Union County Surveyor S RP.
- A 5/8" x 30" iron pin with 1 1/2" aluminum cap bears East, a dist. of 8.10 ft., marked Union County Surveyor E RP.
- A 5/8" x 30" iron pin with 1 1/2" aluminum cap bears North, a dist. of 25.20 ft., marked Union County Surveyor W RP.

**REGISTERED PROFESSIONAL LAND SURVEYOR**



OREGON  
June 2, 2010  
**JEFFREY S. HSU**  
83571

Renewal Date: June 30, 2019

**UNION COUNTY SURVEYOR**

Date Received 2/19/19

Date Filed 2/19/19

Filed By MLG

File Number 009-2019R

I hereby certify that the corner was perpetuated on January 25, 2019.  
Witness: Kyle A. Tucker

I used a steel tape and magnetic compass in the establishment of the new accessories. I used 13° East declination, the distances and bearings are to the center of the aluminum caps.

# HORIZONTAL CONTROL DATA

## UNION COUNTY, OREGON

### OREGON STATE PLANE, NORTH ZONE (3601)

STA NAME: 2019006

1/4 SECTION CORNER COMMON TO SECTIONS 34 AND 35

TWP. 2 S RGE. 37 E.

GEODETIC COORD: NAD 83(91)

DATE TIED: January 24, 2019

LAT: 45 ° 20 ' 52.159897 " N

SURVEYOR: RICK G. ROBINSON  
OPLS 2219

LONG: 118 ° 9 ' 31.11861 " W

FIRM: BAGETT, GRIFFITH, & BLACKMAN  
2006 ADAMS AVENUE  
LAGRANDE, OR 97850  
(541) 963-6092

SP. COOR: NAD 83(91)

N: 621624.729 INT FT.

E: 8803950.232 INT FT.

TYPE: GPS

THETA: 1 ° 39 ' 37.6448205 "

ORDER: SECOND CLASS: 1

SCALE FACTOR: 0.9998994563

ELEV: 2917.56 US FT.

ELEV: DATUM: NGVD 29

**COMMENTS:**

2 1/2" Brass cap set in existing 2" pipe  
(monument cap marked as shown)

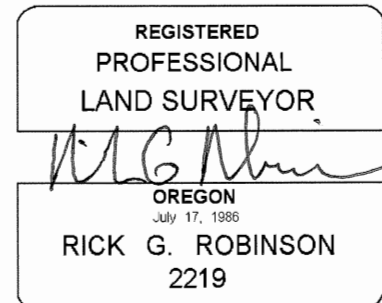
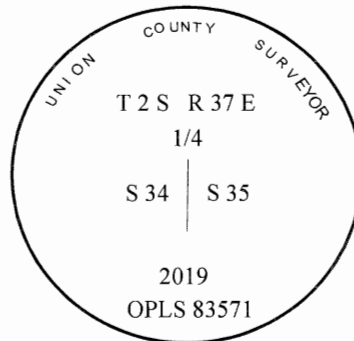

Renewal Date: December 31, 2020

1 METER = 3.280833333... US FEET = 39.37 INCHES

1 METER = 3.280839895 INT'L FEET OR 1 INCH = 2.54 CM

TO CALCULATE ELEVATION FACTOR ( IN THE NORTH AMERICAN CONTINENT)

DIVIDE 20,906,000 BY (20,906,000 + ELLIPSOID ELEV. IN FEET)