

RESTORED CORNERS

Section 31, Township 2 South, Range 37 East W. M.

Hilgard Junction State Park

Union County

August 28, 1969

Var 20°

SECTION CORNER 5, 6, 31 and 32

ORIGINAL:

Post and mound of stone (found rotted post and mound of stone and Forest Service tag dated 1947)

RESTORED:

19" Pine S15°W 34.8 ft. scribed, "T3SR37ES6BTRS691"
18" Pine S63°W 82.8 ft. scribed, "T3SR37ES6BT"
18" Pine N1°W 87.4 ft. scribed, "T2SR37ES31BT"
No trees available in other sections.
Yellow corner tag on 19" BT.

Witnessed by: A. Slack
R. Hemmer
T. Stose

UNION COUNTY SURVEYOR	
Date Received	_____
Date Filed	_____
By	_____
File No.	316-84R

SECTION CORNER 29, 30, 31 and 32

ORIGINAL:

Stone and mound (found stone out of place)
15" Pine S31°W 105 LKS. (now 24" stump, scribe visible)

RESTORED:

Reset stone from BT.
Erected mound of stone around cornerstone.
Pine N75°W 111.2 ft. scribed, "T2SR37ES30BTRS691"
Yellow corner tag on new Pine BT.
Another mound of stones bears South 6 ft.

Witnessed by: A. Slack
R. Hemmer
T. Stose

T2S R37E

UNION COUNTY SURVEYOR	
Date Received	_____
Date Filed	_____
By	_____
File No.	317-84R

4 CORNER 30 and 31

WORK PERFORMED 1969
(G. LANGLITZ, DEP. CO. SURVEYOR)

ORIGINAL:

Stone (found out of place)
12" Pine N41°E 21 LKS. (now 12" stump, "BT" visible)
12" Pine S30°E 25 LKS. (now missing)

RESTORED:

Set original stone in place.
Erected mound of stone around cornerstone.
Set 4" x 4" x 48" white post 1 ft. South of corner.
10" Pine S79°W 6.3 ft. scribed, "1/4S31BTRS691"
10" Pine N36°E 23.2 ft. scribed, "1/4S30BT"

Witnessed by: J. Hollingsworth
E. Haury
R. Hemmer
T. Stose

UNION COUNTY SURVEYOR	
Date Received	_____
Date Filed	_____
By	_____
File No.	318-84R

REGISTERED OREGON LAND SURVEYOR

John E. Hollingsworth

JULY 9, 1965
John E. Hollingsworth
691

Index File No. V-5 CORNER RECORD (SEARCH) (Ref. FSM 7151.4) Tract or Survey No. _____ Cor. NE COR
 T 25 R. 37E R.D. LAGRANDE County UNION No. Sec 31
 Merid. W11 N.F. W-W State OR

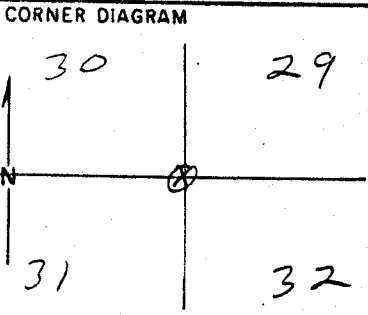

DESCRIBE CORNER MONUMENT FOUND
 BASALT STONE 27" X 18" X 8"
 APPARENT "X" MARKED ON EAST FACE
 MOUND OF STONES ALONG SIDE.

DESCRIBE BEARING TREES OR OTHER OFFICIAL ACCESSORIES FOUND
 SEC. 31 - ONE STUMP "B.T." SCRIBED VISIBLY
 SEC. 30 - 18" PINE, SCRIBED IN 1969.

PHOTO IDENTIFICATION DATA
 Photo No. _____
 Filed At. _____
 Object Ident. _____
 Ident. By _____
 Signature _____

DESCRIBE CORNER LOCATION RELATIVE TO NEAR-BY FEATURES, ALSO HOW TO REACH CORNER

PLANE COORDINATE POSITION DATA
 State _____ Zone _____
 X _____
 Y _____
 Estab. By _____
 Agency _____

Signature [Signature] Title CET Division _____ Headquarters LAGRANDE Date 6/86 FS-7100-52 (3/68)

UNION COUNTY SURVEYOR

Date Received _____
 Date Filed 12-17-87
 By G. LANGLITZ, DEPUTY
 File No. 209-87R

V-5

CERTIFIED RECORD OF LAND CORNER MONUMENTATION

History of original corner establishment:

Corner originally established by John A. Hurlburt under GLO contract number 201, dated August 5, 1873. Surveyor General record states:
 Set basalt stone 24x15x8, 10 in. in ground and made stone mound 2 ft. high for cor to sections 29-30-31 and 32.
 Pine 15 in. dia. S31°W 105 lks
 No others near.

Corner perpetuated in 1969 by John E. Hollingsworth, OPLS 691. His record states:
 ORIGINAL: Stone and mound (found stone out of place)
 15" Pine S31°W 105 lks (Now 24" stump, scribe visible)
 RESTORED: Reset stone from BT
 Erected mound of stone around cornerstone.
 Pine N75°W 111.2 ft. scribed, "T2SR37ES30BTRS691"
 Yellow corner tag on new Pine BT.
 Another mound of stones bears South 6 ft.

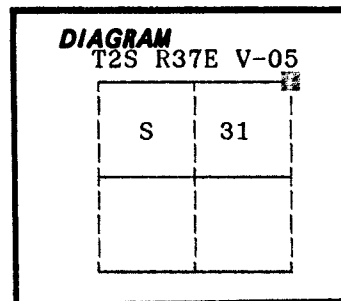

No record of subsequent monumentation found in Union County survey records.

Description of corner evidence found:

Found basalt stone 24x15x8 inches marked with 5 grooves on one face and 1 groove on another, also marked with a cross on the top, set in a mound of stone. Corner stone is breaking up.

Found an 18 inch diameter Ponderosa Pine S75°E, 111.2 feet live and vigorous with scribes visible.

Found a 24 inch diameter Ponderosa Pine stump S31°W, 105 links with BT scribe visible.

Found a mound of stone 6 feet South of the corner stone.

UNION COUNTY SURVEYOR	
Date Received	<u>2-13-89</u>
Date Filed	<u>2-13-89</u>
By	<u>G. LANGLITZ, DEPUTY</u>
File No.	<u>35-89 R</u>

See map of survey dated January, 1989.

Description of monument and accessories I established to perpetuate the

original location of this corner: In place of the found corner stone, I set a 2½" x 30" aluminum pipe with aluminum cap marked as shown, 12 inches in the ground, from which:

New BTs and BOs:

- A 12x12x18 inch rock outcrop bears N38°E, 13.90 feet marked X BO and raised a mound of stone over the outcrop.
- A 5/8x18 inch copper clad iron pin bears S62°E, 8.41 feet with plastic cap marked BGA SURVEY MARKER. Raised a mound of stone around pin.
- A 12 inch diameter Ponderosa Pine bears S55°W, 105.62 feet marked T2S R37E S31 BT.

Painted a 6 inch red band around all BTs and attached bearing tree and land survey monument signs.

Set a steel fencepost approximately 5 feet North with land survey monument sign attached.

Buried stone South and alongside of monument.

Raised mound of stone around monument, 4 ft. base to top of cap

I hereby certify that the above corner point was perpetuated as hereon described on November 4, 1988.

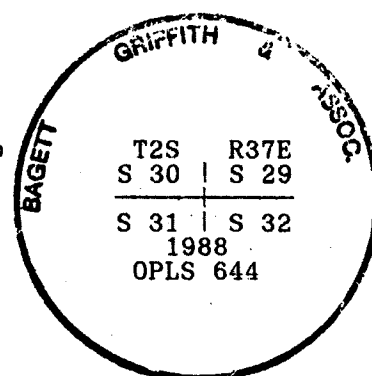

**REGISTERED
PROFESSIONAL
LAND SURVEYOR**

Duane I. Griffith

OREGON
JULY 10, 1964
DUANE I. GRIFFITH
644

I used a steel tape and magnetic compass in the establishment of new accessories. I used 17° East magnetic declination and the distances are to a 50d spike driven in the right side of the root crown. I attached a brass washer marked OPLS 644 to the BT blaze.

Office of..... County of.....
 State of....., I hereby certify that the within instrument was filed in this office
 for record on the..... day of....., 19.....
 by
 (COUNTY OFFICIAL) (DEPUTY)