

Index File No. L-17 CORNER RECORD (SEARCH) (Ref. FSM 7151.4) Tract or Survey No. \_\_\_\_\_ Cor. No. \_\_\_\_\_  
 T 25 R. 30E R.D. LAGRANOE County UNION SE 1/4 COR.  
 Merid. will N.F. W-W State OR or Sec. 15

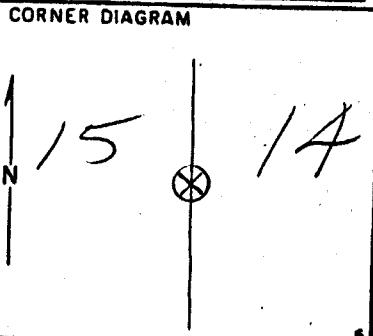

DESCRIBE CORNER MONUMENT FOUND  
 STONE MOUND WITH CORRECT SIZE STONE.  
 DID NOT DISTURB MOUND.

PHOTO IDENTIFICATION DATA  
 Photo No. 1377-92  
 Filed At. LAGRANOE USFS  
 Object Ident. 1/4 CORNER CORNER  
 Ident. By James Lusher  
 Signatory \_\_\_\_\_

DESCRIBE BEARING TREES OR OTHER OFFICIAL ACCESSORIES FOUND  
 SEC. 14 - DOWN; ROTTEN PINE - SLAB WITH  
 1/4 5 SCRIBE FOUND - AXE MARKS.  
 SEC. 15 - DOWN; ROTTEN PINE - SCRIBE  
 ROTTEN AWAY.

PLANE COORDINATE POSITION DATA  
 State \_\_\_\_\_ Zone \_\_\_\_\_  
 X \_\_\_\_\_  
 Y \_\_\_\_\_  
 Estab. By \_\_\_\_\_  
 Agency \_\_\_\_\_

DESCRIBE CORNER LOCATION RELATIVE TO NEAR-BY FEATURES, ALSO HOW TO REACH CORNER  
 CORNER FALLS APPROX. 1100' WEST OF  
 ROAD # 3108 AND IS AT THE WEST  
 SIDE OF SMALL CLEARING.  
 A 8" PINE WITH AXE BLAZE APPROX 17' TO SOUTH.

Signature JAMES LUSHER Title CET Division LAGRANOE Headquarters \_\_\_\_\_ Date 7/22/86 FS-7100-52 (3/68)

**UNION COUNTY SURVEYOR**

---

Date Received \_\_\_\_\_  
 Date Filed 12-16-87  
 By G. LANGLITZ, DEPUTY  
 File No. 185-87R

L-17