

**BRASS CAP**

Index File No. J 13 CORNER RECORD (SEARCH) Tract or Survey No. \_\_\_\_\_ Cor. No. \_\_\_\_\_  
T 2 S R. 36 E R.D. \_\_\_\_\_ County \_\_\_\_\_  
Merid. \_\_\_\_\_ N.F. \_\_\_\_\_ State \_\_\_\_\_

CORNER DIAGRAM

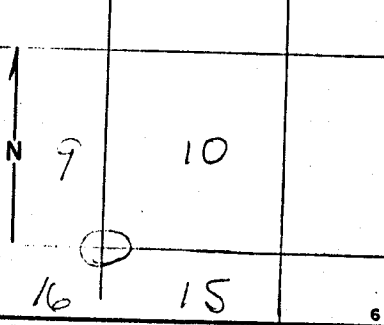

1 DESCRIBE CORNER MONUMENT FOUND  
The corner to sections 9, 10, 15 & 16 monumented with a basalt stone 17" x 10" x 6" (record 15" x 10" x 6") loosely set 3" in mound of stone marked with 3 grooves on E. face from which the remains of the original bearing trees:

2 DESCRIBE BEARING TREES OR OTHER OFFICIAL ACCESSORIES FOUND  
A pine 30" dia. bears N. 53° E. 90 lks. with scribe marks 2S 36E S10 visible on open base  
A sawed and decayed pine stump 27" dia. bears S. 32° E. 105 lks. no marking visible

6 PHOTO IDENTIFICATION DATA  
Photo No. F.U.D. 34-26  
Filed At. \_\_\_\_\_  
Object Ident. BT S. 10  
Ident. By \_\_\_\_\_  
Signature \_\_\_\_\_

3 DESCRIBE CORNER LOCATION RELATIVE TO NEAR-BY FEATURES, ALSO HOW TO REACH CORNER

7 PLANE COORDINATE POSITION DATA

State \_\_\_\_\_ Zone \_\_\_\_\_  
X \_\_\_\_\_  
Y \_\_\_\_\_  
Estab. By \_\_\_\_\_  
Agency \_\_\_\_\_

8 Signature \_\_\_\_\_ Title \_\_\_\_\_ Division \_\_\_\_\_ Headquarters \_\_\_\_\_ Date \_\_\_\_\_ 7100-52  
REV. 65 5

CORNER RECORD (PERPETUATION)

MONUMENT: DESCRIBE NEW MONUMENT SET, OR WORK DONE TO PRESERVE EXISTING MONUMENT

Set an iron post 28" long 2 1/2" dia. 16" in the ground to solid rock and in a mound of stone 4' base to top with brass cap marked

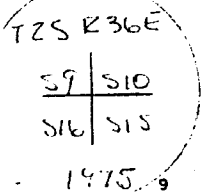

From which new bearing trees:

ACCESSORIES DESCRIBE NEW BT'S WITNESS OBJECTS ETC. ESTABLISHED, OR WORK DONE TO PRESERVE EXISTING EVIDENCE  
A pine 25" dia. bears S. 64 1/2° E. 89 lks. marked T2S R36E S15 BT  
A pine 7" dia. bears S. 60 3/4 W. 79 lks. marked T2S R36E S16 BT  
A pine 25" dia. bears N. 75 1/2 W. 150 lks. marked T2S R36E S9 BT

Deposit corner stone along side iron post

10 Work Done By Garrison Title C. Surveyor Date 7/75 State Registration No. \_\_\_\_\_ or Agency \_\_\_\_\_  
11 Certified Cor. Record Prepared? Yes \_\_\_\_\_ No \_\_\_\_\_ Filed At: \_\_\_\_\_ Date \_\_\_\_\_  
REMARKS

12 Index File No. \_\_\_\_\_ T. \_\_\_\_\_ R. \_\_\_\_\_ M. \_\_\_\_\_ Tract or Surv. No. \_\_\_\_\_ Cor. \_\_\_\_\_ 13

**UNION COUNTY SURVEYOR**  
Date Received \_\_\_\_\_  
Date Filed 12-16-87  
By G. LANGLITZ, DEPUTY  
File No. 181-87R

4-13

Remonumentation of Certain Original Corner Points,  
T. 2 S., R. 36 E., Willamette Meridian, Oregon

CHAINS

Set an iron post, 28 ins. long, 2½ ins. diam., 24 ins. in the ground, with brass cap mkd.

T 2 S R 36 E

S 16 | S 15  
1975

from which new bearing trees

A fir, 18 ins. diam., bears N. 83½° E., 11 lks. dist., mkd. ¼ S15 BT.

A fir, 15 ins. diam., bears S. 26° W., 12 lks. dist., mkd. ¼ S16 BT.

The cor. of secs. 9, 10, 15, and 16, monumented with a basalt stone, 17 x 10 x 6 ins. (record, 15 x 10 x 6 ins., unmarked), loosely set 3 ins. in a mound of stone, mkd. with 3 grooves on E. face, from which the remains of the original bearing trees:

A pine, 30 ins. diam., bears N. 53° E., 90 lks. dist., with scribe marks 2S 36E S10 visible on open blaze. (Record, N. 50° E.)

A sawed and decayed pine stump, 27 ins. diam., bears S. 32° E., 105 lks. dist., no marks visible.

At the corner point

Set an iron post, 28 ins. long, 2½ ins. diam., 16 ins. in the ground, to solid rock, and in a mound of stone, 4 ft. base, to top, with brass cap mkd.

T 2 S R 36 E

S 9 | S 10  
S 16 | S 15  
1975

from which new bearing trees

A pine, 25 ins. diam., bears S. 64½° E., 89 lks. dist., mkd. T2S R36E S15 BT.

A pine, 7 ins. diam., bears S. 60½° W., 79 lks. dist., mkd. T2S R36E S16 BT.

A pine, 25 ins. diam., bears N. 75½° W., 150 lks. dist., mkd. T2S R36E S9 BT.

Deposit corner stone alongside iron post.

The ¼ sec. cor. of secs. 9 and 10, monumented with a basalt stone, 14 x 10 x 6 ins., firmly set 6 ins. in the ground, mkd. ¼ on W. face and X on top, from which the remains of the original bearing trees:

A pine, 18 ins. diam., bears S. 18° E., 75 lks. dist., with scribe mark T visible on opened blaze.

A sawed and decayed pine stump, 24 ins. diam., bears S. 74° W., 114 lks. dist., with scribe marks BT visible on decayed blaze.

T2S36 J13

T2S36 G13

**UNION COUNTY SURVEYOR**

Date Received 3/15/13

Date Filed 3/15/13

By J. A. & L. DEPUTY

File No. 329-2013R