

CERTIFIED RECORD OF LAND CORNER MONUMENTATION

HISTORY OF ORIGINAL CORNER ESTABLISHED:

Corner not originally established

T 2 S R 36 E B-13

DESCRIPTION OF CORNER EVIDENCE FOUND:

None

See Survey No. 026-2015

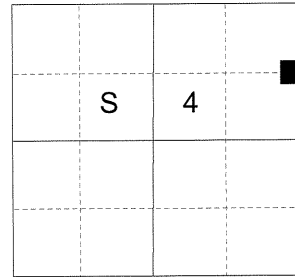

DESCRIPTION OF MONUMENT AND ACCESSORIES I ESTABLISHED TO PERPETUATE THE ORIGINAL LOCATION OF THIS CORNER:

At the position determined by survey, I set a 5/8" x 30" iron pin with a 2 1/2" aluminum marked as shown, 30" in the ground. From which:

NEW BEARING OBJECTS:

An 8" Western Larch bears South 39° East, a distance of 28.05 feet, marked N 1/16 S3 BT.
A 6" Ponderosa Pine bears South 65° West, a distance of 21.25 feet, marked N 1/16 S4 BT.

I set a steel fencepost approximately 1 foot North of corner monument.

I hereby certify that the corner was monumented on April 30, 2015.

Witness: Thomas J. Kopp

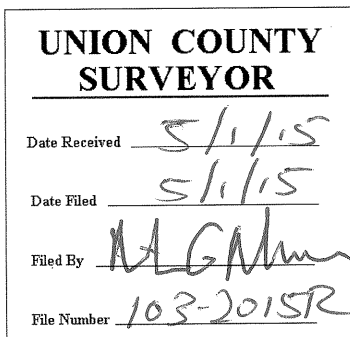
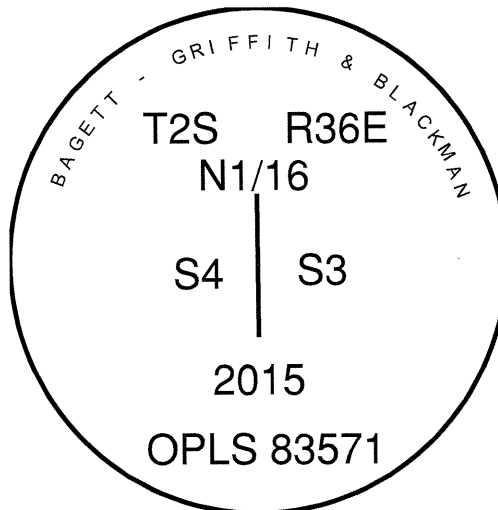
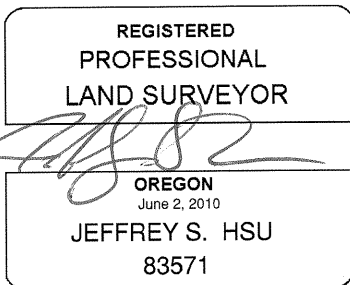

I used a steel tape and magnetic compass in the establishment of the new accessories. I used 16° East declination, the distances are to a 60d spike driven into the right side of the root crown of the bearing trees. A brass washer marked OPLS 83571 is attached to the BT blaze of the new bearing trees.