

**CERTIFIED RECORD OF LAND CORNER MONUMENTATION**

**HISTORY OF ORIGINAL CORNER ESTABLISHMENT:**

Corner originally established by John A. Hurlburt under GLO contract Number 201, dated August 5, 1873. Surveyor General record states:  
Set pine post 5ft long 5in square 2ft in ground, from which;  
A 12" Fir bears N64°W, 24 lks.  
A 8" Pine bears S17°W, 21 lks.  
A 8" Pine bears N23°E, 35 lks.  
A 10" Pine bears S65°E, 14 lks.

Survey 11-82 calls blazing and scribing a 11" Tamarack as corner.

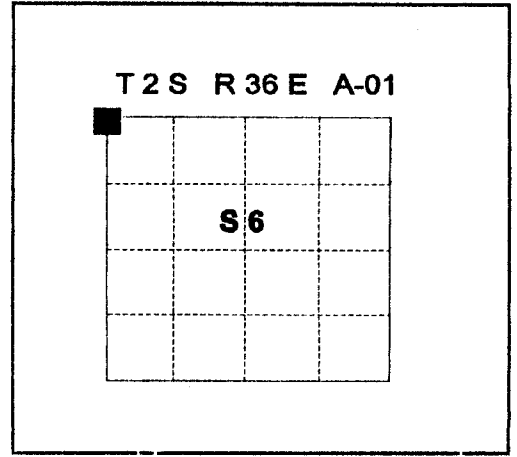

No record of subsequent monumentation found in Union County survey records

**DESCRIPTION OF CORNER EVIDENCE FOUND:**

Found 11" Tamarack blazed and scribed as per 11-82. Found 18" White Fir snag bearing S16°W, 19.65 feet blazed and scribed. Found 11" Tamarack bearing N66°W, 8.61 feet, blazed and scribed, alive and vigorous.  
**See Union County Survey Number 043-1995.**

**DESCRIPTION OF MONUMENT AND ACCESSORIES I ESTABLISHED TO PERPETUATE THE ORIGINAL LOCATION OF THIS CORNER:**

**NEW BEARING TREES:**

A 13" Tamarack bears N84°E, 33.40 feet, marked T1S R36E S31 BT.  
A 9" Lodgepole Pine bears South, 6.10 feet, marked T2S R36E S6 BT.  
A 14" Tamarack bears S74°W, 26.61 feet, marked T2S R35E S1 BT.

I hereby certify that the corner was monumented on October 9, 1995.  
Witness: Mark Durbin, Jeff Madsen

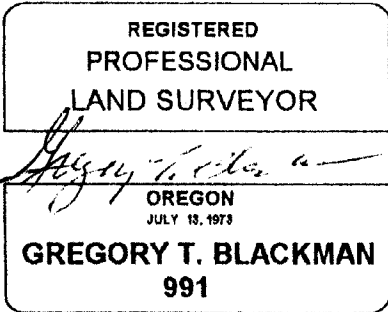

Renewal Date: December, 31 1995

**UNION COUNTY SURVEYOR**  
Date Received 11-13-95  
Date Filed 11-13-95  
Filed By P. ROBINSON, DEPUTY  
File Number 030-1995 R

I used a steel tape and magnetic compass in the establishment of the new accessories. I used 18° East declination, the distances are to a 60d spike driven into the right side of the root crown of the bearing tree.

**CERTIFIED RECORD OF LAND CORNER MONUMENTATION**

**HISTORY OF ORIGINAL CORNER ESTABLISHMENT :**

Corner originally established by John A. Hurlburt under GLO Contract No. 201, dated August 5, 1873. Surveyor General notes states:

Set pine post 5 ft. long, 5 ins. square 2 ft. in ground, from which:

- A 12 in. Fir bears N. 64° W, 24 lks. dist.
- An 8 in. Pine bears S. 17° W., 21 lks. dist.
- An 8 in. Pine bears N. 23° E., 35 lks. dist.
- A 10 in. Pine bears S. 65° E., 14 lks. dist.

Union County Survey No. 11-82, by John Hollingsworth, establishes the corner by double proportionate measurement. County Survey states:

Section corner falls in an 11" Tamarack. Put corner tag on this tree and scribed as follows:  
 On NW face "T1S R35E S36"  
 On NE face "T1S R36E S31"  
 On SE face "T2S R36E S6"  
 On SW face "T2S R35E S1"

T 1 S R 35 E Z - 25

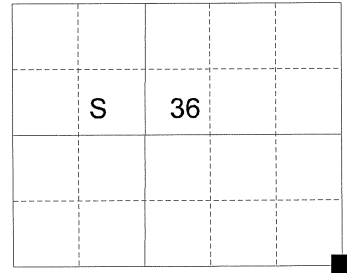

- 19" fir S17°W, 19.2' to center, scribed "T2S R35E S1 BT" - placed a yellow Parks corner tag on this BT.
- 17" fir S60°E, 25.1' to center, scribed "T2S R36E S6 BT"
- 12" tamarack N75°E, 16.9 to center, scribed "T1S R36E S31 BT RS 691"
- 11" tamarack N65°W, 8.8 to center, scribed "T1S R35E S36 BT"

In October 1995, Union County monumentation record 030-1995R, by Gregory Blackman, perpetuates the corner. Monumentation record states: Found 11" Tamarack blazed and scribed as per 11-82. Found 18" White Fir snag bearing S16°W, 19.65 blazed and scribed. Found 11" Tamarack bearing N66°W, 8.61 feet, blazed and scribed, alive and vigorous.

**New bearing trees:**

- A 13" Tamarack bears N84°E, 33.40 feet, marked T1S R36E S31 BT.
- A 9" Lodgepole Pine bears South, 6.10 feet, marked T2S R36E S6 BT.
- A 14" Tamarack bears S74°W, 26.61 feet, marked T2S R35E S1 BT.

In October 2001, Umatilla County monumentation record 01-178-R, by William R. Wells perpetuates the corner. Monumentation record states:

- Found 12" tamarack corner tree marked by State Parks, from which:
- A cut 12" tamarack stump, bears N 75° E, 25.1', partial visible scribes (State Parks BT).
- A dead, fallen 17" fir, bears S 60° E, 25.1', (State Parks BT).
- A dead 19" fir, bears S 16° W, 19.65', (State Parks BT).
- A dead 11" tamarack, bears N 66° W, 8.61', (State Parks BT).
- A 14" tamarack bears N 84° E, 33.40 feet, (Blackman BT).
- A dead 8" lodgepole pine bears South, 6.10 feet (Blackman BT).
- A dead 16" tamarack bears S 74° W, 26.61 feet (Blackman BT).

**New Accessories:**

- A 8" lodgepole pine bears S 26° E, 55.4 feet, scribed "T2S R36E S6 BT"
- A 20" western larch bears S 82° W, 50.2 feet, scribed "T2S R35E S1 BT"
- A 14" western larch bears N 39° W, 55.3 feet, scribed "T1S R35E S36 BT"

Union County Survey No. 027-2003 places the township corner position 26 feet West of the tree. No monument was set, but State Parks was contacted concerning the error. Narrative states that State Parks would reset the monument.

**DESCRIPTION OF CORNER EVIDENCE FOUND :**

From true corner position:

- A 12" Western Larch bears South 88° East, a distance of 26.90 feet, blazed and scribed on four sides as per Survey Number 11-82.
- A 14" Western Larch bears North 88° East, a distance of 59.28 feet (Blackman BT), alive and vigorous with scribes visible on partially healed blaze. (Blackman BT)
- An 8" Lodgepole Pine bears South 42° East, a distance of 70.60 feet, alive and vigorous with a healed blaze.(Wells BT)
- A 21" Western Larch bears South 76° West, a distance of 23.73 feet, alive and vigorous with a healed blaze (Wells BT)
- A 14" Western Larch bears North 10° West, a distance of 44.35 feet, alive and vigorous with scribe marks visible on partially healed blaze. (Wells BT)
- A White Fir snag bears South 50° East, a distance of 27.40 feet (State Parks BT)
- A Western Larch, dead and downed, the stump hole of which bears South 20° East, a distance of 5.70 feet (Blackman BT)

See Union County Survey Number 015-2011

**DESCRIPTION OF MONUMENT AND ACCESSORIES I ESTABLISHED TO PERPETUATE THE ORIGINAL LOCATION OF THIS CORNER :**

At the position determined by survey, I set a 2 1/2" x 30" aluminum pipe with 2 1/2" aluminum cap marked as shown below, 25" in the ground.

I set a steel fencepost 1 foot South of the corner monument.

I hereby certify that the corner was monumented on May 20, 2011.

Witness: Gregory T. Blackman Jr.



Renewal Date: June 30, 2011

**UNION COUNTY SURVEYOR**

Date Received 6/6/11

Date Filed 6/22/11

Filed By R. ROBINSON, Deputy

File Number 001-2011R

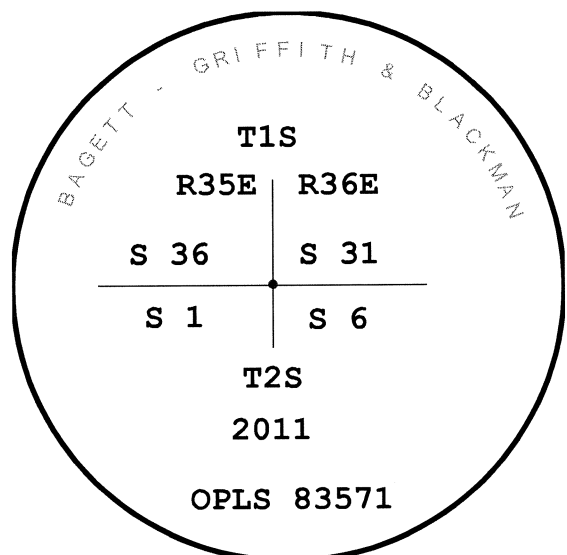

I used a magnetic compass and steel tape in the establishment of the accessories. Magnetic declination used was 16° East. The distances are to a 60d spike in the right hand side of the trees and bearings are to the center of the blaze.

# HORIZONTAL CONTROL DATA

## UNION COUNTY, OREGON

### OREGON STATE PLANE, NORTH ZONE (3601)

STA NAME: 201101

SECTION CORNER COMMON TO SECTIONS 1,6,31 AND 36

TWP. 1/2 S. RGE. 35/36 E.

GEODETIC COORD: NAD 83(91)

DATE TIED: MAY 20, 2011

LAT: 45 ° 25 ' 44.35096 " N

SURVEYOR: RICK G. ROBINSON  
OPLS 2219

LONG: 118 ° 21 ' 59.00529 " W

FIRM: BAGETT, GRIFFITH, & BLACKMAN  
2006 ADAMS AVENUE  
LAGRANDE, OR 97850  
(541) 963-6092

SP. COOR: NAD 83(91)

N: 649727.483 INT FT.

E: 8749780.219 INT FT.

TYPE: GPS

THETA: 1 ° 30 ' 47.2540419 "

ORDER: SECOND CLASS: 1

SCALE FACTOR: 0.9999048798

ELEV: 4170.89 US FT.

ELEV: DATUM: NGVD 29

**COMMENTS:**

Corner is 2 1/2" aluminum pipe with aluminum cap marked as shown

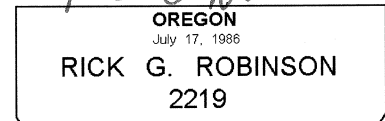
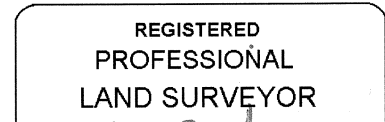
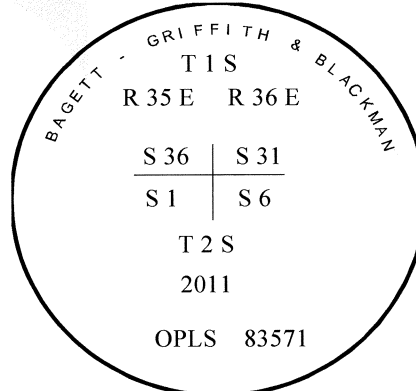

Renewal Date: December 31, 2012

1 METER = 3.2808333333... US FEET = 39.37 INCHES

1 METER = 3.280839895 INT'L FEET OR 1 INCH = 2.54 CM

TO CALCULATE ELEVATION FACTOR ( IN THE NORTH AMERICAN CONTINENT)

DIVIDE 20,906,000 BY (20,906,000 + ELLIPSOID ELEV. IN FEET)