

CERTIFIED RECORD OF LAND CORNER MONUMENTATION

HISTORY OF ORIGINAL CORNER ESTABLISHED:

Corner not previously established.

T 2 S R 35 E G-19

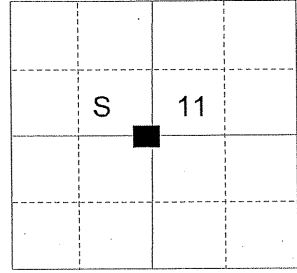

DESCRIPTION OF CORNER EVIDENCE FOUND:

None

SEE SURVEY NUMBER 016-2014

DESCRIPTION OF MONUMENT AND ACCESSORIES I ESTABLISHED TO PERPETUATE THE ORIGINAL LOCATION OF THIS CORNER:

At the position determined by survey, I set a 2 1/2" x 30" aluminum pipe with 2 1/2" aluminum cap marked as shown below, 30" in the ground, in a mound of stone, 1 ft. diam., from which:

NEW BEARING OBJECTS:

- An 8" Lodge Pole Pine bears N 34° W, a distance of 8.85 feet, marked C 1/4 S11 BT.
- An 8" Lodge Pole Pine bears N 64° E, a distance of 10.30 feet, marked C 1/4 S11 BT.
- A 10" Douglas Fir bears S 9° E, a distance of 9.95 feet, marked C 1/4 S11 BT.
- A 5" White Fir bears West, a distance of 6.10 feet, marked X BT.

Set a steel fencepost approximately 1 foot North of corner monument.

I hereby certify that the corner was monumented on May 23, 2014.

Witness: Thomas J. Kopp

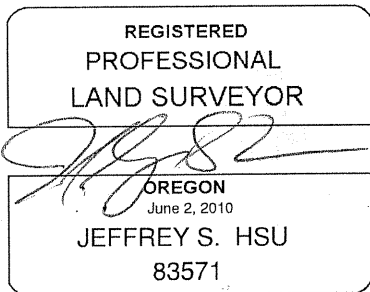

Renewal Date: June 30, 2015

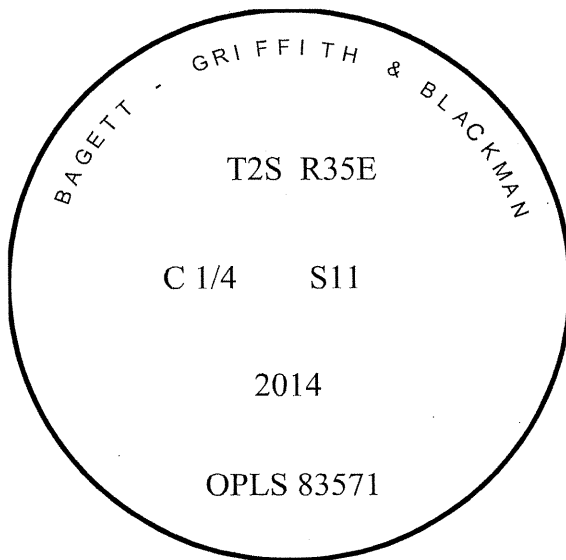

UNION COUNTY SURVEYOR

Date Received 5/29/14

Date Filed 5/29/14

Filed By [Signature]

File Number 020-2014R

I used a steel tape and magnetic compass in the establishment of the new accessories. I used 16° East declination, the distances are to a 60d spike driven into the right side of the root crown of the new bearing trees. A brass washer marked OPLS 83571 is attached to the BT blaze of the new bearing trees.