



United States Department of the Interior

BUREAU OF LAND MANAGEMENT
OREGON STATE OFFICE
P.O. BOX 2965 (825 NE MULTNOMAH STREET)
PORTLAND, OREGON 97208

TAKE
PRIDE IN
AMERICA

RECEIVED

OCT 25 1988

IN REPLY REFER TO:
9641 (942)

October 21, 1988

Mr. Howard Perry
Union County Surveyor
P.O. Box 1107
LaGrande, OR 97850

Dear Sir:

The enclosed diagram(s) indicate cadastral survey field work completed by this office from October 1987 through September 1988.

The diagram(s) are for informational purposes only. The final field notes and plat have not yet been prepared. If you need any information on any of these surveys, please feel free to contact this office at (503) 231-6987.

Sincerely,

Wayne M. Gardner
Chief, Branch of Cadastral
Survey

Enclosures (as stated)

X-11

U.S. DEPARTMENT OF THE INTERIOR
BUREAU OF LAND MANAGEMENT

TOWNSHIP DIAGRAM*

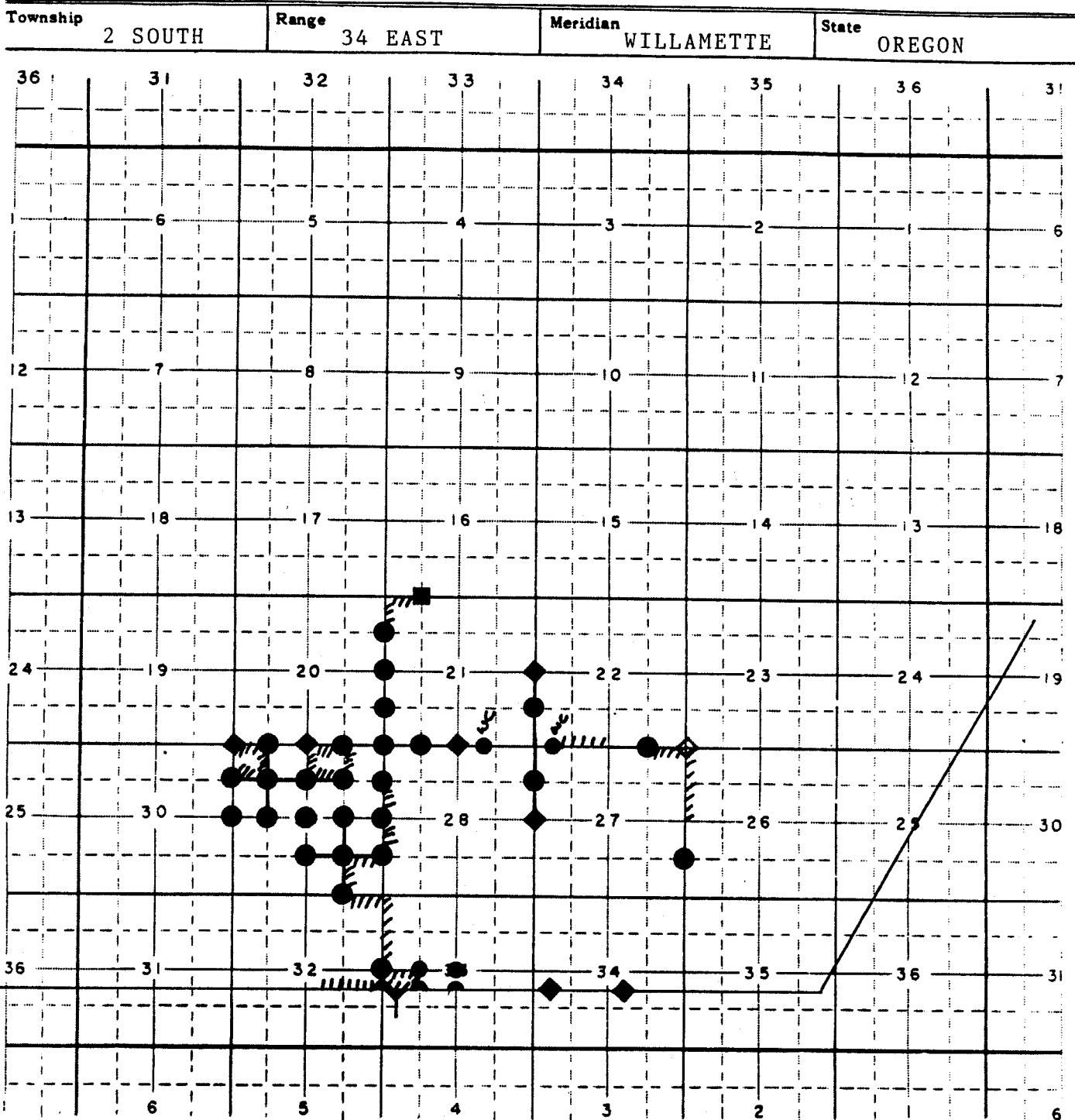

Field Work Completed During FY 1988

For the Bureau of Indian Affairs,

Umatilla Indian Reservation,
Umatilla and Union Counties, Oregon

- | | |
|--|---------------------------------|
| <u>————</u> Resurveyed or Surveyed line | 3½ Miles Resurveyed or Surveyed |
| <u>◇</u> Original Corner, previously remonumented | 42 Monuments set |
| <u>◆</u> Original Corner, remonumented this survey | |
| <u>●</u> Corner established this survey | Group 1343, Oregon |
| <u> </u> Reservation boundary posted | by Richard L. Johnson |
| Survey from 10/1/87 to 6/13/88 | |

T2534 X 11

486

Subdivision of Section 33,
T. 2 S., R. 34 E., Willamette Meridian, Oregon

CHAINS
39.720

Point for the center $\frac{1}{4}$ sec. cor. of sec. 33, at intersection with the E. and W. center line.

Set a stainless steel post, 28 ins. long, $2\frac{1}{2}$ ins. diam., 24 ins. in the ground, with brass cap mkd.

T 2 S R 34 E
C $\frac{1}{4}$ S 33
1987

T2534
X 11

from which

A fir, 6 ins. diam., bears S. 86° E., $39\frac{1}{2}$ lks. dist., mkd. C $\frac{1}{4}$ S33 BT.

A larch, 27 ins. diam., bears S. $35\frac{1}{2}^\circ$ W., 32 lks. dist., mkd. C $\frac{1}{4}$ S33 BT.

Deposit a white "DEEP-1" magnetic marker at the base and set a steel fence post alongside the stainless steel post.

The corner is located in ravine, drains N. 50 E.

Ascend N. slope, through moderate timber.

50.465

Intersect the S. bdy. of the Umatilla Indian Reservation.

Point for the closing cor. on the N. and S. center line of sec. 33, for that portion of the section north of the Reservation boundary.

Set a stainless steel post, 28 ins. long, $2\frac{1}{2}$ ins. diam., 12 ins. in the ground, in a mound of stone, 3 ft. base, to top, with brass cap mkd.

T2534
X 11 I

UNION COUNTY
SURVEYOR

Date Received 3/8/13

Date Filed 3/8/13

By [Signature]

File No. 237-2013R

S | 33
C | C
C
1987

from which

A fir, 13 ins. diam., bears N. 73° E., 38 lks. dist., mkd. S33 CC BT.

A ponderosa pine, 40 ins. diam., bears N. $22\frac{1}{2}^\circ$ W., 128 lks. dist., mkd. S33 CC BT.

Deposit a white "DEEP-1" magnetic marker at the base and set a steel fence post alongside the stainless steel post.