

CERTIFIED RECORD OF LAND CORNER MONUMENTATION

HISTORY OF ORIGINAL CORNER ESTABLISHMENT:

Corner originally established by Rufus S. Moore under GLO contract number 382, dated March 23rd, 1881. GLO record states:

T 2 N R 40 E R-09

	S	28	

Set a Basalt Stone 15x8x7 in mound of stone for Cor. To Sec. 20,21,28,& 29

Survey Number 53-77 shows this corner being found, or set. The survey does not state what was set.

No record of subsequent monumentation found in UNION COUNTY survey records.

See Union County Survey Number 023-1998

DESCRIPTION OF CORNER EVIDENCE FOUND:

Found a Railroad Spike in intersection assumed set by Survey Number 53-77. The spike is harmonious with the other monuments set by this survey.

DESCRIPTION OF MONUMENT AND ACCESSORIES I ESTABLISHED TO PERPETUATE THE ORIGINAL LOCATION OF THIS CORNER:

At found Railroad Spike in intersection of road, I set a 5/8" x 24" Copper Clad with a 2 1/2" Brass Cap in water valve box in ground, from which:

NEW BEARING OBJECTS:

A 5/8" Iron Rebar with 1 1/2" Aluminum Cap bears N 48° E, a distance of 50.90 feet, marked NE RP.

A P.K. Nail in Power Pole 3.80 feet off ground bears S 20° E, a distance of 79.43 feet, Pole # 018210000.

A 5/8" Iron Rebar with 1 1/2" Aluminum Cap bears S 51° W, a distance of 64.75 feet, marked SW RP.

A P.K. Nail in Power Pole 2.00 feet off ground bears N 40° W, a distance of 132.78 feet, Pole # 018209701.

I hereby certify that the corner was monumented on July 16, 1998.

Witnesses: Greg Blackman Sr., Greg Blackman Jr., and Norb Volny

REGISTERED
PROFESSIONAL
LAND SURVEYOR

Gregory T. Blackman

OREGON
JULY 13, 1973
GREGORY T. BLACKMAN
991

Renewal Date: December, 31 1999

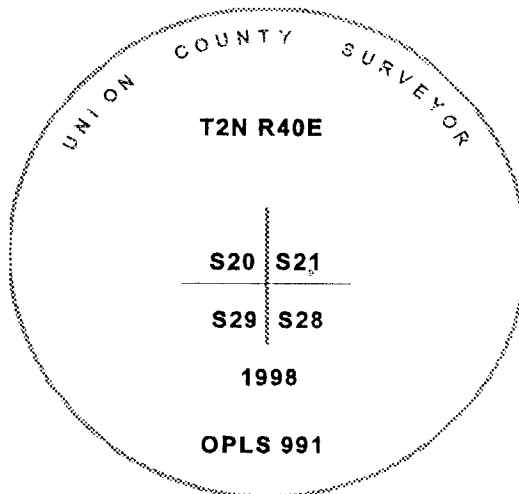

UNION COUNTY SURVEYOR

Date Received 7/17/98

Date Filed 8/29/98

Filed By R. ROBINSON, DEPUTY

File Number 030-1998R

I used a steel tape and magnetic compass in the establishment of the new accessories. I used 19° East declination, the distances are to the center of the reference object

R-09

HORIZONTAL CONTROL DATA
UNION COUNTY, OREGON
OREGON STATE PLANE, NORTH ZONE (3601)

STA NAME: 200531

SECTION CORNER COMMON TO SECTIONS: 20, 21, 28 and 29

TWP. 2 N. RGE. 40 E.

GEODETIC COORD: NAD 83(91)

DATE TIED: August 18, 2005

LAT: 45 ° 37 ' 54.64170 " N

SURVEYOR: RICK G. ROBINSON
OPLS 2219

LONG: 117 ° 49 ' 43.50733 " W

FIRM: BAGETT, GRIFFITH, & BLACKMAN
2006 ADAMS AVENUE
LAGRANDE, OR 97850
(541) 963-6092

SP. COOR: NAD 83(91)

N: 727754.728 INT FT.

E: 8885297.356 INT FT.

TYPE: GPS

THETA: 1 ° 53 ' 39.8821338 "

ORDER: SECOND CLASS: 1

SCALE FACTOR: 0.999927228

ELEV: 3360.60 US FT.

ELEV: DATUM: NGVD 29

COMMENTS:

Corner is 2 1/2" brass cap monument
marked as shown, set in a water valve box:

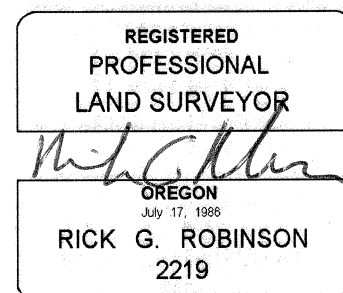
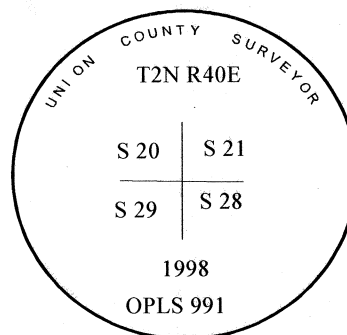

Renewal Date: December 31, 2006

1 METER = 3.280833333... US FEET = 39.37 INCHES

1 METER = 3.280839895 INT'L FEET OR 1 INCH = 2.54 CM

TO CALCULATE ELEVATION FACTOR (IN THE NORTH AMERICAN CONTINENT)

DIVIDE 20,906,000 BY (20,906,000 + ELLIPSOID ELEV. IN FEET)