

UNION COUNTY SURVEYOR

CERTIFIED RECORD OF LAND CORNER MONUMENTATION

HISTORY OF ORIGINAL CORNER ESTABLISHMENT:

Corner originally established by Rufus S. Moore under GLO contract Number 382, dated March 23, 1881. Surveyor General record states: Set basalt stone 14"x8"x5", from which: A 22" diameter Pine bears S 54° W, 211 lks.

T 2 N R 40 E N-03

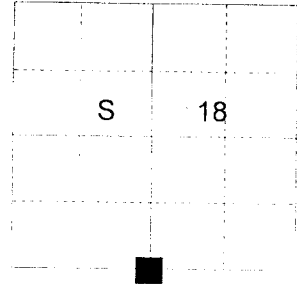

No record of further monumentation found in Union County survey records.

DESCRIPTION OF CORNER EVIDENCE FOUND:
NONE

See Survey Number 016-1998

DESCRIPTION OF MONUMENT AND ACCESSORIES I ESTABLISHED TO PERPETUATE THE ORIGINAL LOCATION OF THIS CORNER:

At surveyed proportionate position, I set a 2½"x30" aluminum pipe with aluminum cap marked as shown, 33 inches in the ground from which:

NEW BEARING OBJECTS AND TREES:

A 5/8"x30" rebar with 1½" aluminum cap marked ¼ 18 RP bears N 67° E, a distance of 29.70 feet.

A 5/8"x30" rebar with 1½" aluminum cap marked ¼ 19 RP bears S 4° E, a distance of 33.49 feet.

A power pole bears S 75° W, a distance of 131.33 feet.

A 6" diameter Ponderosa Pine bears N 8° W, a distance of 13.54 feet, marked X Bt.

I hereby certify that the corner was monumented on April 29, 1998.
Witness: Rick Robinson, Greg Blackman Jr.

REGISTERED
PROFESSIONAL
LAND SURVEYOR

Gregory T. Blackman

OREGON
JULY 13, 1873

GREGORY T. BLACKMAN
991

Renewal Date: December, 31 1999

**UNION COUNTY
SURVEYOR**

Date Received 5/13/98

Date Filed 8/29/98

Filed By R. Robinson, Deputy

File Number 045-1098R

BAGETT
GRIFFITH &
BLACKMAN

T 2 N R 40 E

S 18

1/4

S 19

1998

OPLS 991

I used a steel tape and magnetic compass in the establishment of the new accessories. I used 17° declination. BT distances are to a 60d spike driven into the right side of the root crown. A brass washer marked 991 is attached to the BT Blaze.

CERTIFIED RECORD OF LAND CORNER MONUMENTATION

HISTORY OF ORIGINAL CORNER ESTABLISHED:

Corner originally established by Rufus S. Moore under GLO contract Number 382, dated March 23, 1881. Surveyor General record states:
Set basalt stone 14"x8"x5", from which:
A 22" diameter Pine bears S 54° W, 211 lks.

T 2 N R 40 E N-03

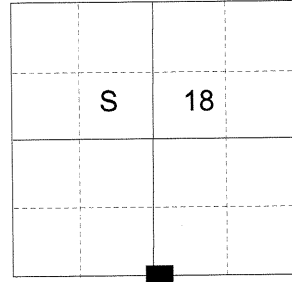

In 1998, Gregory T. Blackman brought this corner to county standard. Union County Monumentation record states:
At surveyed proportionate position, I set a 2 1/2" x 30" aluminum pipe with aluminum cap, 33 inches in the ground form which:

- A 5/8"x30" rebar with 1 1/2" aluminum cap marked 1/4 18 RP bears N 67° E, a distance of 29.70 feet.
- A 5/8"x30" rebar with 1 1/2" aluminum cap marked 1/4 19 RP bears S 4° E, a distance of 33.49 feet.
- A power pole bears S 75° W, a distance of 131.33 feet.
- A 6" diameter Ponderosa Pine bears N 8° W, a distance of 13.54 feet, marked X BT.

DESCRIPTION OF CORNER EVIDENCE FOUND:

Found a 2 1/2" aluminum pipe with aluminum cap, marked as shown below, 2" above ground in a 1 1/2" diameter collar of stone. From which:
A 5/8"x30" rebar with 1 1/2" aluminum cap marked 1/4 18 RP bears N 67° E, a distance of 29.70 feet.
A 5/8"x30" rebar with 1 1/2" aluminum cap marked 1/4 19 RP bears S 4° E, a distance of 33.49 feet.
An 18" Ponderosa Pine bears N 8° W, a distance of 13.54 feet, alive and vigorous with a healed blaze.
I find that the Southwest bearing object (power pole) taken by Mr. Blackman has been replaced and does not match bearing and distance.

DESCRIPTION OF MONUMENT AND ACCESSORIES I ESTABLISHED TO PERPETUATE THE ORIGINAL LOCATION OF THIS CORNER:

From the aluminum pipe monument:

NEW BEARING OBJECT:

A 5/8" x 30" iron pin bears South 35° West, a distance of 64.55 feet, with a 1 1/2" aluminum cap marked UNION COUNTY SURVEYOR SW RP.

I found a steel fencepost approximately 1 foot North of corner monument. Corner falls approximately 7 feet North of the centerline of Hardy Road.

I hereby certify that the corner was monumented on October 23, 2015.

Witness: Thomas J. Kopp

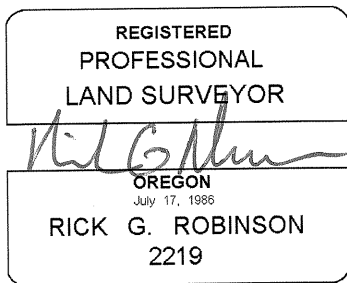

Renewal Date: December 31, 2016

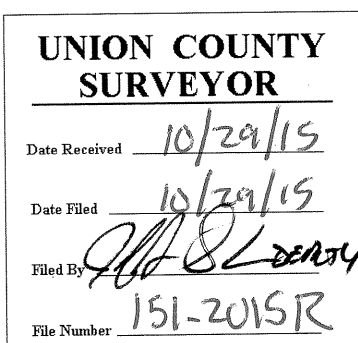
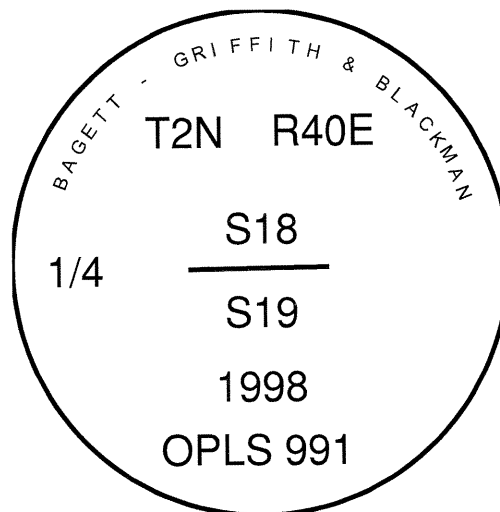

I used a steel tape and magnetic compass in the establishment of the new accessory. I used 15° East declination.

N-03

HORIZONTAL CONTROL DATA

UNION COUNTY, OREGON

OREGON STATE PLANE, NORTH ZONE (3601)

STA NAME: 201543

1/4 SECTION CORNER COMMON TO SECTIONS 18 AND 19

TWP. 2 N. RGE. 40 E.

GEODETIC COORD: NAD 83(91)

DATE TIED: October 23, 2015

LAT: 45 ° 38 ' 45.64616 " N

SURVEYOR: RICK G. ROBINSON
OPLS 2219

LONG: 117 ° 51 ' 35.34095 " W

FIRM: BAGETT, GRIFFITH, & BLACKMAN
2006 ADAMS AVENUE
LAGRANDE, OR 97850
(541) 963-6092

SP. COOR: NAD 83(91)

N: 732656.709 INT FT.

E: 8877186.265 INT FT.

TYPE: GPS

THETA: 1 ° 52 ' 20.5712938 "

ORDER: SECOND CLASS: 1

SCALE FACTOR: 0.9999292589

ELEV: 3131.15 US FT.

ELEV: DATUM: NGVD 29

COMMENTS:

2 1/2" aluminum monument with cap marked
as shown, 6" below centerline of Hardy Road

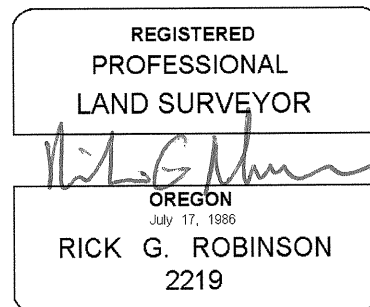
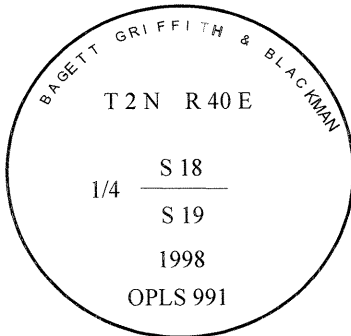

1 METER = 3.2808333333... US FEET = 39.37 INCHES

1 METER = 3.280839895 INT'L FEET OR 1 INCH = 2.54 CM

TO CALCULATE ELEVATION FACTOR (IN THE NORTH AMERICAN CONTINENT)

DIVIDE 20,906,000 BY (20,906,000 + ELLIPSOID ELEV. IN FEET)