

**UNION COUNTY
CERTIFIED RECORD OF LAND CORNER MONUMENTATION**

History of original corner establishment:

Corner was originally set by Rufus S. Moore under GLO contract no. 382, dated March 23, 1881. Surveyor General record states:

Set post for the 1/4 section corner. From which
 A pine 22 ins. dia bears North, 35 lks.
 A pine 5 ins dia bears S 8° E, 24 lks.

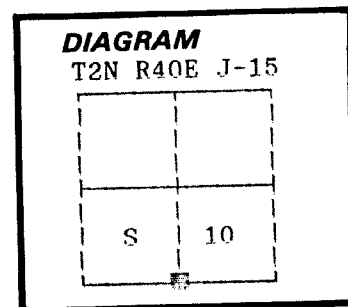

No record of subsequent monumentation found in Union County survey records.

Description of corner evidence found:

I found no evidence of the original corner.

See Map of Survey Number 015-1992.

Description of monument and accessories I established to perpetuate the original location of this corner:

At the proportionate position between the section corners East and West, I set a 2-1/2" X 30" aluminum pipe with aluminum cap 30" in the ground, marked as shown, from which:

- A 35" ponderosa pine bears N64°E, 19.31 feet set spike in right side, the tree is wrapped with wire, I did not blaze.
- A 28" ponderosa pine bears S13°E, 119.52 feet marked 1/4 S15 BT
- A 5/8" x 30" rebar bears S28°W, 35.89 feet with 2" aluminum cap marked "SW RP".
- A 23" Tamarack bears N54°W, 39.58 feet marked 1/4 S10 BT
- Steel fence post 5 ft. east.

There is a fence corner 33 feet south and 10 feet east, fences running N-S-W.

I hereby certify that the above corner point was perpetuated as hereon described on May 15, 1992.

Whitness: Pete Crabtree

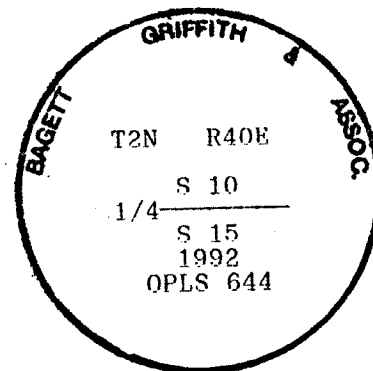

**REGISTERED
PROFESSIONAL
LAND SURVEYOR**

Duane I. Griffith

OREGON
JULY 10, 1964
DUANE I. GRIFFITH
644

I used a steel tape and magnetic compass in the establishment of new accessories. I used 20° East magnetic declination. The distances are to a 50d spike driven in the right side of the root crown. I attached a brass washer marked OPLS 644 to the BT blaze.

**UNION COUNTY
SURVEYOR**

Date Received 6/10/92
 Date Filed 6/20/92
 By *Jay Blaw*
 File No. 039-1992R

HORIZONTAL CONTROL DATA
UNION COUNTY, OREGON
OREGON STATE PLANE, NORTH ZONE (3601)

STA NAME: 2019021

1/4 SECTION CORNER COMMON TO SECTIONS 10 AND 15

TWP. 2 N RGE. 40 E.

GEODETIC COORD: NAD 83(91)

DATE TIED: September 3, 2019

LAT: 45 ° 39 ' 39.26889 " N

SURVEYOR: RICK G. ROBINSON
OPLS 2219

LONG: 117 ° 47 ' 53.09742 " W

FIRM: BAGETT, GRIFFITH, & BLACKMAN
2006 ADAMS AVENUE
LAGRANDE, OR 97850
(541) 963-6092

SP. COOR: NAD 83(91)

N: 738606.670 INT FT.

E: 8892784.116 INT FT.

TYPE: GPS

THETA: 1 ° 54 ' 58.1832942 "

ORDER: SECOND CLASS: 1

SCALE FACTOR: 0.9999314604

ELEV: 3468.98 US FT.

ELEV: DATUM: NGVD 29

COMMENTS:

2 1/2" aluminum monument with aluminum cap marked as shown

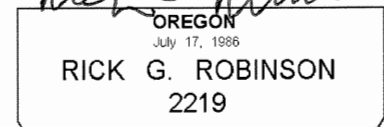
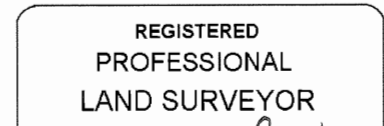
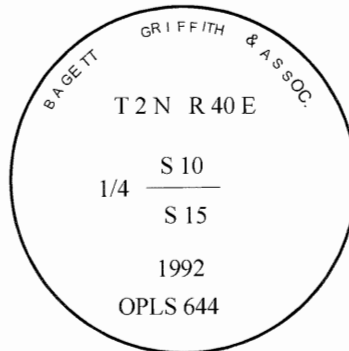

Renewal Date: December 31, 2020

1 METER = 3.280833333... US FEET = 39.37 INCHES

1 METER = 3.280839895 INT'L FEET OR 1 INCH = 2.54 CM

TO CALCULATE ELEVATION FACTOR (IN THE NORTH AMERICAN CONTINENT)

DIVIDE 20,906,000 BY (20,906,000 + ELLIPSOID ELEV. IN FEET)