

UNION COUNTY
CERTIFIED RECORD OF LAND CORNER MONUMENTATION

History of original corner establishment:
Corner was never set.

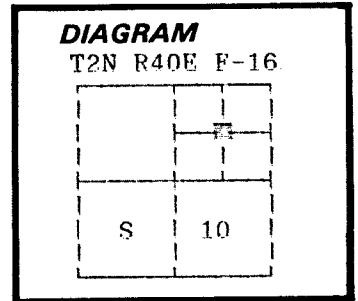

No record of subsequent monumentation found in Union County survey records.

Description of corner evidence found:

See Map of Survey Number 015-1992.

Description of monument and accessories I established to perpetuate the original location of this corner:

At position determined by survey, I set a 5/8" x 30" rebar with aluminum cap marked as shown, 26 inches in the ground stone, from which:

- A 9" Douglas Fir bears S32°E, 13.95 feet, marked X BT
- A 12" Douglas Fir bears N 5°E, 9.48 feet, marked NE 1/16 S 10 BT
- Set steel fence post 1 foot south.
- There is an E-W fence line 28 feet south.

I hereby certify that the above corner point was perpetuated as hereon described on May 15, 1992.

Whitness;
Pete Crabtree

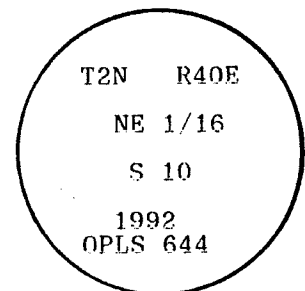

**REGISTERED
PROFESSIONAL
LAND SURVEYOR**

OREGON
JULY 10, 1964
DUANE I. GRIFFITH
644

I used a steel tape and magnetic compass in the establishment of new accessories. I used 20° East magnetic declination. The distances are to a 50d spike driven in the right side of the root crown. I attached a brass washer marked OPLS 644 to the BT blaze.

**UNION COUNTY
SURVEYOR**

Date Received 6/16/92

Date Filed 6/20/92

By Greg Black

File No. 031-1992R

CERTIFIED RECORD OF LAND CORNER MONUMENTATION

HISTORY OF ORIGINAL CORNER ESTABLISHED:

Corner previously established by Survey 015-1992 by Duane Griffith. Union County Monumentation Record states: At position determined by survey, I set a 5/8" x 30" rebar with aluminum cap marked as shown, 26" in the ground stone, from which:

A 9" Douglas Fir bears S32°E, 13.95 feet, marked X BT

A 12" Douglas Fir bears N5°E, 9.48 feet, marked NE 1/16 S 10 BT

T 2 N R 40 E F-16

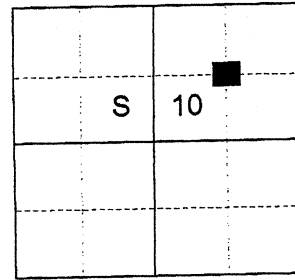

Set steel fence post 1 foot South

DESCRIPTION OF CORNER EVIDENCE FOUND:

At computed position by survey, I find no trace of the rebar or cap. From said position:

A 16" Douglas Fir bears North 5° East, a distance of 9.50 feet, with healed blaze and remnants of red paint

A 9" Douglas Fir, dead and down, the center which bears South 32° East, a distance of 14 feet, with X BT scribe visible.

A fence post with pink flagging bears Southerly approx. 28 feet, lying horizontally and utilized in a fence corner

SEE SURVEY NUMBER 016-2024

DESCRIPTION OF MONUMENT AND ACCESSORIES I ESTABLISHED TO PERPETUATE THE ORIGINAL LOCATION OF THIS CORNER:

At position determined by survey, I set a 5/8" x 30" iron pin, 27" in the ground, with a 2 1/2" aluminum cap marked as shown, and in a 1.5 ft. diam. collar of stone, from which:

NEW BEARING OBJECTS:

A 7" Douglas Fir bears South 57° East, a dist. of 15.2 feet, marked NE 1/16 S10 BT.

Set steel fence post 0.3 feet Southeasterly of monument.

Falls approx. 28 ft. North of fence corner to East/South/West running fence lines.

I hereby certify that the corner was perpetuated on April 24th 2023.

Witness: Kyle Tucker

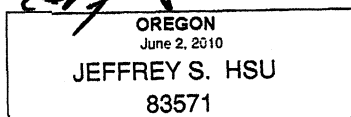
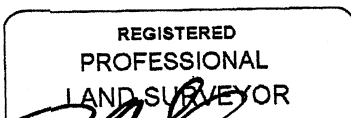
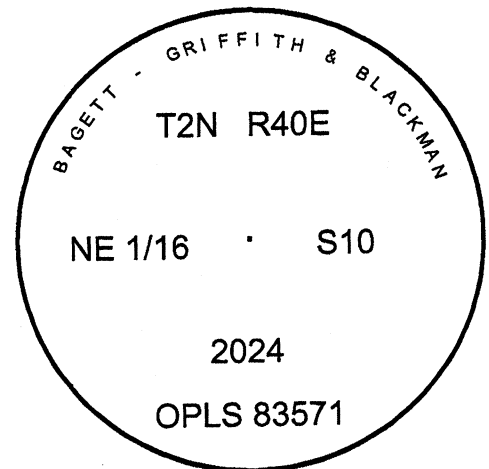

Renewal Date: June 30, 2025

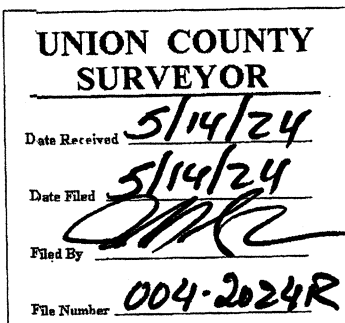

I used a steel tape and magnetic compass in the establishment of the new accessories. I used a magnetic declination of 14° East. Distances are to a 60d spike driven into the right side base of tree. Bearings are to a brass washer marked OPLS 83571 in the BT blaze of the new bearing tree.