

CERTIFIED RECORD OF LAND CORNER MONUMENTATION

HISTORY OF ORIGINAL CORNER ESTABLISHED:

Corner was originally established under GLO contract number No. 437, dated June 3, 1882, executed by Rufus Moore. Surveyor General field notes state:

Set post for cor to sec 1, 2, 35, and 36 From which:
An alder 6 in diam bears N 35° E 32 lks dist
A fir 16 in diam bears N 70° W 6 lks dist
A fir 7 in diam bears S 80° W 18 lks dist
A fir 5 in diam bears S 15° E 19 lks dist

T 3 N R 40 E Z-21

S	35

DESCRIPTION OF CORNER EVIDENCE FOUND:

None

SEE SURVEY NUMBER CS 2025-019(Wallowa Co)/SURVEY NUMBER 022-2025(Union Co)

DESCRIPTION OF MONUMENT AND ACCESSORIES I ESTABLISHED TO MONUMENT THE ORIGINAL LOCATION OF THIS CORNER:

At proportionate position, I set a 2 1/2" x 30" aluminum pipe with a 3" aluminum cap, marked as shown below, 20" in the ground, in a collar of stone 3 ft. diam., from which:

NEW BEARING OBJECTS:

A 15" Douglas Fir bears North 69° East, a distance of 79.60 feet, marked T3N R40E S36 BT.

A 5" Douglas Fir bears South 18° East, a distance of 34.18 feet, marked T2N R40E S1 BT.

A 5" Douglas Fir bears South 87° West, a distance of 11.25 feet, marked T2N R40E S2 BT.

A 12" Douglas Fir bears North 54° West, a distance of 7.70 feet, marked T3N R40E S35 BT.

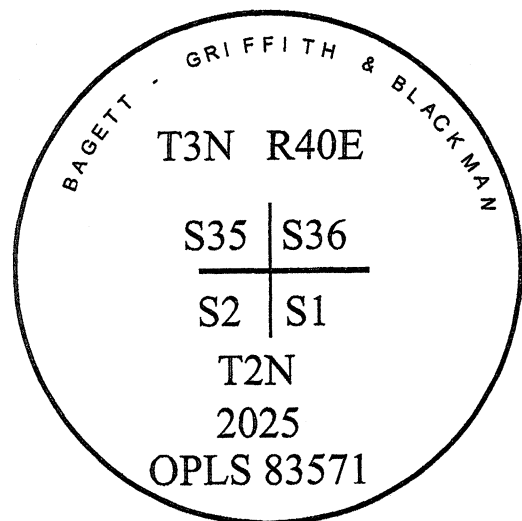

I hereby certify that the corner was monumented on June 23, 2025

Witness: Kyle Tucker, Adam Gordon



Renewal Date: June 30, 2027

I used a tape and compass in the establishment of the bearing trees. 14° East was used for declination and measured to a brass washer marked "OPLS 83571" and tacked to the opened BT blaze. Distance was to a 60-D spike in the root crown on the right side of the tree.

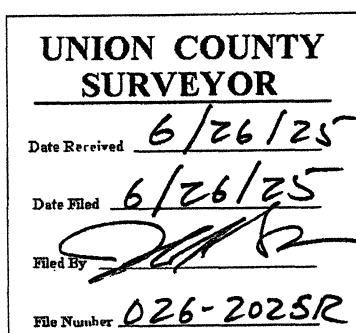

Z-21