

CERTIFIED RECORD OF LAND CORNER MONUMENTATION

HISTORY OF ORIGINAL CORNER ESTABLISHED:

Corner originally established by Rufus Moore in GLO contract no. 382, dated March 23, 1881. Surveyor General field notes state:

Set basalt stone 16x9x6 in mound of stone, for cor to Secs 26, 27, 34 and 35.

In Survey Number 18-62, Arthur Graham sets basalt stone, 36"x26"x11" set in a 3'x18" mound of stone by proportionate measurement and topographic calls. from which:

- A pine 16" bears South 37°30' East, 0.495 chs. dist.
- A pine 12" bears N16°E, 1.21 chs.
- A pine 14" bears N61°W, 0.38 chs.
- A Pine 8" bears S29°W, 0.77 chs.

Corner as per Graham found and accepted by James Hambleton in Survey Number 108-77.

T 2 N R 39 E V-17

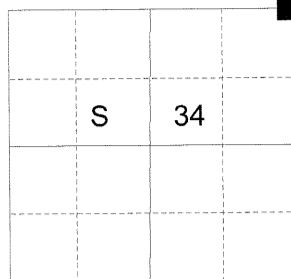

DESCRIPTION OF CORNER EVIDENCE FOUND:

Found a 30"x17"x14" stone. No marks on the stone could be found. From the center of the stone:

- A 12" Ponderosa Pine bears South 31° West, a distance of 51.65 feet, alive and vigorous with open blaze and visible scribes.
- A 23" Ponderosa Pine bears North 61° West, a distance of 26.20 feet, alive and vigorous with healed blaze.

SEE SURVEY NUMBER 025-2014

DESCRIPTION OF MONUMENT AND ACCESSORIES I ESTABLISHED

TO PERPETUATE THE ORIGINAL LOCATION OF THIS CORNER:

At the center of the stone, I set a 5/8" x 5" iron pin with 2 1/2" aluminum cap marked as shown below, drilled 3" into the stone, from which:

- An 8" Ponderosa Pine bears North 73° East, a distance of 38.95 feet, marked T2N R39E S26 BT.
- A 27" Ponderosa Pine bears South 7° East, a distance of 54.65 feet, marked T2N R39E S35 BT.

Set a steel fencepost approximately 1 ft North of corner monument.

I hereby certify that the corner was monumented on August 22, 2014.

Witness: Thomas J. Kopp

UNION COUNTY SURVEYOR

Date Received 9/9/14

Date Filed 9/9/14

Filed By [Signature]

File Number 044-2014R

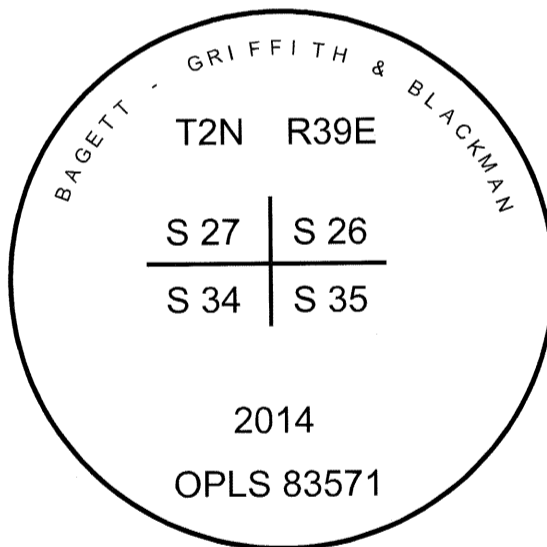

REGISTERED PROFESSIONAL LAND SURVEYOR

[Signature]

OREGON
June 2, 2010

JEFFREY S. HSU
83571

Renewal Date: June 30, 2015

I used a steel tape and magnetic compass in the establishment of the new accessories. I used 16° East declination. The distances are to a 60d spike driven into the right side of the root crown of the bearing trees. Spikes were added to the original trees. A brass washer marked OPLS 83571 is attached to the BT blaze of the new bearing trees.

HORIZONTAL CONTROL DATA
UNION COUNTY, OREGON
OREGON STATE PLANE, NORTH ZONE (3601)

STA NAME: 201420

SECTION CORNER COMMON TO SECTIONS 26, 27, 34 AND 35

TWP. 2 N. RGE. 39 E.

GEODETIC COORD: NAD 83(91)

DATE TIED: August 22, 2014

LAT: 45 ° 36 ' 59.67239 " N

SURVEYOR: RICK G. ROBINSON
OPLS 2219

LONG: 117 ° 54 ' 41.34577 " W

FIRM: BAGETT, GRIFFITH, & BLACKMAN
2006 ADAMS AVENUE
LAGRANDE, OR 97850
(541) 963-6092

SP. COOR: NAD 83(91)

N: 721501.342 INT FT.

E: 8864323.319 INT FT.

TYPE: GPS

THETA: 1 ° 50 ' 8.65927691 "

ORDER: SECOND CLASS: 1

SCALE FACTOR: 0.9999251079

ELEV: 3034.28 US FT.

ELEV: DATUM: NGVD 29

COMMENTS:

Corner monument is set in large stone
With fence post 1+/- ft. North

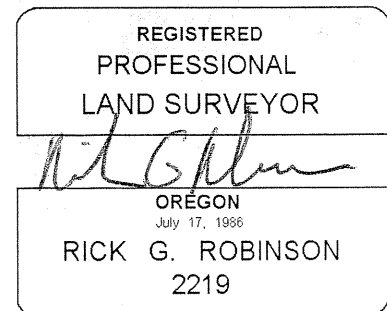
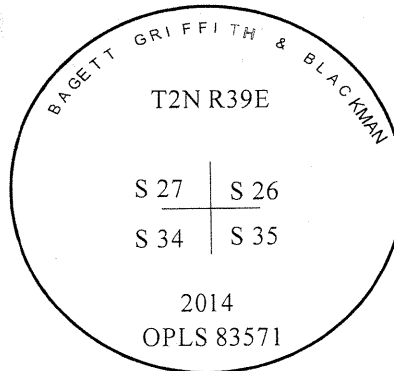

Renewal Date: December 31, 2014

1 METER = 3.280833333... US FEET = 39.37 INCHES

1 METER = 3.280839895 INT'L FEET OR 1 INCH = 2.54 CM

TO CALCULATE ELEVATION FACTOR (IN THE NORTH AMERICAN CONTINENT)

DIVIDE 20,906,000 BY (20,906,000 + ELLIPSOID ELEV. IN FEET)