

CERTIFIED RECORD OF LAND CORNER MONUMENTATION

HISTORY OF ORIGINAL CORNER ESTABLISHED:

Corner not previously established

T 2 N R 39 E R-16

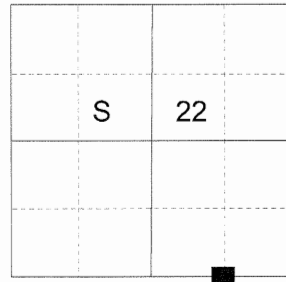

DESCRIPTION OF CORNER EVIDENCE FOUND:

None.

SEE SURVEY NUMBER 024-2016

DESCRIPTION OF MONUMENT AND ACCESSORIES I ESTABLISHED

TO PERPETUATE THE ORIGINAL LOCATION OF THIS CORNER:

At position determined by survey, I set a 5/8" x 10" iron pin, 6" in the ground, drilled into bedrock, with 2 1/2" Aluminum cap marked as shown below, in collar of stone 1 ft. diam, from which:

NEW BEARING TREES:

A 5" Douglas Fir bears North 40° East, a distance of 22.40 feet, marked E 1/16 S22 BT.
A 7" Douglas Fir bears South 85° West, a distance of 43.55 feet, marked E 1/16 S27 BT.

Corner falls North 4 ft. from the Southern post of an existing gate.
I hereby certify that the corner was monumented June 14, 2017.
Witness: Kyle Tucker

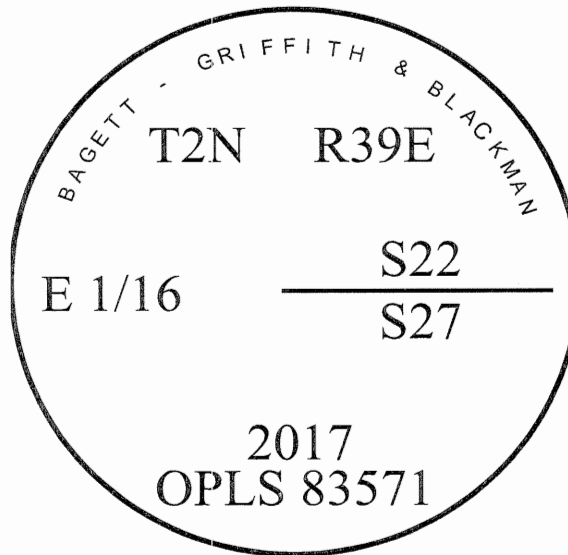
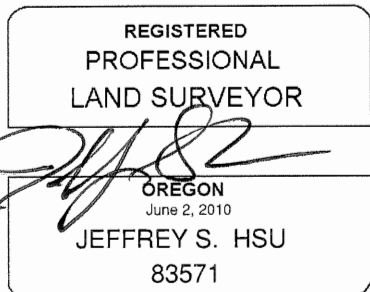

UNION COUNTY SURVEYOR

Date Received 6/22/17

Date Filed 6/22/17

Filed By [Signature]

File Number 019-2017R

I used a steel tape and magnetic compass in the establishment of the bearing trees. Magnetic declination used was 13° East. Bearings are to a brass washer marked OPLS 83571 in the lower blaze of the tree. Distance is to a spike set in the root crown of the side of the tree.