

CERTIFIED RECORD OF LAND CORNER MONUMENTATION

N-15

History of original corner establishment:

A post was set for the $\frac{1}{4}$ corner from which the following bearing trees were set:
A pine 36" dia. bears North 18 lks. scribed $\frac{1}{4}$ S BT.
A pine 10" dia. bears S 15 W, 61 lks. scribed $\frac{1}{4}$ S BT.

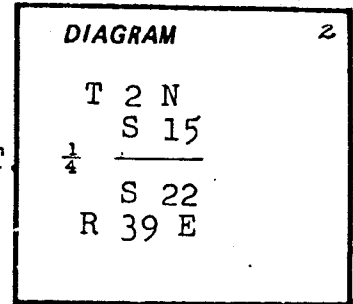

Description of corner evidence found:

No evidence was found.

Description of monument and accessories I established to perpetuate the original location of this corner:

Established the location of the $\frac{1}{4}$ corner by proportionate measurements. I set a $\frac{5}{8}$ " x 30" iron pin with a cap stamped RLS 645 in a mound of stone. I then set new bearing trees as follows:
A pine 7" dia., which bears S 00 47 W, 56.6 feet, scribed $\frac{1}{4}$ S S 22 BT.
A pine 10" dia. which bears N 17 55 E, 90.7 feet, scribed $\frac{1}{4}$ S S 15 BT.

REGISTERED
PROFESSIONAL
LAND SURVEYOR

James H. Hambleton
12-30-77

OREGON
JULY 10, 1964
JAMES H. HAMBLETON
645

Office of..... County of.....
State of..... I hereby certify that the within instrument was filed in this office
for record on the..... day of....., 19....

..... by
(COUNTY OFFICIAL) (DEPUTY)

UNION COUNTY SURVEYOR

Date Received _____

Date Filed _____
REG-798-276

By _____

File No. 275-83R

CERTIFIED RECORD OF LAND CORNER MONUMENTATION

HISTORY OF ORIGINAL CORNER ESTABLISHED:

Corner originally established by Rufus S. Moore under GLO contract Number 382, dated March 23, 1881. Surveyor General record states:
Set post for 1/4 Sec Cor, from which:
A pine 36 in diam bears North, 18 lks dist
A pine 10 in diam bears S 15° W, 61 lks dist

T 2 N R 39 E N-15

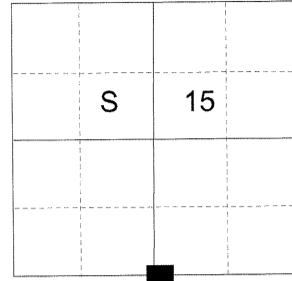

In Survey Number 108-77, James H. Hambleton finds no original evidence and resets this corner at the proportionate position. Union County Monumentation record states:

Established the location of the 1/4 corner by proportionate measurements. I set a 5/8" x 30" iron pin with a cap stamped RLS 645 in a mound of stone. I then set new bearing trees as follows:
A pine 7" dia., which bears S 00 47 W, 56.6 feet, scribed 1/4 S S 22 BT.
A pine 10" dia. which bears N 17 55 E, 90.7 feet, scribed 1/4 S S 15 BT.

DESCRIPTION OF CORNER EVIDENCE FOUND:

Found a 2 1/2" brass cap, marked as shown below, in a 1.5 foot diameter collar of stone, from which:
A 17" Ponderosa Pine bears South, a distance of 56.6 feet, alive and vigorous with a healed blaze.

SEE SURVEY NUMBER 065-2015

DESCRIPTION OF MONUMENT AND ACCESSORIES I ESTABLISHED TO PERPETUATE THE ORIGINAL LOCATION OF THIS CORNER:

From the brass cap monument

NEW BEARING TREES:

A 13" Ponderosa Pine bears North 64° East, a distance of 9.45 feet, marked 1/4 S15 BT.
A 13" Ponderosa Pine bears South 64° West, a distance of 22.70 feet, marked 1/4 S22 BT.
A 3" Ponderosa Pine bears North 10° West, a distance of 38.75 feet, marked X BT.

Set a steel fencepost approximately 1 foot North of corner monument.
I hereby certify that the corner was perpetuated on October 22, 2015.

Witness: Thomas J. Kopp



Renewal Date: June 30, 2017

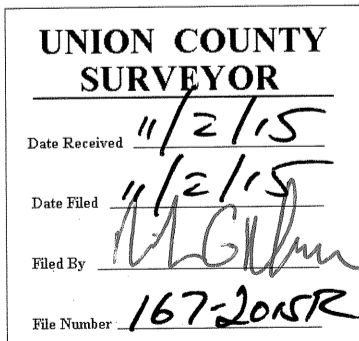
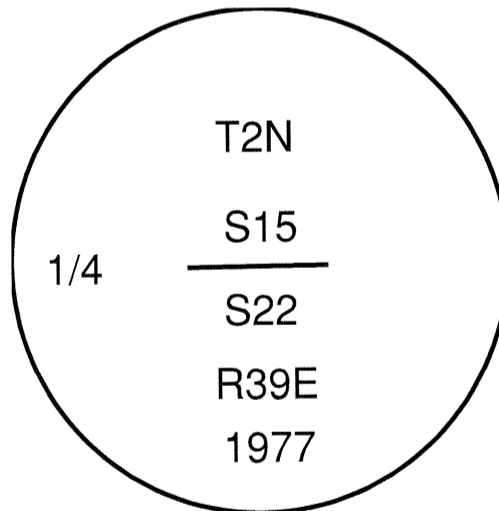

I used a steel tape and magnetic compass in the establishment of the new accessories. I used 15° East declination. The distances are to a 60d spike driven into the right side of the root crown of the bearing trees. A brass washer marked OPLS 83571 is attached to the BT blaze of the new bearing trees.