

**CERTIFIED RECORD OF LAND CORNER MONUMENTATION**

**HISTORY OF ORIGINAL CORNER ESTABLISHED:**

Corner originally established by Rufus S. Moore under GLO contract number 382 dated March 23, 1881. Surveyor General field notes state:

Set Basalt stone 18x8x6 in. in mos for cor. to sec. 11,12,13,14 from which:

A Pine 24 ins. diam. bears N 52° E 120 lks dist

T 2 N R 39 E J-21

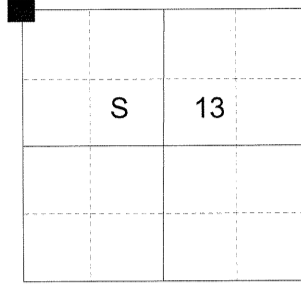

**DESCRIPTION OF CORNER EVIDENCE FOUND:**

Found a mound of stone 2 ½ ft. in diam. with remnants of an 8" wood post with red painted top. A stone of called size found adjacent to the mound. Stone has no discernible marks.

An old fence line runs East/West over the mound.

Due to the possibility of the mound being an old rock jack for the fence line I search East and West and find no other man made rock piles or rock jacks. The fence line was only anchored to trees.

See Survey 011-2019

**DESCRIPTION OF MONUMENT AND ACCESSORIES I ESTABLISHED TO PERPETUATE THE ORIGINAL LOCATION OF THIS CORNER:**

At the center of the found mound of stone I set a 2 ½" aluminum pipe, 26" in the ground, with 3" aluminum cap marked as shown below in a mound of stone 5 ft. base to top of cap from which:

**NEW BEARING OBJECTS:**

- A 10" Ponderosa Pine bears North 43° East a dist. of 52.45 ft., marked T2NR39ES12 BT.
- A 14" Ponderosa Pine bears South 73° East a dist. of 53.90 ft., marked T2NR39ES13 BT.
- A 14" Ponderosa Pine bears South 43° West a dist. of 33.85 ft., marked T2NR39ES14 BT.
- A 10" Ponderosa Pine bears North 46° West a dist. of 71.80 ft., marked T2NR39ES11 BT.

I hereby certify that the corner was monumented on May 14, 2019.  
Witness: Kyle A. Tucker

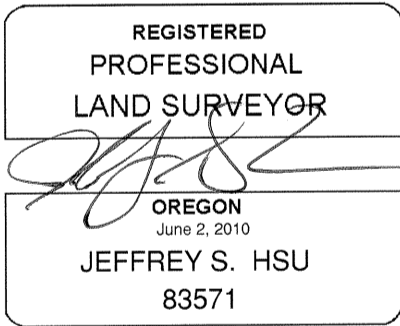

Renewal Date: June 30, 2019

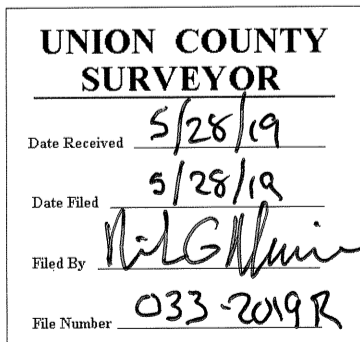
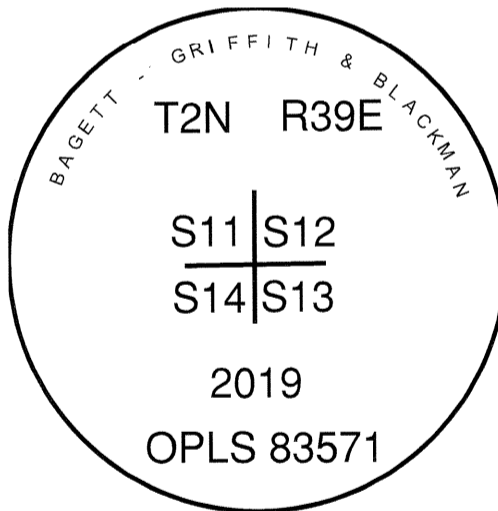

I used a steel tape and magnetic compass in the establishment of the new accessories. I used 13° East declination, the distances are to a 60d spike driven into the right side of the root crown of the bearing trees. A brass washer marked OPLS 83571 is attached to the BT blaze of the new bearing trees.

# HORIZONTAL CONTROL DATA

## UNION COUNTY, OREGON

### OREGON STATE PLANE, NORTH ZONE (3601)

STA NAME: 2020039

SECTION CORNER COMMON TO SECTIONS 11, 12, 13 AND 14

TWP. 2 N RGE. 39 E.

GEODETIC COORD: NAD 83(91)

DATE TIED: June 5, 2020

LAT: 45 ° 39 ' 37.34967 " N

SURVEYOR: JEFFREY S. HSU  
OPLS 83571

LONG: 117 ° 53 ' 26.35340 " W

FIRM: BAGETT, GRIFFITH, & BLACKMAN  
2006 ADAMS AVENUE  
LAGRANDE, OR 97850  
(541) 963-6092

SP. COOR: NAD 83(91)

N: 737634.543 INT FT.

E: 8869135.048 INT FT.

TYPE: GPS

THETA: 1 ° 51 ' 1.84281623 "

ORDER: SECOND CLASS: 1

SCALE FACTOR: 0.9999313804

ELEV: 3544.58 US FT.

ELEV: DATUM: NGVD 29

COMMENTS:

2 1/2" aluminum pipe with 2 1/2" aluminum cap  
marked as shown, set in mound of stone

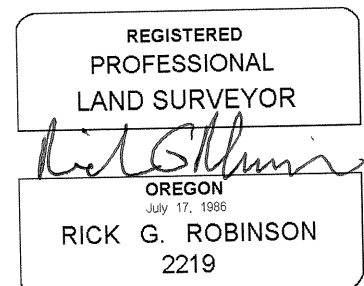
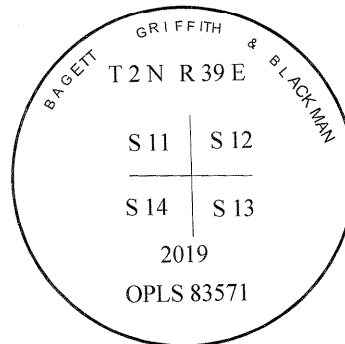

Renewal Date: December 31, 2020

1 METER = 3.2808333333... US FEET = 39.37 INCHES

1 METER = 3.280839895 INT'L FEET OR 1 INCH = 2.54 CM

TO CALCULATE ELEVATION FACTOR ( IN THE NORTH AMERICAN CONTINENT)

DIVIDE 20,906,000 BY (20,906,000 + ELLIPSOID ELEV. IN FEET)