

**UNION COUNTY SURVEYOR**  
**CERTIFIED RECORD OF LAND CORNER MONUMENTATION**

**HISTORY OF ORIGINAL CORNER ESTABLISHMENT:**

Corner originally established by Rufus S. Moore under GLO contract number 382, dated March 23rd, 1881. GLO record states:

- Set post for cor to secs 8, 9, 16, & 17 from which;
- A Fir 4 ins diam bears N75°E, 21 lks dist
- A Fir 7 ins diam bears S42°W, 6 lks dist
- A Tamarack 9 ins diam bears N75°W, 46 lks dist
- A Tamarack 26 ins diam bears S23°E, 16 lks dist

T 2 N R 39 E J-09

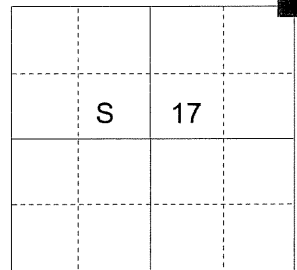

No record of subsequent monumentation found in UNION COUNTY survey records.  
 See Union County Survey 015-2005

**DESCRIPTION OF CORNER EVIDENCE FOUND:**

Found no evidence of the original corner monument or accessories. Used topography calls on the creek to the South and West to place the corner.

**DESCRIPTION OF MONUMENT AND ACCESSORIES I ESTABLISHED**

**TO PERPETUATE THE ORIGINAL LOCATION OF THIS CORNER:**

At the position determined by topography calls, I set a 2 1/2"x30" aluminum pipe with 2 1/2" aluminum cap marked as shown, 26" in the ground, from which:

**NEW BEARING TREES:**

- A 13 inch diameter Douglas Fir bears N 82°E, a distance of 34.66 feet, marked T2N R39E S9 BT
- A 6 inch diameter Ponderosa Pine bears S 12°E, a distance of 48.14 feet, marked X BT
- A 8 inch diameter Spruce bears S 23°W, a distance of 43.00 feet, marked T2N R39E S17 BT
- A 7 inch diameter White Fir bears N 27°W, a distance of 34.70 feet, marked T2N R39E S8 BT

I hereby certify that the corner was monumented on June 30, 2005.  
 Set steel fence post approximately 1 ft. North of monument.  
 Witnesses: Greg Blackman Jr., Mark Brooks and Rick Thew

REGISTERED  
PROFESSIONAL  
LAND SURVEYOR

OREGON  
July 17, 1986  
RICK G. ROBINSON  
2219

Renewal Date: December 31, 2006

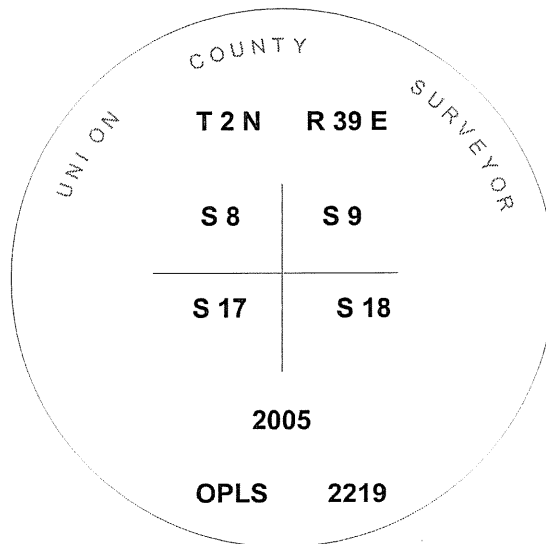

**UNION COUNTY  
SURVEYOR**

Date Received 7/1/05

Date Filed 7/1/05

Filed By Greg T. Blackman

File Number 006-2005R

I used a steel tape and magnetic compass in the establishment of the new accessories. I used 17° East declination, the distances are to a 60d spike driven into the right side of the root crown of the new bearing trees. A brass washer marked OPLS 2219 is attached to the BT blaze of the new bearing trees.

# HORIZONTAL CONTROL DATA

## UNION COUNTY, OREGON

### OREGON STATE PLANE, NORTH ZONE (3601)

STA NAME: 200512

SECTION CORNER COMMON TO SECTIONS: 8, 9, 16, and 17

TWP. 2 N. RGE. 39 E.

GEODETIC COORD: NAD 83(91)

DATE TIED: June 30, 2005

LAT: 45 ° 39 ' 37.02166 " N

SURVEYOR: RICK G. ROBINSON  
OPLS 2219

LONG: 117 ° 57 ' 9.89773 " W

FIRM: BAGETT, GRIFFITH, & BLACKMAN  
2006 ADAMS AVENUE  
LAGRANDE, OR 97850  
(541) 963-6092

SP. COOR: NAD 83(91)

N: 737094.754 INT FT.

E: 8853267.716 INT FT.

TYPE: GPS

THETA: 1 ° 48 ' 23.3155162 "

ORDER: SECOND CLASS: 1

SCALE FACTOR: 0.9999313541

ELEV: 3369.58 US FT.

ELEV: DATUM: NGVD 29

**COMMENTS:**

Corner is 2 1/2" aluminum monument  
marked as shown:

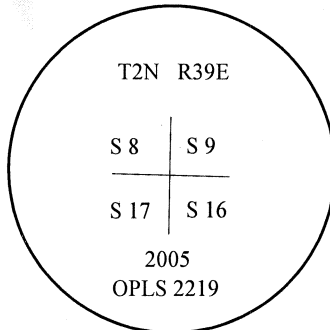

REGISTERED  
PROFESSIONAL  
LAND SURVEYOR

OREGON  
July 17, 1966  
RICK G. ROBINSON  
2219

Renewal Date: December 31, 2006

1 METER = 3.2808333333... US FEET = 39.37 INCHES

1 METER = 3.280839895 INT'L FEET OR 1 INCH = 2.54 CM

TO CALCULATE ELEVATION FACTOR ( IN THE NORTH AMERICAN CONTINENT)

DIVIDE 20,906,000 BY (20,906,000 + ELLIPSOID ELEV. IN FEET)

**UNION COUNTY SURVEYOR  
CERTIFIED RECORD OF LAND CORNER MONUMENTATION**

**HISTORY OF ORIGINAL CORNER ESTABLISHMENT:**

Corner originally established by Rufus S. Moore under GLO contract number 382, dated March 23rd, 1881. GLO record states:  
Set post for cor to secs 8, 9, 16, & 17 from which;  
A Fir 4 ins diam bears N75 E, 21 lks dist  
A Fir 7 ins diam bears S42 W, 6 lks dist  
A Tamarack 9 ins diam bears N75 W, 46 lks dist  
A Tamarack 26 ins diam bears S23 E, 16 lks dist

T 2 N R 39 E J-09

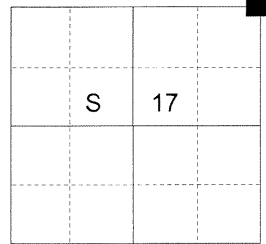

In 2005, Union County Surveyor finds no evidence of the original corner and placed the corner from topographic calls. Union County Monumentation record 006-2005R states:

Set a 2 1/2" x 30" aluminum pipe with 2 1/2" aluminum cap, 26" in the ground, from which:

- A 13 inch diameter Douglas Fir bears N 82 E, a distance of 34.66 feet, marked T2N R39E S9 BT
- A 6 inch diameter Ponderosa Pine bears S 12 E, a distance of 48.14 feet, marked X BT
- A 8 inch diameter Spruce bears S 23 W, a distance of 43.00 feet, marked T2N R39E S17 BT
- A 7 inch diameter White Fir bears N 27 W, a distance of 34.70 feet, marked T2N R39E S8 BT

**DESCRIPTION OF CORNER EVIDENCE FOUND:**

Found a 2 1/2" aluminum pipe with 2 1/2" aluminum cap marked as shown below, 6 inches above ground, from which:

A 14 inch Douglas Fir bears North 80 East, a distance of 34.95 feet, alive and vigorous with scribe marks T2N R39E S9 BT visible on a partially healed blaze

A 10 inch Spruce bears South 21 West, a distance of 42.75 feet, alive and vigorous with scribe marks visible on a partially healed blaze.

An 8 inch White Fir bears North 29 West, a distance of 34.70 feet, alive and vigorous with a healed blaze.

The Southeast ponderosa pine tree, dead and downed, with visible scribe marks, the original position of which could not be accurately ascertained.

**DESCRIPTION OF MONUMENT AND ACCESSORIES I ESTABLISHED TO PERPETUATE THE ORIGINAL LOCATION OF THIS CORNER:**

From the aluminum pipe monument,

**NEW BEARING TREES:**

A 12 inch White fir bears South 80° East, a distance of 43.05 feet, marked T2N R39E S16 BT.

I hereby certify that the corner was perpetuated on April 30, 2010.

Witnesses: Jeff Hsu

REGISTERED  
PROFESSIONAL  
LAND SURVEYOR

*Rick G. Robinson*  
OREGON  
July 17, 1986  
RICK G. ROBINSON  
2219

Renewal Date: December 31, 2012

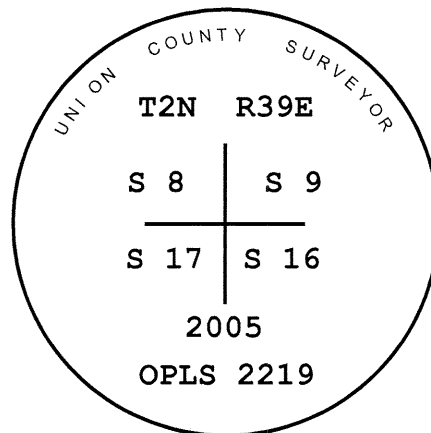

**UNION COUNTY SURVEYOR**

Date Received 5/4/2012

Date Filed 5/8/12

Filed By Jeffrey T. Blawie

File Number 0022-2012R

I used a steel tape and magnetic compass in the establishment of the accessories. I used 16 East declination, the distances are to a 60d spike driven into the right side of the root crown of the bearing trees. A brass washer marked OPLS 2219 is attached to the BT blaze of the new bearing tree.