

**UNION COUNTY SURVEYOR**  
**CERTIFIED RECORD OF LAND CORNER MONUMENTATION**

**HISTORY OF ORIGINAL CORNER ESTABLISHMENT:**

Corner not previously established.

No record of monumentation found in UNION COUNTY survey records.

**DESCRIPTION OF CORNER EVIDENCE FOUND:**

Corner not previously established.

See Survey Number 015-2005.

T 2 N R 39 E H-08

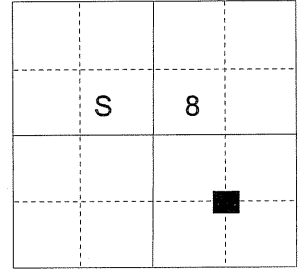

**DESCRIPTION OF MONUMENT AND ACCESSORIES I ESTABLISHED TO PERPETUATE THE ORIGINAL LOCATION OF THIS CORNER:**

At the position determined by said survey, I set a 5/8" x 30" iron pin with 1 1/2" aluminum cap marked as shown below, 27" in the ground, from which:

**NEW BEARING TREES:**

A 10 inch diameter Tamarack bears S 22°E, a distance of 27.30 feet, marked SE1/16 S8 BT.

A 14 inch diameter Douglas Fir bears S 59°W, a distance of 13.95 feet, marked SE1/16 S8 BT.

Set steel fence post approximately 1 ft North of monument.

I hereby certify that the corner was monumented on July 7, 2005.

Witness: Greg Blackman Jr., Mark Brooks and Rick Thew

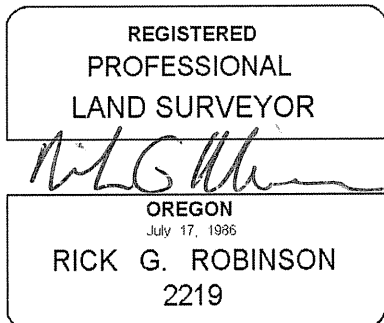

Renewal Date: December 31, 2006

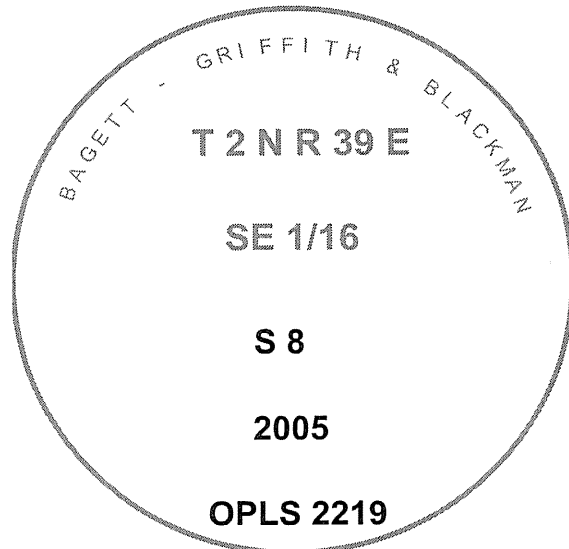

<b>UNION COUNTY SURVEYOR</b>	
Date Received	<u>7/28/05</u>
Date Filed	<u>8/19/05</u>
Filed By	<u>[Signature]</u>
File Number	<u>011-2005R</u>

I used a steel tape and magnetic compass in the establishment of new accessories. The magnetic declination used was 17° East. The distance to the bearing trees is to a 50d spike driven on the right side of the tree at the root crown. I attached a brass washer marked OPLS 2219 to the BT blaze.