

CERTIFIED RECORD OF LAND CORNER MONUMENTATION

**HISTORY OF ORIGINAL CORNER ESTABLISHED:**

Not previously established.

T 2 N R 39 E C-22

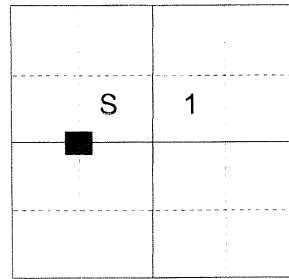

**DESCRIPTION OF CORNER EVIDENCE FOUND:**

None.

See Survey 013-2020

**DESCRIPTION OF MONUMENT AND ACCESSORIES I ESTABLISHED TO MONUMENT THE ORIGINAL LOCATION OF THIS CORNER:**

At the position determined by survey I set a 5/8" x 30" iron pin, 28" in the ground, with 2 1/2" aluminum cap marked as shown below, in a 1.5 ft. diam. mound of stone, from which:

**NEW BEARING OBJECTS:**

An 11" Ponderosa Pine bears North a dist. of 28.60 ft., marked CW 1/16 S1 BT.  
An 11" Douglas Fir bears North 86° East a dist. of 37.25 ft., marked CW 1/16 S1 BT.

Set steel fence post approx. 1 ft. West.

I hereby certify that the corner was monumented on April 14, 2020.  
Witness: Kyle A. Tucker



Renewal Date: June 30, 2021

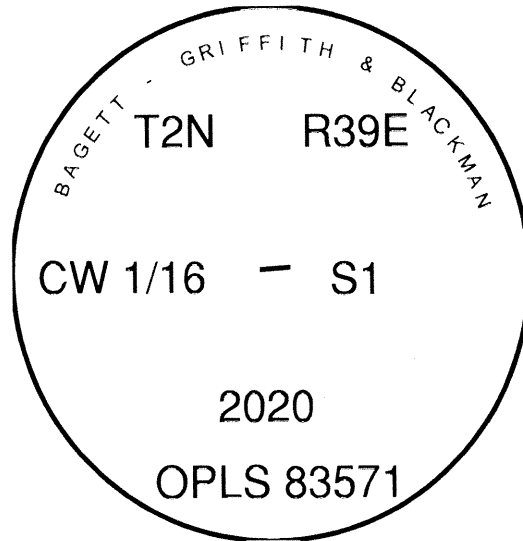
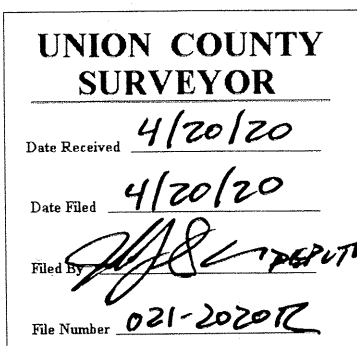

I used a steel tape and magnetic compass in the establishment of the new accessories. I used 14° East declination, the distances are to a 60d spike driven into the right side of the root crown of the bearing trees. A brass washer marked OPLS 83571 is attached to the BT blaze of the new bearing trees.