

**CERTIFIED RECORD OF LAND CORNER MONUMENTATION**

**HISTORY OF ORIGINAL CORNER ESTABLISHED:**

Corner not previously established

T 2 N R 39 E B-19

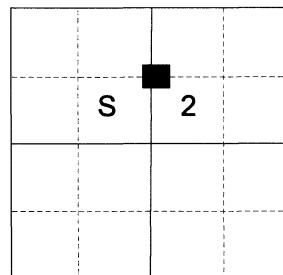

**DESCRIPTION OF CORNER EVIDENCE FOUND:**

None.

See Survey Number: 022-2022

**DESCRIPTION OF MONUMENT AND ACCESSORIES I ESTABLISHED TO MONUMENT THE ORIGINAL LOCATION OF THIS CORNER:**

At position determined by survey, I set a 5/8" by 30" iron pin, 28" in the ground, with 2 1/2" aluminum cap, marked as shown below and in a 2 ft. diam. collar of stone, from which:

**NEW BEARING OBJECT:**

A 12" Douglas Fir bears South 70° East, a dist. of 57.50 feet scribed CN1/16 S2 BT  
A 4" White Fir bears South 27° West, a dist. of 52.85 feet scribed CN1/16 S2 BT

Set steel fence post approx. 1 ft. South

Monument falls approx. 15 feet Southeasterly of fence corner, from which fences bear West and South.

I hereby certify that the corner was monumented on July 6, 2022.

Witness: Kyle Tucker and Dan Drum



Renewal Date: June 30, 2023

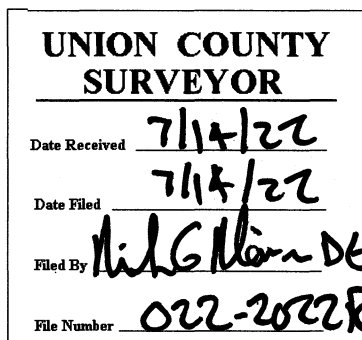
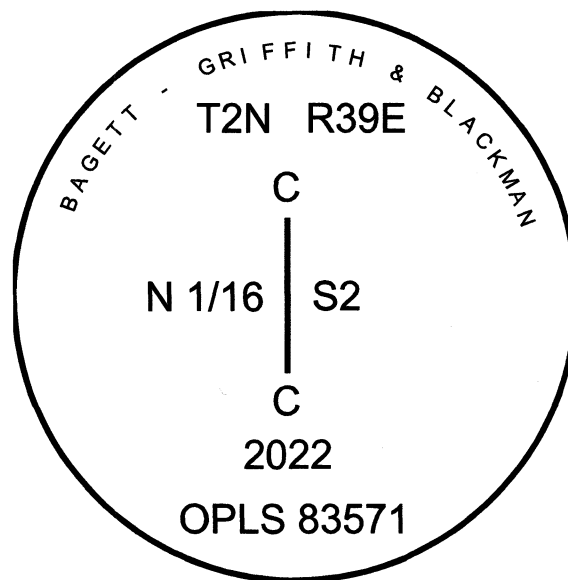

I used a steel tape and magnetic compass in the establishment of the new accessories. I used 14° East declination, the distances are to a 60d spike driven into the right side of the root crown of the bearing trees. A brass washer marked OPLS 83571 is attached to the BT blaze of the new bearing trees.