

CERTIFIED RECORD OF LAND CORNER MONUMENTATION

**HISTORY OF ORIGINAL CORNER ESTABLISHED:**

None established

T 3 N R 39 E Z-16

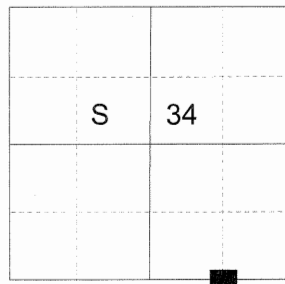

**DESCRIPTION OF CORNER EVIDENCE FOUND:**

None

SEE SURVEY NUMBER 050-2017

**DESCRIPTION OF MONUMENT AND ACCESSORIES I ESTABLISHED**

**TO PERPETUATE THE ORIGINAL LOCATION OF THIS CORNER:**

At position by survey I set a 5/8" x 30" iron pin, 29" in the ground, with 2 1/2" aluminum cap marked as shown with 2' diam. collar of stone, from which:

A 9" Ponderosa Pine bears North 60° West, a distance of 37.60 feet, marked E 1/16 S34 BT.  
A 10" Douglas Fir bears South 26° West, a distance of 42.20 feet, marked E 1/16 S3 BT.

Monument falls on East edge of Darr Rd.

North/South fence line bears East approx. 25 ft.

I hereby certify that the corner was perpetuated December 20, 2017.

Witness: Kyle Tucker

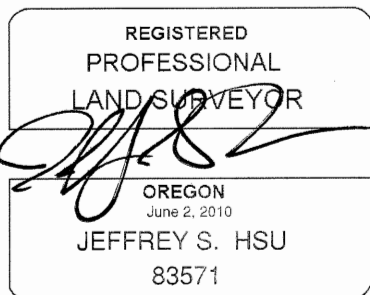

Renewal Date: June 30, 2019

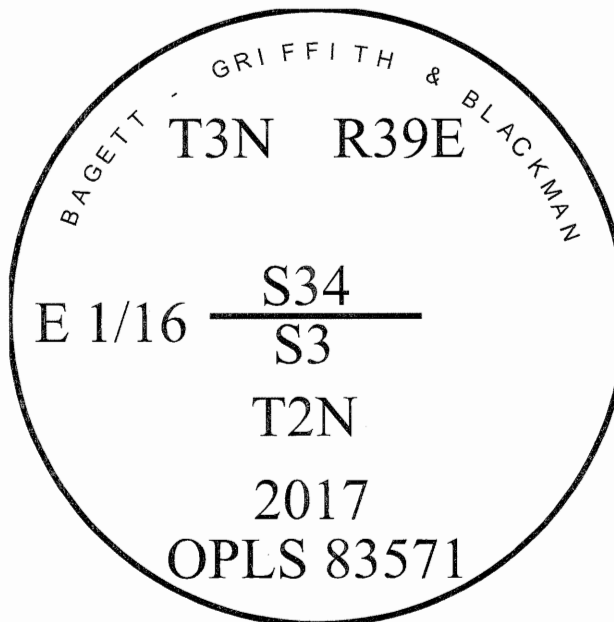

**UNION COUNTY SURVEYOR**

Date Received 12/21/17

Date Filed 12/21/17

Filed By [Signature]

File Number 060-2017R

I used a steel tape and magnetic compass in the establishment of the bearing trees. Magnetic declination used was 13° East. Bearing is to a brass washer marked OPLS 83571 in the lower blaze of the tree. Distance is to a spike set in the root crown of the side of the tree.