

CERTIFIED RECORD OF LAND CORNER MONUMENTATION

HISTORY OF ORIGINAL CORNER ESTABLISHED:

Corner originally established by Rufus S. Moore under GLO Contract No. 382, dated March 23, 1881. Survey General States:

Set post for Cor to Secs 3 & 4. From which:

- A Tamarac 26 in diam bears N45°E 57 lks dist.
- A Tamarac 22 in diam bears S27°E 67 lks dist.
- A Pine 44 in diam bears N48°W 42 lks dist.
- A Pine 22 in diam bears S43°W 80 lks dist.

T 3 N R 39 E Z-13

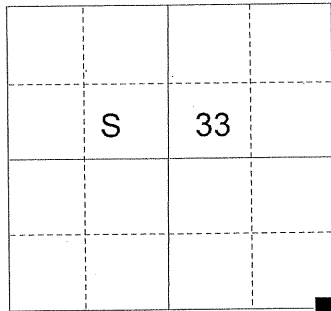

DESCRIPTION OF CORNER EVIDENCE FOUND:

None

See Survey No. 035-2014

DESCRIPTION OF MONUMENT AND ACCESSORIES I ESTABLISHED TO PERPETUATE THE ORIGINAL LOCATION OF THIS CORNER:

At the proportionate position I set a 2 1/2" x 30" aluminum pipe with a 2 1/2" aluminum cap marked as shown below 30" in the ground with a collar of stone 1 foot diameter. From which:

NEW BEARING OBJECTS:

- A 7 inch Douglas Fir bears N 87° W, a distance of 32.35 feet, marked X BT.
- A 5 inch White Fir bears S 26° E, a distance of 59.10 feet, marked T2N R39E S3 BT.
- A 10 inch Ponderosa Pine bears S 60° W, a distance of 30.20 feet, marked T2N R39E S4 BT.
- A 10 inch Douglas Fir bears N 11° W, a distance of 119.55 feet, marked T3N R39E S33 BT.

I set a steel fencepost approximately 1 foot North of the corner monument.

I hereby certify that this corner was monumented on November 17, 2014.

Witness: Thomas J. Kopp

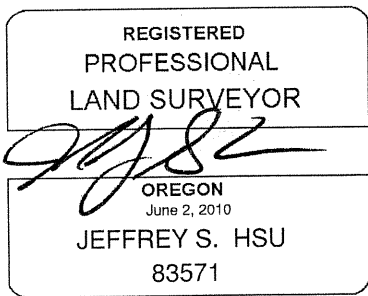

Renewal Date: June 30, 2015

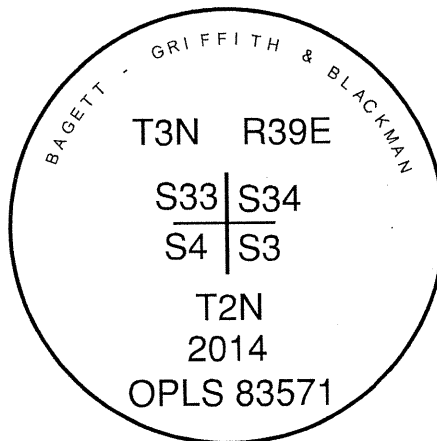

UNION COUNTY SURVEYOR

Date Received 11/17/14

Date Filed 11/17/14

Filed By MLG

File Number 073-2014R

I used a steel tape and magnetic compass in the establishment of the new accessories. I used 16° East declination, the distances are to a 60d spike driven into the right side of the root crown of the new bearing trees. A brass washer marked OPLS 83571 is attached to the BT blaze of the new bearing trees.

HORIZONTAL CONTROL DATA
UNION COUNTY, OREGON
OREGON STATE PLANE, NORTH ZONE (3601)

STA NAME: 2018005

SECTION CORNER COMMON TO SECTIONS 3, 4, 33 AND 34

TWP. 3 & 4N RGE. 39 E.

GEODETIC COORD: NAD 83(91)

DATE TIED: January 25, 2018

LAT: 45 ° 41 ' 22.08463 " N

SURVEYOR: RICK G. ROBINSON
OPLS 2219

LONG: 117 ° 55 ' 55.96027 " W

FIRM: BAGETT, GRIFFITH, & BLACKMAN
2006 ADAMS AVENUE
LAGRANDE, OR 97850
(541) 963-6092

SP. COOR: NAD 83(91)

N: 747896.846 INT FT.

E: 8858178.090 INT FT.

TYPE: GPS

THETA: 1 ° 49 ' 15.7437137 "

ORDER: SECOND CLASS: 1

SCALE FACTOR: 0.9999358716

ELEV: 3105.01 US FT.

ELEV: DATUM: NGVD 29

COMMENTS:

2 1/2" aluminum pipe with 2 1/2" aluminum cap marked as shown, set in mound of stone.

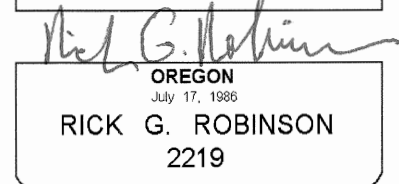
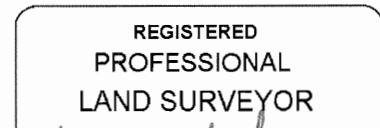
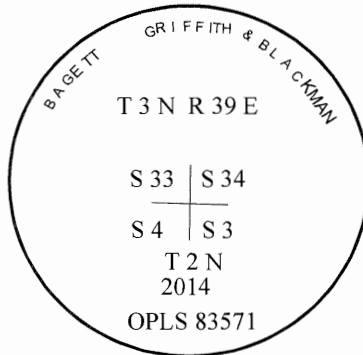

Renewal Date: December 31, 2018

1 METER = 3.2808333333... US FEET = 39.37 INCHES

1 METER = 3.280839895 INT'L FEET OR 1 INCH = 2.54 CM

TO CALCULATE ELEVATION FACTOR (IN THE NORTH AMERICAN CONTINENT)

DIVIDE 20,906,000 BY (20,906,000 + ELLIPSOID ELEV. IN FEET)