

CERTIFIED RECORD OF LAND CORNER MONUMENTATION

A-1

History of original corner establishment: Corner established in March 1884 by F. W. Campbell, under government contract number 498.

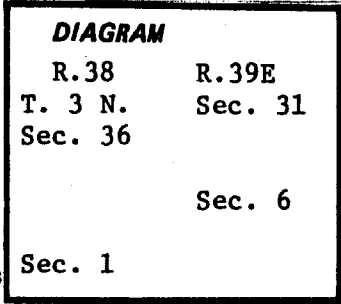

Surveyor General Record States:

Set a post 4" square marked with 6 notches from which a fir 14" diameter bears N 38° E. 25 chains distance, a fir 4" diameter bears N 47° W. 18 chains distance, a fir 9" diameter bears S. 62° West 36 chains distance, a fir 9" bears S. 38° E., 23 chains distance.

Description of corner evidence found:

- Found a 9" white fir. B.T. with legible scribing bears N. 47° W. 11.9'
- Found a 19" white fir. B. T. with liegible scribing bears N. 38° E. 16.5'
- Found a 10" white fir snag. B. T. with legible scribing bears S. 38° E. 15.2'
- Found a 3" x 3" X18" post with visible scribing lying on ground.

Description of monument and accessories | established to perpetuate the original location of this corner:

Using Original B. T. bearings and distances and near old 3"x 3" scribed post, I set a 2-1/2" x 30" iron pipe with attached brass cup stamped as hown below. Measurements were to the center of trees with a steel tape and compass with 20° east declination.

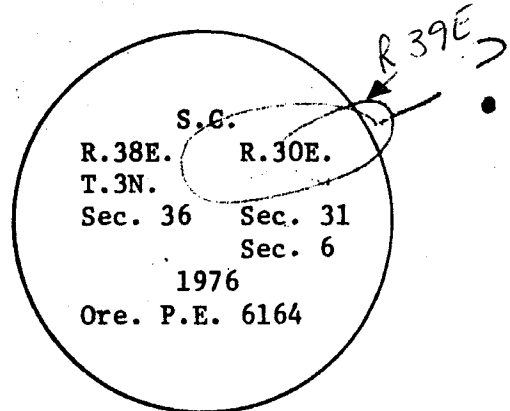
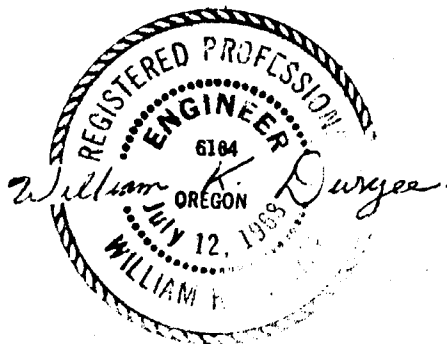

Office of..... County of.....  
 State of....., I hereby certify that the within instrument was filed in this office  
 for record on the..... day of....., 19.....  
 ..... by .....  
 (COUNTY OFFICIAL) (DEPUTY)

<b>UNION COUNTY SURVEYOR</b>	
Date Received	_____
Date Filed	_____
By	_____
File No.	<u>176-83R</u>

**CERTIFIED RECORD OF LAND CORNER MONUMENTATION**

**HISTORY OF ORIGINAL CORNER ESTABLISHED:**

Corner originally established by Rufus S. Moore under GLO contract number 382 dated March 23, 1881. Surveyor General field notes state:

Set post for cor. to Townships 2 and 3 North, Ranges 38 and 39 East from which:

- A Fir 14 ins diam bears N 38° E 25 lks dist
- A Fir 4 ins diam bears N 47° W 18 lks dist
- A Fir 9 ins diam bears S 62° W 36 lks dist
- A Fir 9 ins diam bears S 38° E 23 lks dist

T 2 N R 39 E A-01

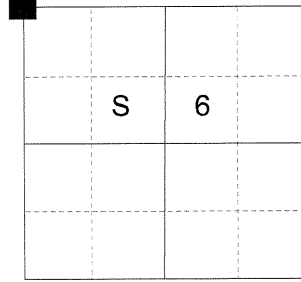

Corner monumented by William Durgie in 1976. Union County Monumentation record 176-83R states:

- Found a 9" white fir. B.T. with legible scribing bears N. 47°W. 11.9'
- Found a 19" white fir. B.T. with legible scribing bears N. 38° E. 16.5'
- Found a 10" white fir snag. B. T. with legible scribing bears S. 38° E. 15.2'
- Found a 3" x 3" X 18" post with visible scribing lying on ground

Using Original B.T. bearings and distances and near old 3" x 3" scribed post, he set a 2 1/2" x 30" iron pipe with attached brass cap stamped as shown.

**DESCRIPTION OF CORNER EVIDENCE FOUND:**

Found a 2 1/2" galvanized iron pipe, with 2 1/2" brass cap, 2" above ground in 2 ft. diam. collar of stone, marked as shown, from which:

- A 10' tall stob bears North 38° East a dist. of 16.50 ft., dead and standing with scribes visible on opened blaze.
- A 16" White Fir bears South 59° East a dist. of 51.90 ft., alive and vigorous with healed blaze.
- Dead and down log, mostly rotten, bears South 38° West a dist. of approx. 16 ft..
- A 12" White Fir bears North 47° West, a dist. of 12.70., alive and vigorous with opened blaze.

Fence posts bears approx. 5 ft. East and 5 ft. South.

**DESCRIPTION OF MONUMENT AND ACCESSORIES I ESTABLISHED TO PERPETUATE THE ORIGINAL LOCATION OF THIS CORNER:**

From the iron pipe monument:

**NEW BEARING OBJECTS:**

- An 18" White Fir bears North 89° East a dist. of 34.35 ft., marked T3NR39ES31 BT.
- A 15" White Fir bears South 65° West a dist. of 32.25 ft., marked T3NR38ES36 BT.

I hereby certify that the corner was perpetuated on October 22, 2018.  
Witness: Kyle A. Tucker

REGISTERED  
PROFESSIONAL  
LAND SURVEYOR

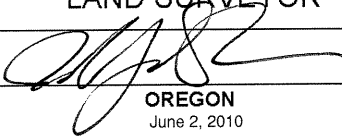

OREGON  
June 2, 2010  
JEFFREY S. HSU  
83571

Renewal Date: June 30, 2019

UNION COUNTY  
SURVEYOR

Date Received 11/28/18  
Date Filed 11/28/18  
Filed By ALG  
File Number 061-2018R

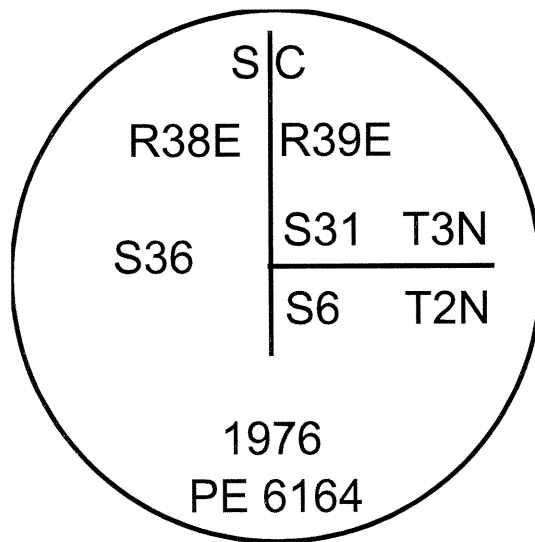

I used a steel tape and magnetic compass in the establishment of the new accessories. I used 13° East declination, the distances are to a 60d spike driven into the right side of the root crown of the bearing trees. A brass washer marked OPLS 83571 is attached to the BT blaze of the new bearing trees.

**HORIZONTAL CONTROL DATA**  
**UNION COUNTY, OREGON**  
**OREGON STATE PLANE, NORTH ZONE (3601)**

STA NAME: 2018037

SECTION CORNER COMMON TO SECTIONS 31 AND 6

TWP. 2 & 3N RGE. 39 E.

GEODETIC COORD: NAD 83(91)

DATE TIED: October 22, 2018

LAT: 45 ° 41 ' 21.33124 " N

SURVEYOR: RICK G. ROBINSON  
OPLS 2219

LONG: 117 ° 59 ' 39.33568 " W

FIRM: BAGETT, GRIFFITH, & BLACKMAN  
2006 ADAMS AVENUE  
LAGRANDE, OR 97850  
(541) 963-6092

SP. COOR: NAD 83(91)

N: 747322.782 INT FT.

E: 8842331.953 INT FT.

TYPE: GPS

THETA: 1 ° 46 ' 37.3289983 "

ORDER: SECOND CLASS: 1

SCALE FACTOR: 0.9999358384

ELEV: 4990.41 US FT.

ELEV: DATUM: NGVD 29

COMMENTS:

2 ½" iron pipe with brass cap  
marked as shown

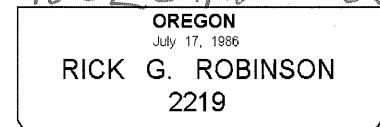
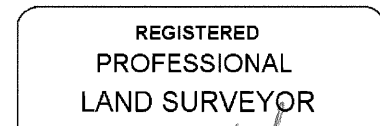
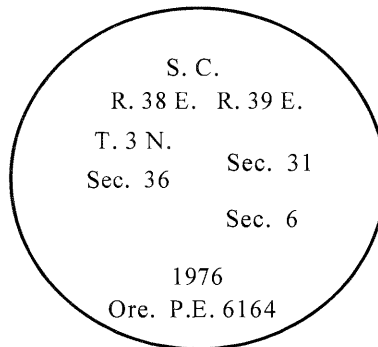

Renewal Date: December 31, 2018

1 METER = 3.2808333333... US FEET = 39.37 INCHES

1 METER = 3.280839895 INT'L FEET OR 1 INCH = 2.54 CM

TO CALCULATE ELEVATION FACTOR ( IN THE NORTH AMERICAN CONTINENT)

DIVIDE 20,906,000 BY (20,906,000 + ELLIPSOID ELEV. IN FEET)