

CERTIFIED RECORD OF LAND CORNER MONUMENTATION

History of original corner establishment:

Corner established in 1883 by Frank W. Campbell under Contract No. 468.

40.00 Chains. A fir 18" in diam. with mark $\frac{1}{4}$ S on W face.

From which:

A fir 12" in diam. bears N 62° E 32 lks. marked $\frac{1}{4}$ S BT.
A fir 10" in diam. bears S 27° W 12 lks. marked $\frac{1}{4}$ S BT.

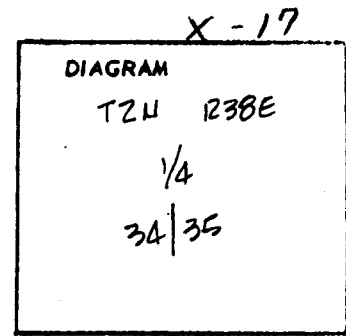

Description of corner evidence found:

Found $\frac{1}{4}$ as described, now 22" in diam.

Found BTs NE, now 20" in diam., and SW, now 19" in diam.

REGISTERED
PROFESSIONAL
LAND SURVEYOR
James H. Buisman
OREGON
JULY 22, 1977
JAMES H. BUISMAN
1097

Description of monument and accessories established to perpetuate the original location of this corner

5.00' West of the position described above, I set a 2 1/2" x 30" aluminum pipe 20" in the ground with an aluminum cap marked as shown:

I nailed a brass washer marked OPLS 1097 to BT blazes.

I set a steel fence post 5' West with signs 54-4 and 54-9.

I painted a red band around BTs and face of scribe.

I used a steel tape and Wild T-2 and measured a horizontal distance to the center of the BTs.

This corner was set October 8, 1980. Witness by Patrick L. Murphy.

See map of survey.

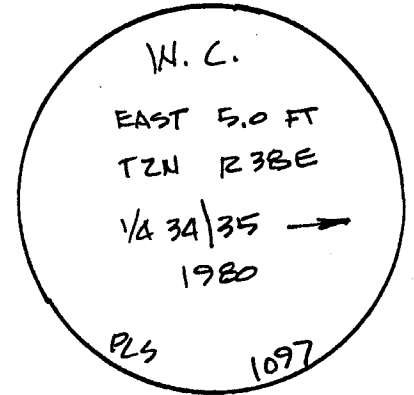

Office of County of
State of , I hereby certify that the within instrument was filed in this office
for record on the day of
..... by
(COUNTY OFFICIAL) (DEPUTY)

UNION COUNTY
SURVEYOR
Date Received _____
Date Filed _____
By _____ GPO 796-333
File No. 251-83R