

CERTIFIED RECORD OF LAND CORNER MONUMENTATION

**HISTORY OF ORIGINAL CORNER ESTABLISHED:**

Corner not previously established.

T 2 N R 38 E Q-23

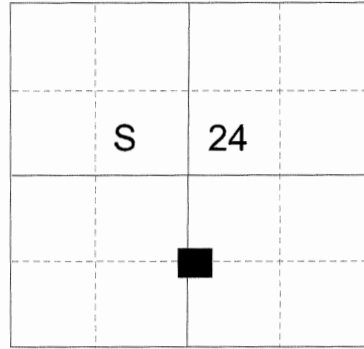

**DESCRIPTION OF CORNER EVIDENCE FOUND:**

None.

SEE SURVEY NUMBER 023-2018

**DESCRIPTION OF MONUMENT AND ACCESSORIES I ESTABLISHED**

**TO MONUMENT THE LOCATION OF THIS CORNER:**

At position determined by survey, I set 5/8" x 30" iron pin, 28 inches in the ground, with a 2 1/2" aluminum cap marked as shown below, from which:

A 14" Ponderosa Pine bears North 41° East, a distance of 23.70 feet, marked CS 1/16 S24 BT.  
A 9" White fir bears South 13° West, a distance of 9.65 feet, marked CS 1/16 S24 BT.

Set steel fence post approx. 1' North

Corner falls approx. 200 ft. East of a logging rd.

I hereby certify that this monument was set June 12, 2018.

Witness: Kyle Tucker

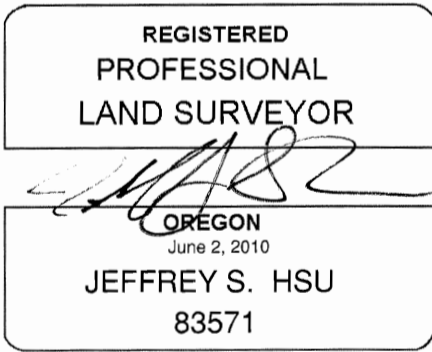

Renewal Date: June 30, 2019

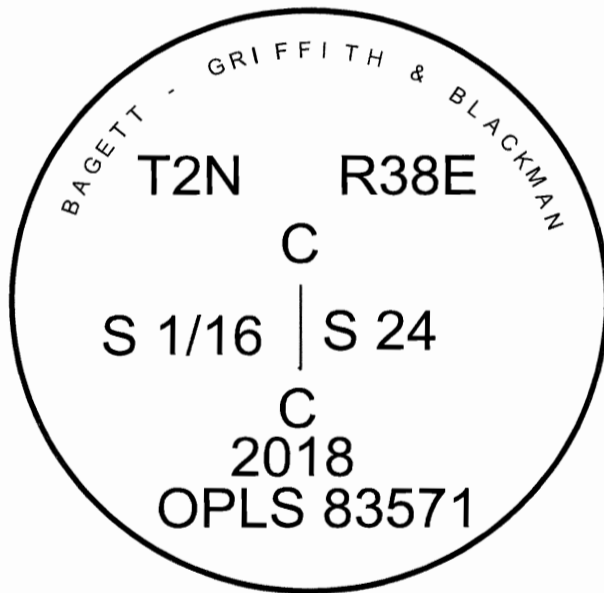
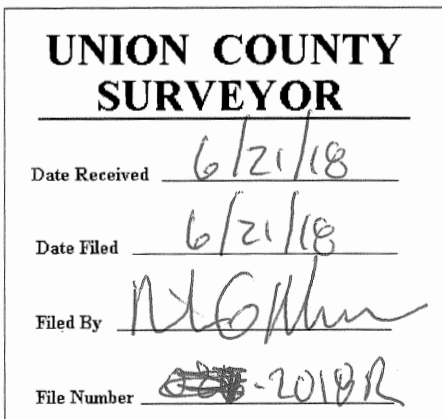

I use a steel tape and magnetic compass in the establishment of the bearing trees. Magnetic declination used was 13° East. Distances are to a spike in the root crown of the trees. Bearings are to a brass washer in the lower blaze marked OPLS 83571.