

RECOVERY NOTES  
BOISE CASCADE CORP.  
PROPERTY CORNER INVESTIGATION

J-23  
LOCATION

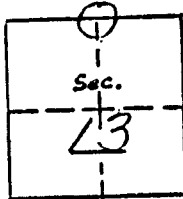

T. 2 N R. 38 E  
Mer. WN State OR  
Forest \_\_\_\_\_ Dist. \_\_\_\_\_  
Compartment or Tract G-P

LEGEND

- Corner searched-no evidence
- Corner or accessory found
- Corner marked by perm. mon.

DESCRIPTION OF FOUND CORNER

MATERIAL: \_\_\_\_\_ SIZE: \_\_\_\_\_  
HEIGHT ABOVE GROUND: \_\_\_\_\_ CONDITION: \_\_\_\_\_  
MARKINGS: \_\_\_\_\_

DESCRIPTION OF FOUND ACCESSORIES

*Searched for corner, but could find  
no evidence - area has been logged  
heavily.*

Note: Indicate full investigative details on back of form and where  
cruise tag placed in reference to corner.

PHOTO IDENTIFICATION

Symbol & date \_\_\_\_\_ Line or Roll \_\_\_\_\_ Exposure \_\_\_\_\_  
How Identified \_\_\_\_\_ Where filed \_\_\_\_\_

RECOVERED BY: R. L. McIlroy  
DATE: 8-9-77 TITLE: Forester

UNION COUNTY  
SURVEYOR

Date Received 1-4-88

Date Filed 1-7-88

By G. LANGLITZ, DEPUTY

File No. 37-88R

J-23

CERTIFIED RECORD OF LAND CORNER MONUMENTATION

History of original corner establishment:

Corner originally established by Frank W. Campbell under GLO contract number 468 dated April 12, 1883. Surveyor General record states:

Set a post 3½ ft long 3 ins square with marked stone 12 ins in ground for ¼ Sec cor marked ¼S on N face, from which;

A fir 12 ins dia bears N20°E 10 lks dist marked ¼S BT  
A fir 12 ins dia bears S20°E 12 lks dist marked ¼S BT

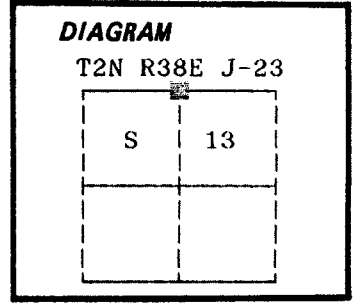

No record of subsequent monumentation found in Union County survey records.

Description of corner evidence found:

Found no evidence of the original corner monument or its accessories. Area has been heavily logged and burned.

See map of survey dated August, 1989.

**UNION COUNTY SURVEYOR**

---

Date Received 8-21-89  
Date Filed 8-23-89  
By G. LAUGLITZ DEPUTY  
File No. 161-89 R

Description of monument and accessories I established to perpetuate the

original location of this corner: At position determined by survey, I set a 2½"x30 aluminum pipe with aluminum cap marked as shown, 28 inches in the ground, from which:

New Bearing Trees;

A 10 inch diameter Ponderosa Pine bears N34°E, 41.48 feet, marked ¼ S12 BT  
A 8 inch diameter Douglas Fir bears S55°E, 18.00 feet, marked ¼ S13 BT

Painted a 6 inch red band around all BTs and attached bearing tree and land survey monument signs.

Set a steel fence post approximately 5 feet East with Land Survey Monument and Property Boundary signs attached.

I hereby certify that the above corner point was perpetuated as hereon described on July 25, 1989.

Witnesses: Jeff Petersen and Rick Robinson

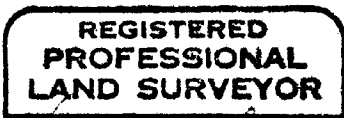
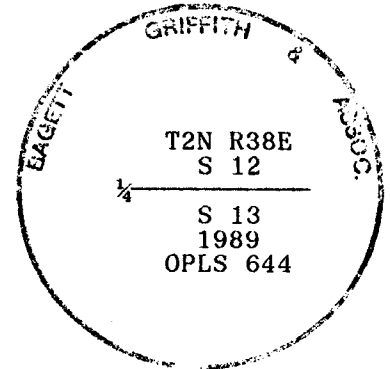

*[Handwritten Signature]*

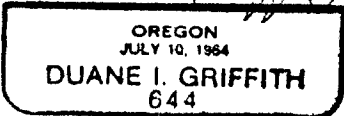

I used a steel tape and magnetic compass in the establishment of new accessories. I used 17° East magnetic declination and the distances are to a 50d spike driven in the right side of the root crown. I attached a brass washer marked OPLS 644 to the BT blaze.

Office of..... County of.....  
State of....., I hereby certify that the within instrument was filed in this office for record on the..... day of....., 19....

..... by .....  
(COUNTY OFFICIAL) (DEPUTY)