

CERTIFIED RECORD OF LAND CORNER MONUMENTATION

2-17

History of original corner establishment:

Original Notes are.;

From the cor the bearing trees are;

A tamarack 9" in diam bears N57°E 12 lks dist Mkd.  $\frac{1}{4}$ S BT;  
A fir 5" in diam bears S65°W 8 lks dist Mkd  $\frac{1}{4}$ s BT;

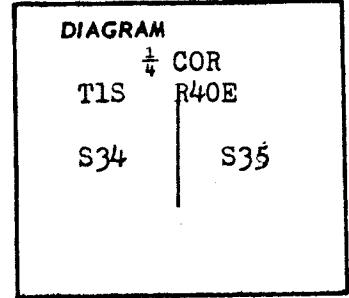

Description of corner evidence found:

Found the tamrack down with scribe.;

Description of monument and accessories established to perpetuate the original location of this corner

At the position of the corner I set a 2" galvanized pipe with brass cap 36" long Approx 30" in ground from which I set following bearing trees.;

A red fir 12" in diam bears N14°E a dist of 7.4 ft. Mkd  $\frac{1}{4}$ s BT;  
A white fir 14" in diam bears S52°W a dist of 12.9 ft. Mkd  $\frac{1}{4}$ sBT;

I stamped the cap:

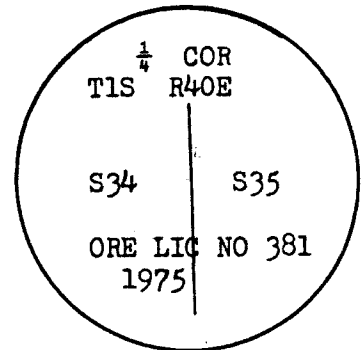

Office of County surveyor County of Union  
State of Oregon, I hereby certify that the within instrument was filed in this office  
for record on the 7 day of June; 19 75, at 4 o'clock P.m., (signed  
[Signature] by \_\_\_\_\_  
(COUNTY OFFICIAL) (DEPUTY)

|                          |  |
|--------------------------|--|
| <b>UNION COUNTY</b>      |  |
| <b>SURVEYOR</b>          |  |
| Date Received _____      |  |
| Date Filed _____         |  |
| By _____                 |  |
| File No. <u>191-84 R</u> |  |

**CERTIFIED RECORD OF LAND CORNER MONUMENTATION**

**HISTORY OF ORIGINAL CORNER ESTABLISHMENT:**

Corner originally established by Henry Meldrum in GLO Contract Number 450, dated June 11, 1882. Surveyor General Field Notes state:

Set a post 3 ft. long, 3 inches square, 24 in. in ground for 1/4 Sec. Corner, from which:  
A tamarack, 9 in. diam., bears N57°E, 12 lks. dist., marked 1/4 S. BT.  
A Fir 5 in. diam. bears S65°W, 8 lks. dist., marked 1/4 S BT.

Corner brought to county standard by James Voelz in 1975 from original corner evidence. Union County monumentation record 191-84R states:

At the position of the corner, I set a 2" galvanized pipe with brass cap, 36" long approx 30" in ground from which I set the following bearing trees:  
A red fir 12" in diam bears N14°E a dist of 7.4 ft. mkd 1/4 S BT.  
A white fir 14" in diam bears S52°W, a dist of 12.9 ft. mkd 1/4 S BT.

T 1 S R 40 E X-17

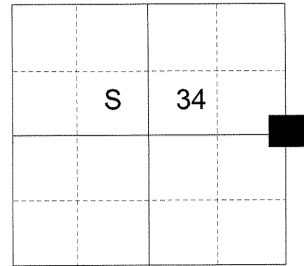

**DESCRIPTION OF CORNER EVIDENCE FOUND:**

Found a 2 1/2" iron pipe with 3" brass cap marked as shown below, 10 inches above ground, from which:  
A 19 inch Douglas Fir bears North 14° East, a distance of 7.4 feet, alive and vigorous with healed blaze.  
A 19 inch Fir snag bears South 52° West, a distance of 12.9 feet, with healed blaze.

**DESCRIPTION OF MONUMENT AND ACCESSORIES I ESTABLISHED TO PERPETUATE THE ORIGINAL LOCATION OF THIS CORNER:**

From the iron pipe monument,

**NEW BEARING TREES:**

A 10 inch Lodgepole Pine bears South 22° East, a distance of 31.80 feet, marked 1/4 S35 BT.  
An 11 inch White Fir bears South 66° West, a distance of 39.20 feet, marked 1/4 S 35 BT.  
A 6 inch White Fir bears North 70° West, a distance of 15.50 feet, marked 1/4 S34 BT.

Corner falls on East side of a fence corner.  
I hereby certify that the corner was perpetuated on June 22, 2015.  
Witness: Thomas J. Kopp

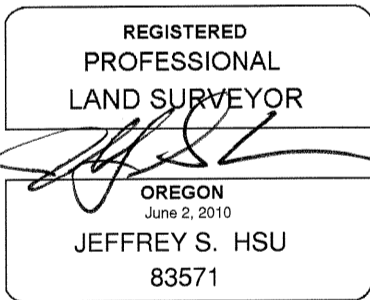

Renewal Date: June 30, 2017

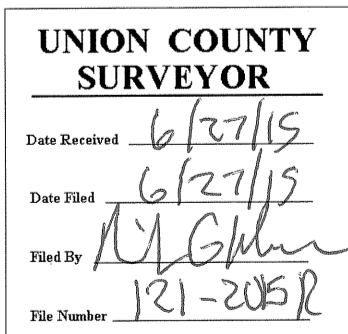
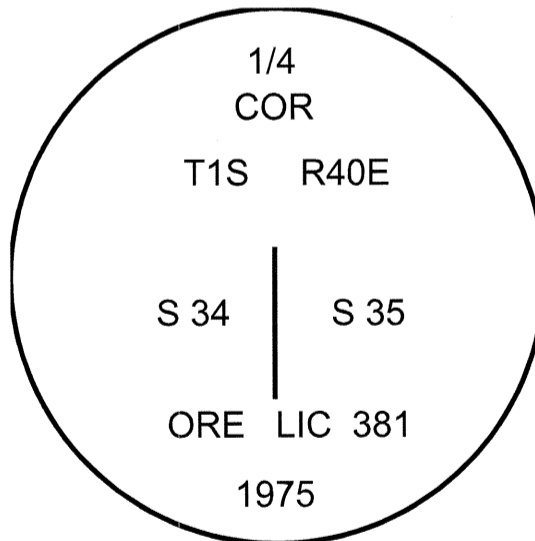

I used a steel tape and magnetic compass in the establishment of new accessories. I use a magnetic declination of 16° East. The distance to the bearing tree is to a 50d spike driven in the right side of the tree at the root crown. I attached a brass washer marked OPLS 83571 to the BT blaze.