

CERTIFIED RECORD OF LAND CORNER MONUMENTATION

HISTORY OF ORIGINAL CORNER ESTABLISHMENT:

Corner originally established by Henry Meldrum under GLO contract Number 450, dated 1882. Surveyor General record states:

Set post 4 ft long 4 in square 24 in. in ground for cor to Secs. 27,28,33,34 marked T1S.27 on NE., S 34 on SE., S 33 on SW and R40E S 28 on NW Faces with 1 notch on S and 3 on E edges from which, A fir 30 in diam bears N 48°E, 63 LKS dist marked T1S S27, B.T. A fir 5 in diam bears N 33°W, 59 LKS dist marked R40E S28, B.T. A fir 20 in diam bears S 5°W, 63 LKS dist marked S33 B.T. A fir 24 in diam bears S82°E, 62 LKS dist marked S 34 B.T.

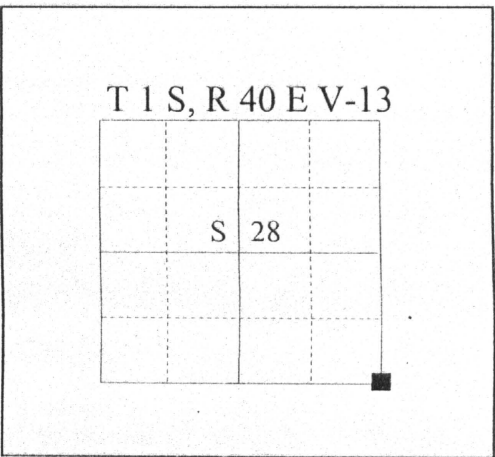

DESCRIPTION OF CORNER EVIDENCE FOUND:

None

See Survey No. 039-2004

DESCRIPTION OF MONUMENT AND ACCESSORIES I ESTABLISHED TO PERPETUATE THE ORIGINAL LOCATION OF THIS CORNER:

At the proportionate position determined by survey, I set a 2½" x 30" aluminum monument with aluminum cap marked as shown, 27 inches in the ground from which:

BEARING OBJECTS:

- A 14" spruce bears N 84°E a distance of 18.40 feet, marked T1S R40E S27 BT.
- A 9" spruce bears S 19°W a distance of 18.75 feet, marked X BT.
- A 10" spruce bears S 50°W a distance of 13.70 feet, marked T1S R40E S33 BT.
- A 5/8" x 30" Iron rebar with 1½ inch aluminum cap bears N 24°W, a distance of 19.85 feet marked NW RP.

I hereby certify that the corner was monumented on December 2, 2004
Witnesses: Greg Blackman Jr.

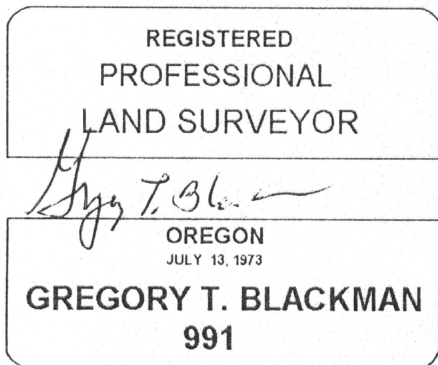

Renewal Date: December 31, 2005

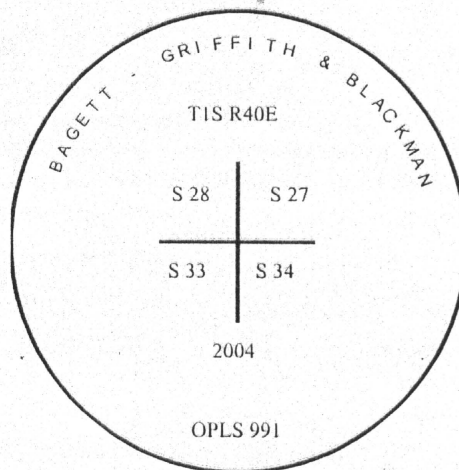

UNION COUNTY SURVEYOR

Date Received 12/30/04

Date Filed 12/30/04

Filed By P. Robinson, Deputy

File Number 102-2004R

I used a steel tape and magnetic compass in the establishment of the new accessories. I used 18° East declination. Distances are to a 50d spike driven into the root crown of the bearing tree in the right side. A brass washer marked OPLS 991 was attached to the BT blaze. Distance to bearing object is to the center of the aluminum cap.

RECOVERY NOTES
BOISE CASCADE CORP.
PROPERTY CORNER INVESTIGATION

V-13
LOCATION

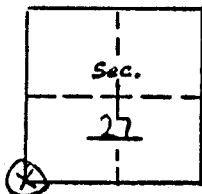

T. 15 R. 40E
Mer. State OR
Forest Dist. Elgin
Compartment or Tract Mt. Harris

LEGEND

- Corner searched-no evidence
- ⊗ Corner or accessory found
- Corner marked by perm. mon.

DESCRIPTION OF FOUND CORNER

MATERIAL: Rd metal fence post SIZE: _____
HEIGHT ABOVE GROUND: 3' CONDITION: good
MARKINGS: BLM Property marker

DESCRIPTION OF FOUND ACCESSORIES

This is a corner of a BLM 40-acre tract. Blazes marked the property line. No corner evidence or BT's were found. Fence post

Rd is about 50 east of corner
Meadow is about 50 north

Note: Indicate full investigative details on back of form and where cruise tag placed in reference to corner.

PHOTO IDENTIFICATION

Symbol & date 1992 Line or Roll 19A Exposure 8
How Identified _____ Where filed _____

RECOVERED BY: DM

DATE: 12/21/82 TITLE: _____

UNION COUNTY
SURVEYOR

Date Received 1-4-88

Date Filed 1-7-88

By G. LANGLITZ, DEPUTY

File No. 18-88R

V-13

CERTIFIED RECORD OF LAND CORNER MONUMENTATION

HISTORY OF ORIGINAL CORNER ESTABLISHMENT:

Corner originally established by Henry Meldrum under GLO contract Number 450, dated 1882. Surveyor General record states:

Set post 4 ft long 4 in square 24 in. in ground for cor to secs 27, 28, 33, 34 marked T.1. S.27 on NE.-S. 34 on SE. S 33 on SW and R. 40 E. S 28 on NW Face with 1 notch on S and 3 on E edges from which, A fir 30 in diam bears N 48°E 63 LKS dist marked T.1. S. S. 27, B.T. A fir 5 in diam bears N 33° W 59 LKS dist marked R,40,E. S.28, B.T. A fir 20 in diam bears S 5°W 63 LKS dist marked S33 B.T. A fir 24 in diam bears S82° E 62 LKS dist marked S 34 B.T.

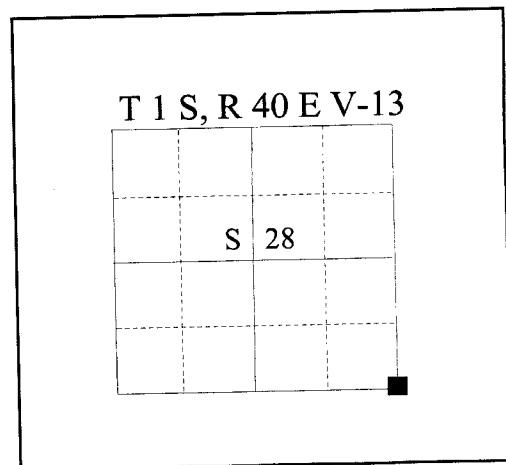

DESCRIPTION OF CORNER EVIDENCE FOUND:

None

See Survey No. 039-2004

DESCRIPTION OF MONUMENT AND ACCESSORIES I ESTABLISHED TO PERPETUATE THE ORIGINAL LOCATION OF THIS CORNER:

At the proportionate position determined by survey, I set a 2½" x 30" aluminum monument with aluminum cap marked as shown, 27 inches in the ground from which:

BEARING OBJECTS:

A 14" spruce bears N 84°E a distance of 18.40 feet, marked T1S R40 S27 BT.

A 9" spruce bears S 19°W a distance of 18.75 feet, marked X BT.

A 10" spruce bears S 50°W a distance of 13.70 feet, marked T1S R40E S33 BT.

A 5/8" x 30" Iron rebar with 1½ inch aluminum cap bears N 24°W, a distance of 19.85 feet marked NW RP.

I hereby certify that the corner was monumented on December 2, 2004
Witnesses: Greg Blackman Jr.

REGISTERED
PROFESSIONAL
LAND SURVEYOR

Gregory T. Blackman
OREGON
JULY 13, 1973
GREGORY T. BLACKMAN
991

Renewal Date: December 31, 2005

**UNION COUNTY
SURVEYOR**

Date Received 12/30/04

Date Filed 12/30/04

Filed By R. ROBINSON, DEPUTY

File Number 102-2004R

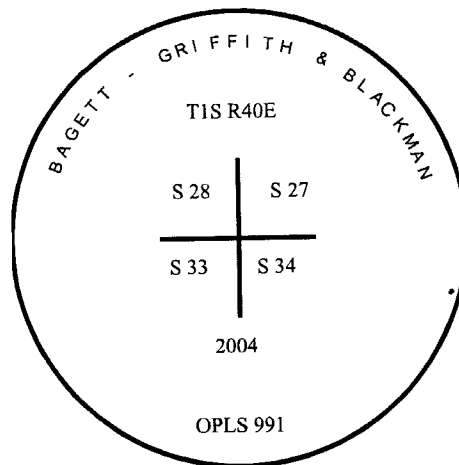

I used a steel tape and magnetic compass in the establishment of the new accessories. I used 18° East declination. Distances are to a 50d spike driven into the root crown of the bearing tree in the right side. A brass washer marked OPLS 991 was attached to the BT blaze.

HORIZONTAL CONTROL DATA

UNION COUNTY, OREGON

OREGON STATE PLANE, NORTH ZONE (3601)

STA NAME: 200432

1/4 SECTION CORNER COMMON TO SECTIONS 28 and 33

TWP. 1 S. RGE. 40 E.

GEODETIC COORD: NAD 83(91)

DATE TIED: December, 2004

LAT: 45 ° 26 ' 31.94062 " N

SURVEYOR: GREGORY T. BLACKMAN
OPLS 991

LONG: 117 ° 48 ' 33.77101 " W

FIRM: BAGETT, GRIFFITH, & BLACKMAN
2006 Adams Avenue
La Grande, OR 97850
(541) 963-6092

SP. COOR: NAD 83(91)

N: 658813.270 INT FT.

E: 8892552.221 INT FT.

TYPE: GPS

THETA: 1 ° 54 ' 29.3381587 "

ORDER: SECOND CLASS: 1

SCALE FACTOR: 0.9999059533

ELEV: 4491.79 US FT.

ELEV: DATUM: NGVD 29

COMMENTS:

2 1/2" Aluminum monument marked:

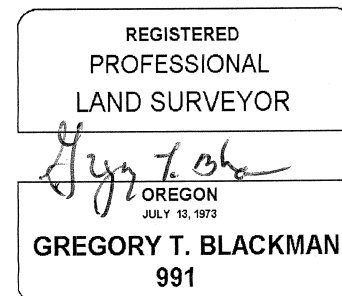
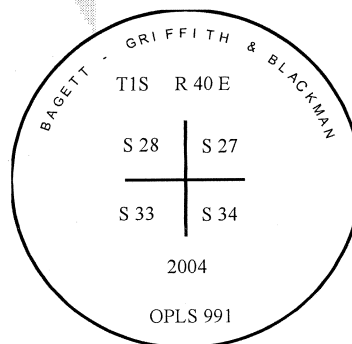

Renewal Date: December 31, 2005

1 METER = 3.2808333333... US FEET = 39.37 INCHES

1 METER = 3.280839895 INT'L FEET OR 1 INCH = 2.54 CM

TO CALCULATE ELEVATION FACTOR (IN THE NORTH AMERICAN CONTINENT)

DIVIDE 20,906,000 BY (20,906,000 + ELLIPSOID ELEV. IN FEET)