

**CERTIFIED RECORD OF LAND CORNER MONUMENTATION**

**HISTORY OF ORIGINAL CORNER ESTABLISHED:**

Corner originally established by Timothy W. Davenport under GLO joint contract no. 102, dated July 20, 1863. Surveyor General field notes state:

Set post corner to secs. 30, 31, 25, and 36, from which:

- A Spruce 4 inch in dia. bears S30°W, 12 lks. dist.
- A Spruce 4 inch in dia. bears S75°W, 35 lks. dist.
- A Spruce 6 inch in dia. bears N55°W, 89 lks. dist.

T 1 S R 39 E V-25

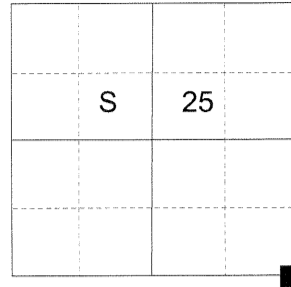

**DESCRIPTION OF CORNER EVIDENCE FOUND:**

None.

SEE SURVEY NUMBER 016-2020

**DESCRIPTION OF MONUMENT AND ACCESSORIES I ESTABLISHED TO MONUMENT THE ORIGINAL LOCATION OF THIS CORNER:**

At proportionate position, I set a 2 1/2" x 30" aluminum pipe, 28" in the ground, with 3" aluminum cap marked as shown below with 2' diam. ring of stone, from which:

**NEW BEARING OBJECTS:**

- A 7" Western Larch bears North 61° East, a distance of 27.20 feet, marked T1SR40E S30 BT.
- A 9" Lodgepole Pine bears South 41° East, a distance of 10.05 feet, marked T1SR40E S31 BT.
- An 8" Lodgepole Pine bears South 44° West, a distance of 13.00 feet, marked T1SR39E S36 BT.
- A 7" Ponderosa Pine bears North 5° West, a distance of 11.60 feet, marked T1SR39E S25 BT

Set steel fence post approx. 1 foot North.

An East/West fence line bears North approx. 50 feet.

I hereby certify that the corner was monumented on May 14, 2020.

Witness: Kyle A. Tucker

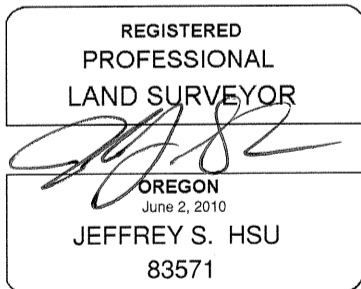
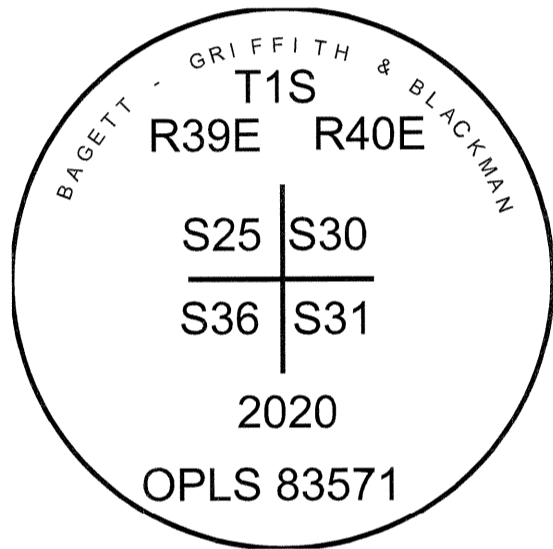

Renewal Date: June 30, 2021

I used a steel tape and magnetic compass in the establishment of the new accessories. I used 14° East declination, the distances are to a 60d spike driven into the right side of the root crown of the bearing trees. A brass washer marked OPLS 83571 is attached to the BT blaze of the new bearing trees.

