

**UNION COUNTY SURVEYOR**

**CERTIFIED RECORD OF LAND CORNER MONUMENTATION**

**HISTORY OF ORIGINAL CORNER ESTABLISHMENT:**

Corner originally established by Henry Meldrum under GLO contract Number 450, dated June 11, 1882. Surveyor General record states: Set post, 24" in the ground, marked ¼S on North face, from which:  
A Pine 12" in diameter bears S 67°E, 26 lks. Distant, marked ¼ S BT.

A pine 16" in diameter bears S 40°W, 46 lks. Distant, marked ¼ S BT

No record of subsequent monumentation found in Union County survey records.

**DESCRIPTION OF CORNER EVIDENCE FOUND:**

Found Southeast bearing tree stump, loose on the ground, stump hole evident. Stump badly rotted, with scribes visible.

**DESCRIPTION OF MONUMENT AND ACCESSORIES I ESTABLISHED TO PERPETUATE THE ORIGINAL LOCATION OF THIS CORNER:**

At the corner position as determined by bearing and distance from the stump hole, I set a 2½" x 30" aluminum pipe with 2½" aluminum cap marked as shown below, 26" in the ground, and raised a small mound of stone with a 2 foot base, from which:

- A 10" Tamarack bears N 29°E, a distance of 53.18 feet, marked X B.T.
- A 13" Ponderosa Pine bears S 30° E, a distance of 67.92 feet, marked ¼ S 29 B.T.
- A 10" Ponderosa Pine bears S 7° W, a distance of 37.15 feet, marked ¼ S 30 B.T.
- A 16" Tamarack bears N 18° W, a distance of 35.00 feet, marked ¼ S 30 B.T.

I hereby certify that the corner was monumented on December 1, 1999.  
Witness: Rick Robinson, Greg Blackman Jr.

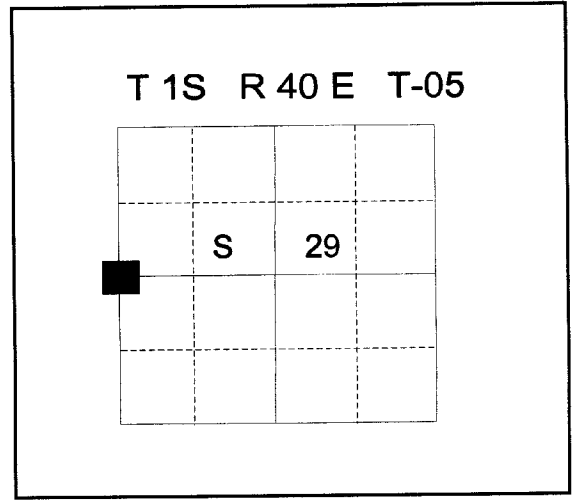

REGISTERED  
PROFESSIONAL  
LAND SURVEYOR  
*Gregory T. Blackman*  
OREGON  
JULY 13, 1973  
GREGORY T. BLACKMAN  
991

Renewal Date: December, 31 1997

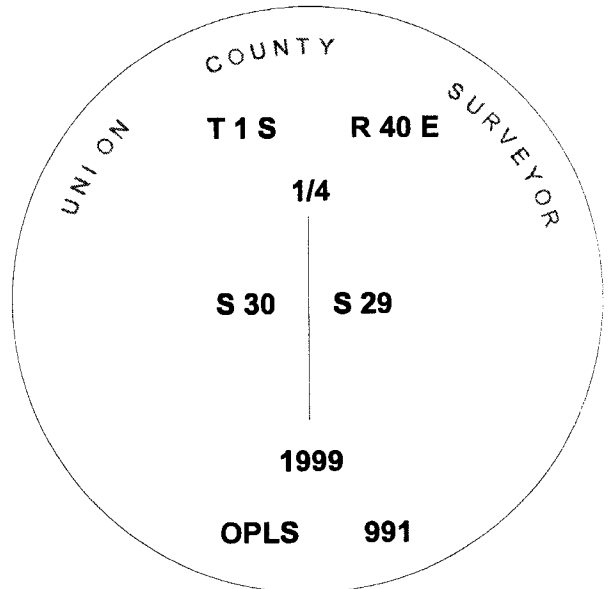

**UNION COUNTY  
SURVEYOR**  
Date Received 12/23/99  
Date Filed 1/7/2000  
Filed By *Rick E. Robinson*  
File Number 061-1999R

I used a steel tape and magnetic compass in the establishment of the new accessories. I used 18° East declination.

RECOVERY NOTES  
BOISE CASCADE CORP.  
PROPERTY CORNER INVESTIGATION

T-5  
LOCATION

T. 15 R. 40  
Mer. \_\_\_\_\_ State \_\_\_\_\_  
Forest \_\_\_\_\_ Dist. \_\_\_\_\_  
Compartment or Tract \_\_\_\_\_

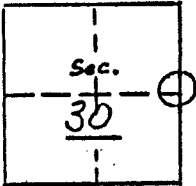

- LEGEND  
 → ○ Corner searched-no evidence  
 ⊗ Corner or accessory found  
 ● Corner marked by perm. mon.

DESCRIPTION OF FOUND CORNER

MATERIAL: \_\_\_\_\_ SIZE: \_\_\_\_\_  
 HEIGHT ABOVE GROUND: \_\_\_\_\_ CONDITION: \_\_\_\_\_  
 MARKINGS: \_\_\_\_\_

DESCRIPTION OF FOUND ACCESSORIES

Note: Indicate full investigative details on back of form and where  
cruise tag placed in reference to corner.

PHOTO IDENTIFICATION

Symbol & date \_\_\_\_\_ Line or Roll \_\_\_\_\_ Exposure \_\_\_\_\_  
 How Identified \_\_\_\_\_ Where filed \_\_\_\_\_

RECOVERED BY: Rm Key  
 DATE: 1-30-79 TITLE: \_\_\_\_\_

*I searched for 1/4 cor but found nothing. A fence corners at the approx. location. It is about 2 ch E of road. Should search for this corner again whenever snow is gone.*

UNION COUNTY  
SURVEYOR

Date Received 1-4-88

Date Filed 1-7-88

By G. LANGLITZ, DEPUTY

File No. 30-88R

T-5

**CERTIFIED RECORD OF LAND CORNER MONUMENTATION**

**HISTORY OF ORIGINAL CORNER ESTABLISHED:**

Corner originally established by Henry Meldrum under GLO contract Number 450, dated June 11, 1882. Surveyor General field notes state:  
Set post 3 ft long 3 in square 24 in in ground for 1/4 Sec. Cor marked 1/4 S on the N face from which:

A pine 12" in diam bears S 67°E 26 lks. dist marked 1/4 S.B.T.  
A pine 16" in diam bears S 40°W 46 lks dist marked 1/4 S.B.T.

In 1999, Greg Blackman brings corner to County Standard from original GLO evidence (Southeast bearing tree stump). Union County Monumentation Record states:

**T 1 S R 40 E T-05**

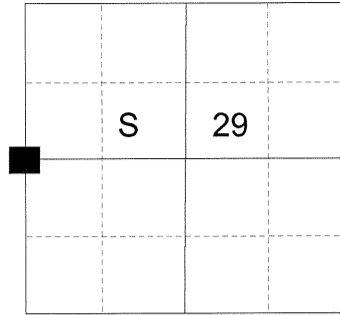

At the corner position determined by bearing and distance from the stump hole, I set a 2 1/2" aluminum pipe with 2 1/2" aluminum cap marked as shown below, 26" in the ground, and raised a small mound of stone with a 2 foot base, from which:

A 10" Tamarack bears N29°E, a distance of 53.18 feet, marked X B.T.  
A 13" Ponderosa Pine bears S 30°E, a distance of 67.92 feet, marked 1/4 S 29 B.T.  
A 10" Ponderosa Pine bears S 7°W, a distance of 37.15 feet, marked 1/4 S 30 B.T.  
A 16" Tamarack bears N 18°W, a distance of 35.00 feet, marked 1/4 S 30 B.T.

**DESCRIPTION OF CORNER EVIDENCE FOUND:**

Found a 2 1/2" aluminum pipe with a 2 1/2" aluminum cap marked as shown below, 4" above ground with a collar of stone 2 foot in diameter. From which:

A 15" Ponderosa Pine bears South 30° East, a distance of 67.92 feet, alive and vigorous with scribe marks visible on partially healed blaze.  
A 15" Ponderosa Pine bears South 7° West, a distance of 37.15 feet, alive and vigorous with scribe marks visible on partially healed blaze.

**DESCRIPTION OF MONUMENT AND ACCESSORIES I ESTABLISHED TO PERPETUATE THE ORIGINAL LOCATION OF THIS CORNER:**

From the aluminum pipe monument

**NEW BEARING TREES:**

A 5" White Fir bears North 11° East, a distance of 17.00 feet, marked X BT.  
A 5/8" iron pin bears North 7° 10' West, a distance of 76.53 feet, with a 1 1/2" aluminum cap marked BGB SURVEY MARKER NW RP.

I set a steel fencepost approximately 2 foot North of the corner monument.

I hereby certify that this corner was perpetuated on February 25, 2015.

Witness: Thomas J. Kopp

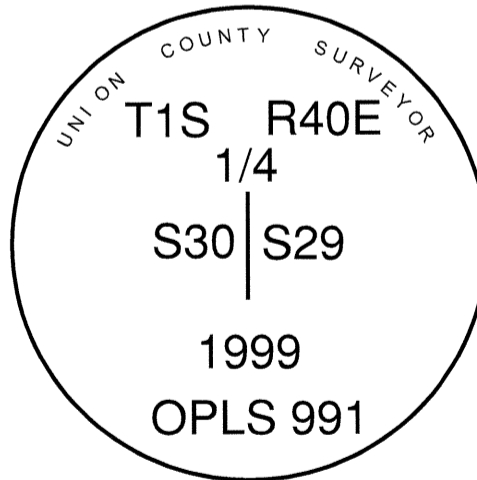

**UNION COUNTY SURVEYOR**

Date Received 3/11/15

Date Filed 3/11/15

Filed By NA G... [Signature]

File Number 072-2015R

I used a steel tape and magnetic compass in the establishment of the new tree accessory. I used 16° East declination, the distances are to a 60d spike driven into the right side of the root crown of the new bearing tree. A brass washer marked OPLS 83571 is attached to the BT blaze of the new bearing trees. Bearing and distances to the iron pin accessory were determined by GPS observation with a Leica GS-15 unit. The Basis of Bearing is as per Survey Number 013-2015.