

**CERTIFIED RECORD OF LAND CORNER MONUMENTATION**

**HISTORY OF ORIGINAL CORNER ESTABLISHED:**

Corner originally established by Timothy W. Davenport under GLO joint contract no. 102, dated July 20, 1863. Surveyor General field notes state:  
Set post corner to secs. 30,31,25, and 36, from which:  
A Tamarack 6 inch in dia. bears N25°W, 32 lks. dist.  
A Tamarack 6 inch in dia. bears S70°W, 36 lks. dist.

T 1 S R 39 E T-25

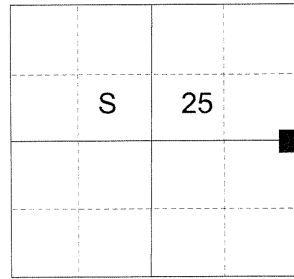

**DESCRIPTION OF CORNER EVIDENCE FOUND:**

None.

SEE SURVEY NUMBER 016-2020

**DESCRIPTION OF MONUMENT AND ACCESSORIES I ESTABLISHED TO MONUMENT THE ORIGINAL LOCATION OF THIS CORNER:**

At proportionate position, I set a 2 1/2" x 30" aluminum pipe, 28" in the ground, with 3" aluminum cap marked as shown below,  
from which:

**NEW BEARING OBJECTS:**

A 10" Western Larch bears North 69° East, a distance of 24.80 feet, marked 1/4 S30 BT.  
A 12" Western Larch bears South 75° East, a distance of 21.50 feet, marked 1/4 S30 BT.  
An 11" Western Larch bears South 34° West, a distance of 11.75 feet, marked 1/4 S25 BT.  
A 7" Douglas Fir bears North 12° West, a distance of 15.70 feet, marked 1/4 S25 BT

Set steel fence post approx. 1 foot North.

I hereby certify that the corner was monumented on May 14, 2020.

Witness: Kyle A. Tucker

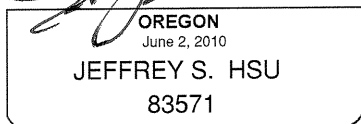
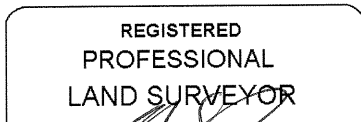
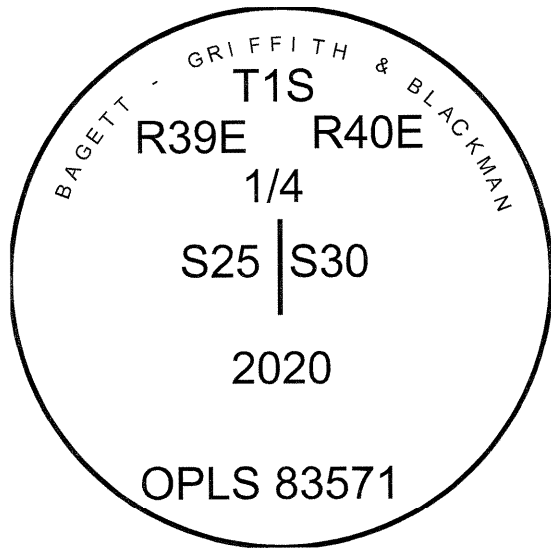

Renewal Date: June 30, 2021

I used a steel tape and magnetic compass in the establishment of the new accessories. I used 14° East declination, the distances are to a 60d spike driven into the right side of the root crown of the bearing trees. A brass washer marked OPLS 83571 is attached to the BT blaze of the new bearing trees.

**UNION COUNTY SURVEYOR**  
Date Received 5/15/20  
Date Filed 5/15/20  
Filed By Nick Gillman  
File Number 037-2020R