

**CERTIFIED RECORD OF LAND CORNER MONUMENTATION**

**HISTORY OF ORIGINAL CORNER ESTABLISHMENT:**

Corner originally established by Henry Meldrum under GLO contract Number 450, dated 1882. Surveyor General record states:

Set post 3 ft long 3 in square 24 in. in ground for 1/4 sec cor marked 1/4 S on north face from which:  
A pine 15 ins in diam bears N 11°E 102 LKS dist marked 1/4 S BT A pine 15 ins in diam bears S 22°W, 114 LKS dist marked 1/4 S BT

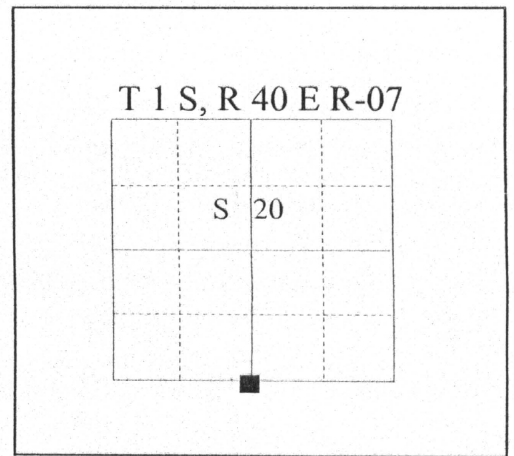

**DESCRIPTION OF CORNER EVIDENCE FOUND:**

A ponderosa pine bears S 22°W 75.24 feet, tree is alive with visible scribes.

See Survey No. 042-2004

**DESCRIPTION OF MONUMENT AND ACCESSORIES I ESTABLISHED**

**TO PERPETUATE THE ORIGINAL LOCATION OF THIS CORNER:**

At record bearing and distance from bearing tree; I set a 2½" x 30" aluminum monument with aluminum cap marked as shown, 25 inches in the ground with mound of stone from which:

**BEARING OBJECTS:**

- A 15" Larch bears N 21°E, 73.88 feet, marked 1/4 S20 BT.
- A 15" Ponderosa Pine bears S 50°E, 75.50 feet, marked 1/4 S29 BT.
- A 22" Ponderosa Pine bears S 22°W, 75.24 feet, marked 1/4 S29 BT.
- A 7" White Fir bears N 5°W, 53.39 feet, marked 1/4 S20 BT.

I hereby certify that the corner was monumented on December 27, 2004  
Witnesses: Mike Spicer, Greg Blackman Jr.

REGISTERED  
PROFESSIONAL  
LAND SURVEYOR

*Greg T. Blackman*  
OREGON  
JULY 13, 1973  
**GREGORY T. BLACKMAN**  
991

Renewal Date: December 31, 2005

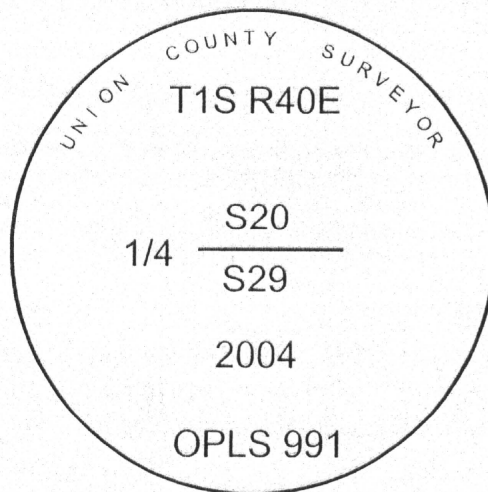

**UNION COUNTY SURVEYOR**

Date Received 12/30/04

Date Filed 12/30/04

Filed By R. ROBINSON, DEPUTY

File Number 109-2004R

I used a steel tape and magnetic compass in the establishment of new accessories. The magnetic declination used was 18° East. The distance to the bearing tree is to a 50d spike driven the right side of the tree at the root crown. I attached a brass washer marked OPLS 991 to the BT blaze.

**HORIZONTAL CONTROL DATA**  
**UNION COUNTY, OREGON**  
**OREGON STATE PLANE, NORTH ZONE (3601)**

STA NAME: 200425

1/4 SECTION CORNER COMMON TO SECTIONS: 20 and 29

TWP. 1 S. RGE. 40 E.

GEODETIC COORD: NAD 83(91)

DATE TIED: December 2004

LAT: 45 ° 27 ' 23.93441 " N

SURVEYOR: GREGORY T. BLACKMAN  
OPLS 991

LONG: 117 ° 50 ' 22.97853 " W

FIRM: BAGETT, GRIFFITH, & BLACKMAN  
2006 ADAMS AVENUE  
LAGRANDE, OR 97850  
(541) 963-6092

SP. COOR: NAD 83(91)

N: 663818.445 INT FT.

E: 8884597.173 INT FT.

TYPE: GPS

THETA: 1 ° 53 ' 11.8897079 "

ORDER: SECOND CLASS: 1

SCALE FACTOR: 0.9999071871

ELEV: 3642.00 US FT.

ELEV: DATUM: NGVD 29

**COMMENTS:**

Corner is 2 1/2" aluminum monument

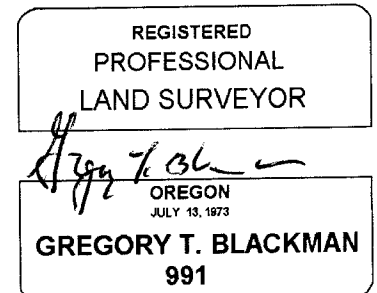
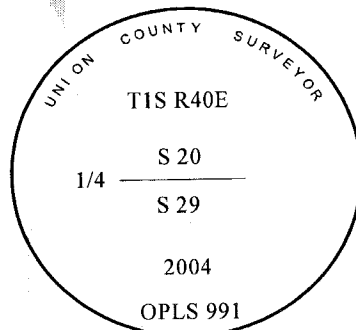

Renewal Date: December 31, 2005

1 METER = 3.280833333... US FEET = 39.37 INCHES

1 METER = 3.280839895 INT'L FEET OR 1 INCH = 2.54 CM

TO CALCULATE ELEVATION FACTOR ( IN THE NORTH AMERICAN CONTINENT)

DIVIDE 20,906,000 BY (20,906,000 + ELLIPSOID ELEV. IN FEET)