

**CERTIFIED RECORD OF LAND CORNER MONUMENTATION**

**HISTORY OF ORIGINAL CORNER ESTABLISHED:**

Corner not previously established

T 1 S R 40 E R-06

**DESCRIPTION OF CORNER EVIDENCE FOUND:**

None

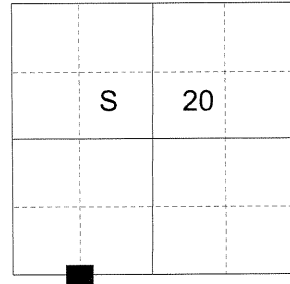

See Survey Number 021-2015

**DESCRIPTION OF MONUMENT AND ACCESSORIES I ESTABLISHED TO PERPETUATE THE ORIGINAL LOCATION OF THIS CORNER:**

At the position determined by survey, I set a 5/8" x 30" iron rod with a 2 1/2" aluminum cap marked as shown below, 30" in the ground. From which:

**NEW BEARING OBJECTS:**

An 11" Lodge Pole Pine bears South 24° West, a distance of 22.00 feet, marked W 1/16 S29 BT.

A 12" Douglas Fir bears North 57° West, a distance of 31.35 feet, marked W 1/16 S20 BT.

I set a steel fencepost approximately 1 foot North of corner monument.

I hereby certify that the corner was monumented on April 17, 2015.

Witness: Thomas J. Kopp

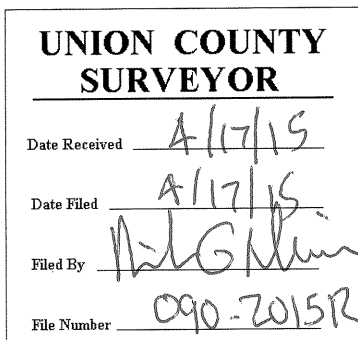
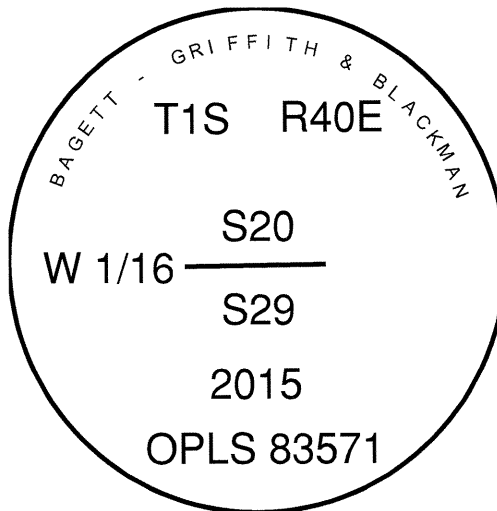

I used a steel tape and magnetic compass in the establishment of the new accessories. I used 16° East declination, the distances are to a 60d spike driven into the left side of the root crown of the bearing trees. A brass washer marked OPLS 83571 is attached to the BT blaze of the new bearing trees.