

CERTIFIED RECORD OF LAND CORNER MONUMENTATION

HISTORY OF ORIGINAL CORNER ESTABLISHED:

Corner was originally established under GLO Contract No. 450, dated August, 1882, executed by Henry Meldrum. Surveyor General field notes state:

Set post, 3 ft. long, 3 ins. sq., 24 ins. in the ground, for 1/4 sec. cor. marked 1/4 S on W face, from which:
A Fir 7 ins. diam. bears N83°W, 9 lks. dist. mkd. 1/4 S BT
A Fir 10 ins. diam. bears S33°E, 3 lks. dist. mkd. 1/4 S BT

T 1 S R 40 E P-17

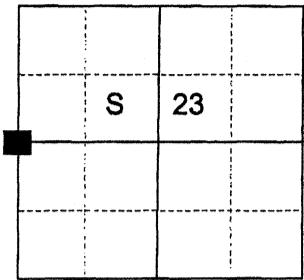

DESCRIPTION OF CORNER EVIDENCE FOUND:

None found

SEE SURVEY NUMBER 041-2025

DESCRIPTION OF MONUMENT AND ACCESSORIES I

ESTABLISHED TO MONUMENT THE ORIGINAL LOCATION OF THIS CORNER:

At position determined by survey, I set a 2 1/2" x 30" aluminum pipe, 29" in the ground, in a 2 ft. diam. collar of stone, with 3" aluminum cap marked as shown below, from which:

NEW BEARING OBJECTS:

A 7" diam. White Fir bears South 89° East, a dist. of 24.42 feet, marked 1/4 S23 BT
A 3" diam. White Fir bears South 2° East, a dist. of 12.35 feet, marked X BT
A 9" diam. White Fir bears North 4° West, a dist. of 31.00 feet, marked 1/4 S22 BT.
A 17" diam. Western Larch bears North 63° West, a dist. of 34.55 feet, marked 1/4 S22 BT

Set steel fence post approx. 1 ft. North

Falls on Southeast edge of North/South running forest road

I hereby certify that the corner was monumented October 14, 2025

Witness: Kyle Tucker, Jason Hatfield

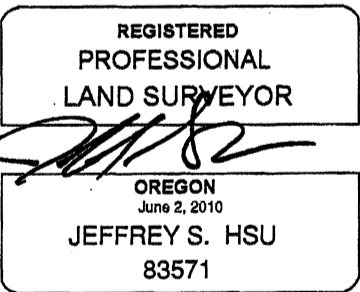
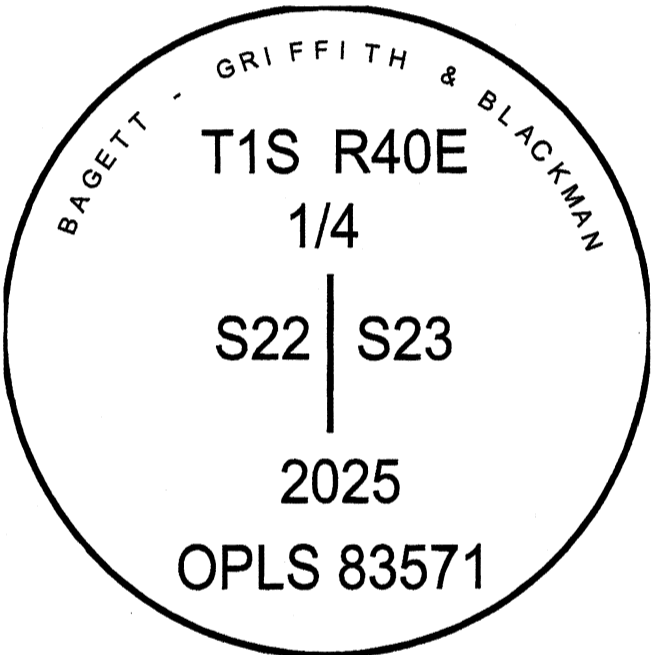

Renewal Date: June 30, 2027

I use a tape and compass in the establishment of the new bearing trees. Bearings are measured from the center of the aluminum cap to a brass washer marked "OPLS 83571" tacked to the BT blaze using 14° East for declination. Distances are measured to from the center of the brass cap to a 60D spike in the center right base of the tree.

