

UNION COUNTY SURVEYOR

CERTIFIED RECORD OF LAND CORNER MONUMENTATION

History of original corner establishment:

Corner originally established by Timothy W. Davenport under GLO contract Number 102, dated July 20, 1863. Surveyor General record states:

Set post from which:

- A Tamarack 10" dia. bears N50°W, 4 lks.
- A Pine 8" dia. bears S40°E, 16 lks.

No record of subsequent monumentation found in Union County survey records.

Description of corner evidence found:

Found 8" Ponderosa Pine snag on the ground with scribes visible. A ancient mound of stone was found directly to the south of the position established from the found BT.

See Union County Survey 025-1996

Description of monument and accessories I established to perpetuate the original location of this corner:

At record bearing and distance from the root hole of the found BT snag I set a 2½" x 30" aluminum pipe with aluminum cap marked as shown below, 28" in the ground, with a ring of stone, from which:

- A 22" White Fir bears N52°E, 26.57 feet, marked 1/4 S19 BT.
- A 28" Ponderosa Pine bears S57°E, 35.70 feet, marked 1/4 S19 BT.
- A 9" White Fir bears S81°W, 15.68 feet, marked 1/4 S24 BT.
- A 29" Ponderosa Pine bears N28°W, 14.43 feet, marked 1/4 S24 BT.

I hereby certify that the corner was monumented on June 20, 1996.

Witness: Mark Durbin, Jeff Madsen

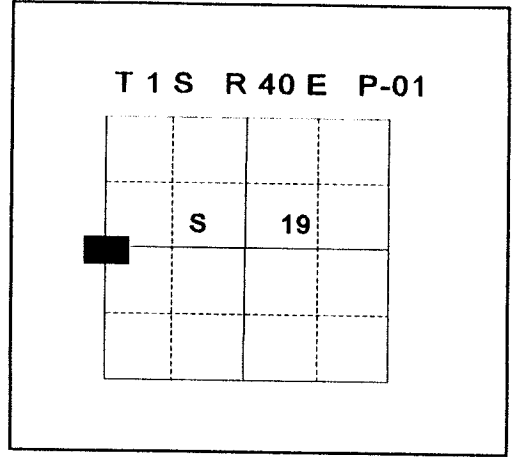

REGISTERED
PROFESSIONAL
LAND SURVEYOR

Jeffery P. Petersen
OREGON
JULY 20, 1993
JEFFERY P. PETERSEN
2625

Renewal Date: December, 31 1996

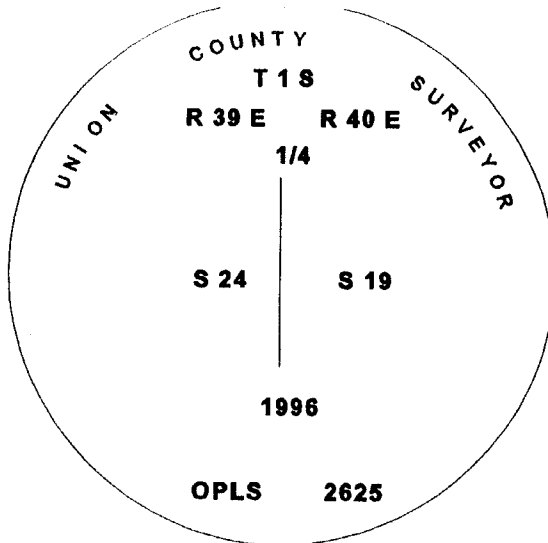

UNION COUNTY SURVEYOR

Date Received 7-3-96

Date Filed 7-3-96

Filed By R. Robinson, Deputy

File Number 059-1996R

I used a steel tape and magnetic compass in the establishment of the new accessories. I used 18° East declination, the distances are to a 60d spike driven into the right side of the root crown of the bearing trees.

CERTIFIED RECORD OF LAND CORNER MONUMENTATION

HISTORY OF ORIGINAL CORNER ESTABLISHED:

Corner originally established by Timothy W. Davenport under GLO Contract Number 102, dated July 20th, 1863. Surveyor General Field Notes state:

Set post from which:

- A Tamarack 10" dia. bears N50°W, 4 lks.
- A Pine 8" dia. bears S40°E, 16 lks.

In 1996, Jeffery P. Petersen, as part of Union County Survey number 025-1996, found an 8" Ponderosa Pine snag on the ground with scribes visible. An ancient mound of stone was found directly to the south of the position established from the found BT.

At record bearing and distance from the root hole of the found BT snag, Petersen set a 2 1/2" x 30" aluminum pipe with aluminum cap marked as shown below, 28" in the ground, with a ring of stone, from which:

- A 22" White Fir bears N52°E, 26.57 feet, marked 1/4 S19 BT.
- A 28" Ponderosa Pine bears S57°E, 35.70 feet, marked 1/4 S19 BT.
- A 9" White Fir bears S81°W, 15.68 feet, marked 1/4 S24 BT.
- A 29" Ponderosa Pine bears N28°W, 14.43 feet, marked 1/4 S24 BT/

T 1 S R 39 E P-25

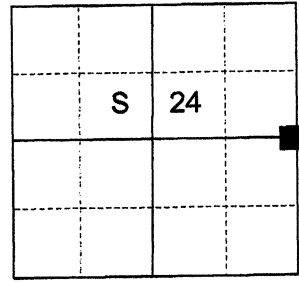

DESCRIPTION OF CORNER EVIDENCE FOUND:

Found 2 1/2" aluminum pipe with 2 1/2" aluminum cap 1" above ground in from which

A 20" White Fir stump dead and standing 6' tall bears North 52° East , a dist. of 26.57 feet, with scribes visible on partially healed blaze.

A 30" Ponderosa Pine dead and standing 5' tall bears North 28° West, a dist. of 14.4 feet, with scribes visible on partially healed blaze.

A remnant of 6' stump bears South 40° West, a distance of 16 lks, with scribes visible on an open blaze

SEE SURVEY NUMBER 019-2023

DESCRIPTION OF MONUMENT AND ACCESSORIES I ESTABLISHED TO PERPETUATE THE ORIGINAL LOCATION OF THIS CORNER:

From found aluminum pipe:

NEW BEARING OBJECTS:

A 6" Western Larch bears North 38° East, a dist. of 11 feet, marked 1/4 S 19 BT.

A 6" Western Larch bears South 27° East, a dist. of 15.35 feet, marked 1/4 S 19 BT.

An 8" Western Larch bears South 44° West, a dist. of 12.4 feet, marked 1/4 S 24 BT.

A 6" Ponderosa Pine bears North 49° West, a dist. of 2.4 feet, marked 1/4 S 24 BT.

Set steel fence post approx. 1 foot South.

I hereby certify that the corner was monumented on July 20, 2023.

Witness: Kyle Tucker, Adam Gordon

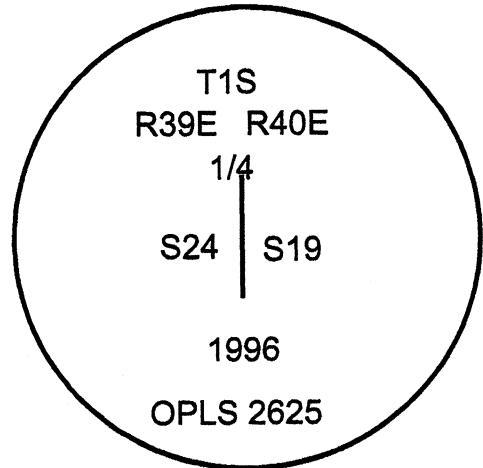

REGISTERED
PROFESSIONAL
LAND SURVEYOR

OREGON
June 2, 2010
JEFFREY S. HSU
83571

Renewal Date: June 30, 2025

UNION COUNTY
SURVEYOR

Date Received 9/5/23

Date Filed 9/5/23

Filed By [Signature]

File Number 081-2023R

I used a tape and compass in the establishment of new accessories. Bearing is measured to a brass washer labeled OPLS 83571 located at the center of BT blaze. Bearing is measured with a declination of 14° East. Distance is measured to a 60d spike nailed to center of tree, located at the right side base of tree.