

UNION COUNTY SURVEYOR

CERTIFIED RECORD OF LAND CORNER MONUMENTATION

HISTORY OF ORIGINAL CORNER ESTABLISHMENT:

Corner originally established by Henry Meldrum under GLO contract Number 450, dated December 1, 1882. Surveyor General record states:

Set post... from which:

- A Alder 3" dia. bears N80°E, 8 lks.
- A Alder 4" dia. bears N58°W, 25 lks.
- A Alder 5" dia. bears S37°W, 9 lks.
- A Alder 4" dia. bears S57°E, 11 lks.

No record of subsequent monumentation found in Union County survey records.

T 1 S R 40 E N - 13

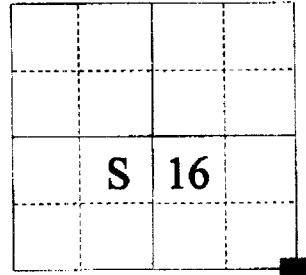

DESCRIPTION OF CORNER EVIDENCE FOUND:

The original corner was set in a swamp. The calls from the section corner to the edge of the swamp are as follows:

- North 2.50 chs leave marsh and ascend
- East 3.50 chs leave marsh and ascend
- South 0.50 enter marsh bears East and West

The swamp was well defined on the South and East edges. These respective measurements were held to establish an intersection for the corner position.

DESCRIPTION OF MONUMENT AND ACCESSORIES I ESTABLISHED TO PERPETUATE THE ORIGINAL LOCATION OF THIS CORNER:

- At position described above, I set a 2½" x 30" aluminum pipe with aluminum cap marked as shown below, 28" in the ground from which:
- A 9 inch White Fir bears N35°28'E, a distance of 70.38 feet, marked T1S R40E S15 BT.
- A 13 inch Spruce bears S30°35'E, a distance of 72.11 feet, marked T1S R40E S22 BT.
- A 18 inch Spruce bears S39°07'W, a distance of 34.94 feet, marked T1S R40E S21 BT.
- A 12 inch White Fir bears N69°02'W, a distance of 126.02 feet, marked T1S R40E S16 BT.

I hereby certify that the corner was monumented on October 13, 1998.
Witness: Norbert Volny and Greg Englegau

**REGISTERED
PROFESSIONAL
LAND SURVEYOR**

Rick G. Robinson

OREGON
July 17, 1980
RICK G. ROBINSON
2219

Renewal Date December 31, 1998

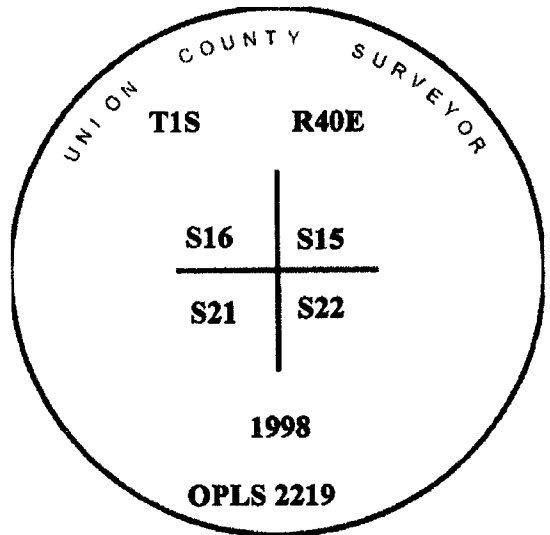

**UNION COUNTY
SURVEYOR**

Date Received 10/14/98

Date Filed 10/16/98

Filed By *Greg T. ...*

File Number 082-1998R

I used a total station instrument in the establishment of the new accessories. I used the same basis of bearing as survey number 043-1998, and the distances are to a 60d spike driven into the root crown of the bearing tree. A brass washer marked OPLS 2219 is attached to the BT blaze.

HORIZONTAL CONTROL DATA

UNION COUNTY, OREGON

OREGON STATE PLANE, NORTH ZONE (3601)

STA NAME: 200423

SECTION CORNER COMMON TO SECTIONS: 15, 16, 21 and 22

TWP. 1 S. RGE. 40 E.

GEODETIC COORD: NAD 83(91)

DATE TIED: December 2004

LAT: 45 ° 28 ' 16.49801 " N

SURVEYOR: GREGORY T. BLACKMAN
OPLS 991

LONG: 117 ° 48 ' 32.01958 " W

FIRM: BAGETT, GRIFFITH, & BLACKMAN
2006 ADAMS AVENUE
LAGRANDE, OR 97850
(541) 963-6092

SP. COOR: NAD 83(91)

N: 669400.924 INT FT.

E: 8892324.358 INT FT.

TYPE: GPS

THETA: 1 ° 54 ' 30.5802456 "

ORDER: SECOND CLASS: 1

SCALE FACTOR: 0.9999084991

ELEV: 4205.18 US FT.

ELEV: DATUM: NGVD 29

COMMENTS:

Corner is 2 ½" aluminum monument
marked as shown:

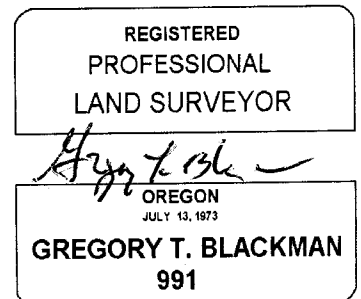
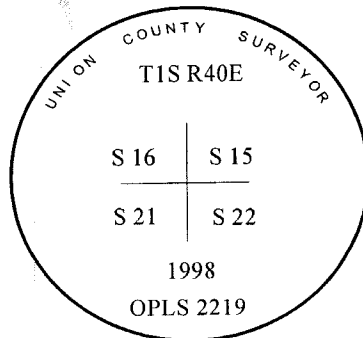

Renewal Date: December 31, 2005

1 METER = 3.2808333333... US FEET = 39.37 INCHES

1 METER = 3.280839895 INT'L FEET OR 1 INCH = 2.54 CM

TO CALCULATE ELEVATION FACTOR (IN THE NORTH AMERICAN CONTINENT)

DIVIDE 20,906,000 BY (20,906,000 + ELLIPSOID ELEV. IN FEET)