

UNION COUNTY SURVEYOR

CERTIFIED RECORD OF LAND CORNER MONUMENTATION

HISTORY OF ORIGINAL CORNER ESTABLISHMENT:

Corner originally established by Henry Meldrum under GLO contract Number 450, dated December 1, 1882. Surveyor General record states:

T 1 S R 40 E N - 07

Set post for 1/4 sec cor from which:

- A Pine 48" dia. bears N48°W, 37 lks.
- A Fir 24" dia. bears S12°E, 55 lks.

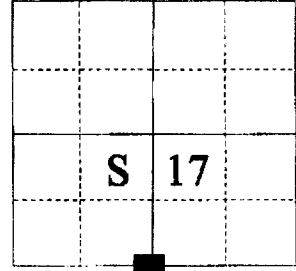

No record of subsequent monumentation found in Union County survey records.

DESCRIPTION OF CORNER EVIDENCE FOUND:

NONE
Corner position falls in the North edge of an existing logging road. See Union County Survey 045-1998

DESCRIPTION OF MONUMENT AND ACCESSORIES I ESTABLISHED TO PERPETUATE THE ORIGINAL LOCATION OF THIS CORNER:

At position determined by survey, I set a 2½" x 30" aluminum pipe with aluminum cap marked as shown below, 32" in the ground (2" below the surface of the roadway) from which:

- A 12 inch White Fir bears N44°E, a distance of 43.80 feet, marked 1/4 S17 BT.
- A 20 inch Tamarack bears S56°E, a distance of 101.92 feet, marked 1/4 S20 BT.
- A 13 inch Ponderosa Pine bears S71°W, a distance of 72.33 feet, marked 1/4 S20 BT.
- A 12 inch Ponderosa Pine bears N8°W, a distance of 37.52 feet, marked 1/4 S17 BT.

I hereby certify that the corner was monumented on October 21, 1998.
Witness: Norbert Volny, Rick Robinson

REGISTERED
PROFESSIONAL
LAND SURVEYOR

Rick G. Robinson

OREGON
July 17, 1988
RICK G. ROBINSON
2219

Renewal Date December 31, 1998

BAGETT - GRIFFITH & BLACKMAN

T1S R40E

1/4

S17

S20

1998

OPLS 2219

UNION COUNTY SURVEYOR

Date Received 10/23/98

Date Filed 10/24/98

Filed By *Angus T. Clark*

File Number 090-1998R

I used a steel tape and magnetic compass in the establishment of the new accessories. I used 18° East declination, the distances are to a 60d spike driven into the root crown of the bearing tree. A brass washer marked OPLS 2219 is attached to the BT blaze.

CERTIFIED RECORD OF LAND CORNER MONUMENTATION

HISTORY OF ORIGINAL CORNER ESTABLISHED:

Corner originally established by Henry Meldrum under GLO contract number 450 dated June 11th, 1882. Surveyor General field notes state:

Set post for 1/4 sec. cor.,
from which:

A Pine 48 ins. diam bears N 48° W 37 lks dist. marked 1/4 S
BT

A Fir 24 ins. diam bears S 12° E 55 lks dist. marked 1/4 S
BT

In 1998 Rick Robinson found no original evidence and set an aluminum pipe at proportion position as per Union County Survey 045-1998. Union County Monumentation Record 090-1998R states:

At position determined by survey, I set a 2 1/2" x 30" aluminum pipe with aluminum cap marked as shown below, 32" in the ground (2" below the surface of the roadway)
from which:

A 12" White Fir bears North 44° East a distance of 43.80 ft., marked 1/4 S17 BT.

A 20" Tamarack bears South 56° East a distance of 101.92 ft., marked 1/4 S20 BT.

A 13" Ponderosa Pine bears South 71° West a dist. of 72.33 ft., marked 1/4 S20 BT.

A 12" Ponderosa Pine bears North 8° West a dist. of 37.52 ft., marked 1/4 S17 BT.

T 1 S R 40 E N-07

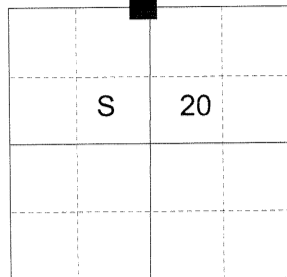

DESCRIPTION OF CORNER EVIDENCE FOUND:

A 2 1/2" x 30" aluminum pipe, 30" in the ground, mangled with no cap and bent to the West due to road excavation,
from which:

A 17" White Fir bears North 44° East a distance of 43.80 ft., alive and vigorous with healed blaze.

A 21" Tamarack bears South 56° East a distance of 101.92 ft., alive and vigorous with scribes visible on partially healed blaze.

An 18" Ponderosa Pine bears South 71° West a dist. of 72.33 ft., alive and vigorous with healed blaze.

A 14" Ponderosa Pine bears North 8° West a dist. of 37.52 ft., alive and vigorous with healed blaze.

DESCRIPTION OF MONUMENT AND ACCESSORIES I ESTABLISHED TO PERPETUATE THE ORIGINAL LOCATION OF THIS CORNER:

At record distance and bearing from found bearing trees I excavate the mangled pipe and set a 2 1/2" aluminum pipe with 2 1/2" aluminum cap marked as shown below, 34" in the ground (4" below the road surface),

I hereby certify that the corner was monumented on April 21, 2020.

Witness: Kyle A. Tucker

REGISTERED
PROFESSIONAL
LAND SURVEYOR

[Signature]
OREGON
June 2, 2010
JEFFREY S. HSU
83571

Renewal Date: June 30, 2021

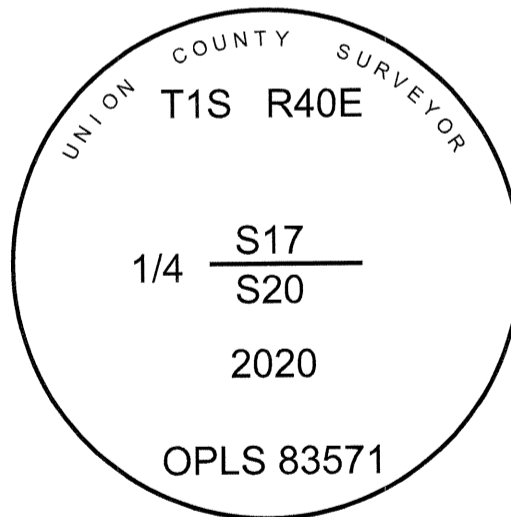

UNION COUNTY SURVEYOR

Date Received 4/23/20

Date Filed 4/23/20

Filed By *[Signature]* DEPUTY

File Number 029-2020R

I used a steel tape and magnetic compass in the establishment of the new accessories. I used 14° East declination, the distances are to a 60d spike driven into the right side of the root crown of the bearing trees. A brass washer marked OPLS 83571 is attached to the BT blaze of the new bearing trees.

HORIZONTAL CONTROL DATA

UNION COUNTY, OREGON

OREGON STATE PLANE, NORTH ZONE (3601)

STA NAME: 2020031

1/4 CORNER COMMON TO SECTIONS 17 AND 20

TWP. 1 S RGE. 40 E.

GEODETIC COORD: NAD 83(91)

DATE TIED: April 21, 2020

LAT: 45 ° 28 ' 16.74591 " N

SURVEYOR: JEFFREY S. HSU
OPLS 83571

LONG: 117 ° 50 ' 23.12275 " W

FIRM: BAGETT, GRIFFITH, & BLACKMAN
2006 ADAMS AVENUE
LAGRANDE, OR 97850
(541) 963-6092

SP. COOR: NAD 83(91)

N: 669163.865 INT FT.

E: 8884410.813 INT FT.

TYPE: GPS

THETA: 1 ° 53 ' 11.8 "

ORDER: SECOND CLASS: 1

SCALE FACTOR: 0.9999085055

ELEV: 3903.78 US FT.

ELEV: DATUM: NGVD 29

COMMENTS:

2 1/2" aluminum pipe with 2 1/2" aluminum cap
marked as shown

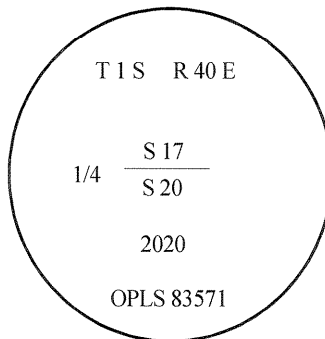

Renewal Date: June 30, 2021

1 METER = 3.2808333333... US FEET = 39.37 INCHES

1 METER = 3.280839895 INT'L FEET OR 1 INCH = 2.54 CM

TO CALCULATE ELEVATION FACTOR (IN THE NORTH AMERICAN CONTINENT)

DIVIDE 20,906,000 BY (20,906,000 + ELLIPSOID ELEV. IN FEET)