

**CERTIFIED RECORD OF LAND CORNER MONUMENTATION**

**HISTORY OF ORIGINAL CORNER ESTABLISHED:**

None

T 1 S R 40 E M-10

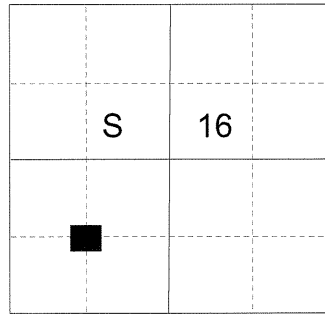

**DESCRIPTION OF CORNER EVIDENCE FOUND:**

None

See Survey No. 014-2015

**DESCRIPTION OF MONUMENT AND ACCESSORIES I ESTABLISHED TO PERPETUATE THE ORIGINAL LOCATION OF THIS CORNER:**

At the position determined by survey, I set a 5/8" x 30" iron pin with a 2 1/2" aluminum cap marked as shown below, 28" in the ground, with a collar of stone 2 foot diameter. From which:

**NEW BEARING TREES:**

A 17" White Fir bears South 74° East, a distance of 29.00 feet, marked SW 1/16 S16 BT.  
A 9" Douglas Fir bears North 25° West, a distance of 20.80 feet, marked SW 1/16 S16 BT.

I set a steel fencepost approximately 1 foot North of the corner monument.

I hereby certify that this corner was monumented on March 3, 2015.

Witness: Thomas J. Kopp



Renewal Date: June 30, 2015

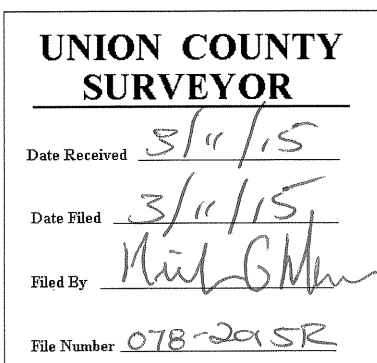
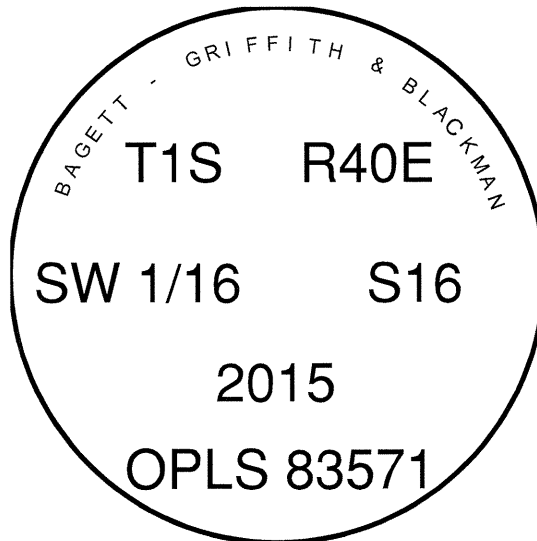

I used a steel tape and magnetic compass in the establishment of the new tree accessories. I used 16° East declination, the distances are to a 60d spike driven into the right side of the root crown of the new bearing trees. A brass washer marked OPLS 83571 is attached to the BT blaze of the new bearing trees.