

**CERTIFIED RECORD OF LAND CORNER MONUMENTATION**

**HISTORY OF ORIGINAL CORNER ESTABLISHED:**

Corner originally established by Henry Meldrum under GLO contract number 450 dated June 11, 1882. Surveyor General field notes state:

Set a basalt stone 24 x 15 x 7 ins., 18 ins. in ground for 1/4 sec. cor. marked 1/4 on W. face, from which:

A tamarack 12 ins. in dia. bears S60°W 63 lks. dist. marked 1/4 SBT

A pine 7 ins. in dia. bears S88°E 19 lks. dist. marked 1/4 SBT

In 1980 James H. Hambleton found the stone and used it's location as per Union County Survey Number 54-75. Survey states: Found stone marked 1/4 on the west face as per GLO notes.

T 1 S R 40 E L-21

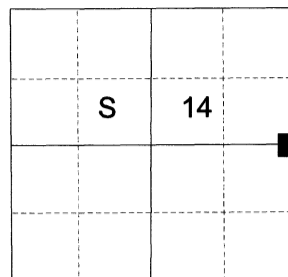

**DESCRIPTION OF CORNER EVIDENCE FOUND:**

Found a 1" iron pipe, from which,

A 24" x 15" x 7" stone uprooted and being utilized as a fence weight falls about 15' North of position, with a clearly chiseled 1/4 and painted red. Stone has been disturbed, the original position cannot be ascertained.

A 23" Western Larch bears South 55° West a dist. of 44.43 ft., dead and standing with scribes visible on opened blaze. A BLM Bearing Tree tag dated 8-8-77 and initialed R.M. states: Corner bears N55°E a dist. of 42'.

I believe the unrecorded pipe was likely a perpetuation of the original corner position, likely set adjacent to the original stone. As the bearing tree is the only remaining original evidence to be confirmed to be in its original position, I establish the true corner position in line with the iron pipe, and at the record 63 lks. dist. From this position, the iron pipe falls North 55° East, a distance of 2.85 ft. The above mentioned Western Larch bears South 55° West, a distance of 41.58 ft.

**DESCRIPTION OF MONUMENT AND ACCESSORIES I ESTABLISHED TO MONUMENT THE ORIGINAL LOCATION OF THIS CORNER:**

At record GLO distance from the SW bearing tree and in line with the iron pipe monument, I set a 2 1/2" x 30" aluminum pipe, 28" in the ground, with 3" aluminum cap marked as shown below and in a 2 ft. diam. collar of stone with original stone buried face down on the North side, from which:

**NEW BEARING OBJECTS:**

The existing 1" iron pipe bears North 55° East, a dist. of 2.85 ft., firmly set in ground with 6" above ground

A 7" Spruce bears South 48° East, a dist. of 16.35 ft., marked 1/4 S13 BT.

A 4" Spruce bears South 24° West, a dist. of 4.95 ft., marked 1/4 S14 BT.

A 6" Western Larch bears North 8° West, a dist. of 30.70 ft., marked 1/4 S14 BT.

Set steel fence post approx. 1 ft. East

Fence corner to North/South/East bearing fence lines falls North approx. 4.5 ft.

I hereby certify that the corner was monumented on May 19, 2022.

Witness: Kyle A. Tucker

I used a steel tape and magnetic compass in the establishment of the new accessories. I used 14° East declination, the distances are to a 60d spike driven into the right side of the root crown of the bearing trees. A brass washer marked OPLS 83571 is attached to the BT blaze of the new bearing trees.

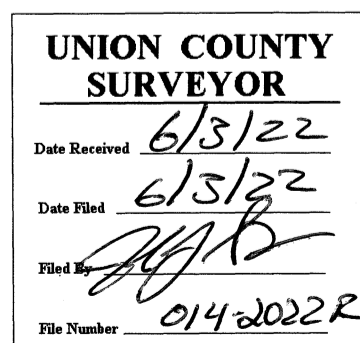
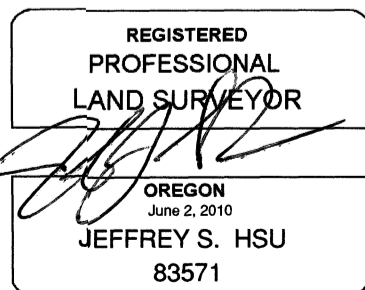
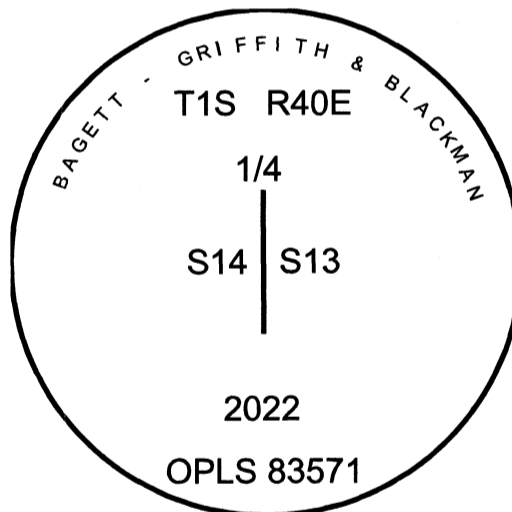

Renewal Date: June 30, 2023

**HORIZONTAL CONTROL DATA**  
**UNION COUNTY, OREGON**  
**OREGON STATE PLANE, NORTH ZONE (3601)**

STA NAME: 20220016

1/4 SECTION CORNER COMMON TO SECTIONS 13 AND 14

TWP. 1 S RGE. 40 E.

GEODETIC COORD: NAD 83(91)

DATE TIED: June 10, 2022

LAT: 45 ° 28 ' 42.83159 " N

SURVEYOR: JEFFREY S. HSU  
OPLS 83571

LONG: 117 ° 46 ' 3.89641 " W

FIRM: BAGETT, GRIFFITH, & BLACKMAN  
2006 ADAMS AVENUE  
LAGRANDE, OR 97850  
(541) 963-6092

SP. COOR: NAD 83(91)

N: 672420.631 INT FT.

E: 8902783.290 INT FT.

TYPE: GPS

THETA: 1 ° 56 ' 15.6 "

ORDER: SECOND CLASS: 1

SCALE FACTOR: 0.999909181

ELEV: 4554.07 US FT.

ELEV: DATUM: NGVD 29

**COMMENTS:**

2 1/2" aluminum monument with 3" cap  
marked as shown, set in mound of stone

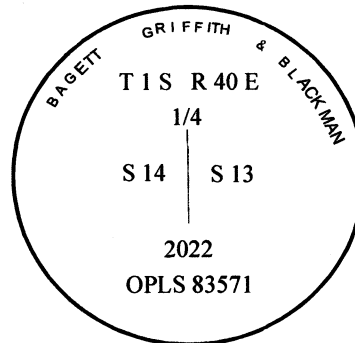

Renewal Date: June 30, 2023

1 METER = 3.280833333... US FEET = 39.37 INCHES

1 METER = 3.280839895 INT'L FEET OR 1 INCH = 2.54 CM

TO CALCULATE ELEVATION FACTOR ( IN THE NORTH AMERICAN CONTINENT)

DIVIDE 20,906,000 BY (20,906,000 + ELLIPSOID ELEV. IN FEET)

GEOID MODEL : 2012B