

**CERTIFIED RECORD OF LAND CORNER MONUMENTATION**

**HISTORY OF ORIGINAL CORNER ESTABLISHMENT:**

Corner originally established by Henry Meldrum under GLO contract Number 450, dated June 11, 1882. Surveyor General record states:  
 Set post from which:  
 A Pine 40" dia. bears S47°W, 120 lks.  
 A Pine 20" dia. bears S42°E, 43 lks.

GLO notes also call a 40" Pine line tree at 34.27 chains.

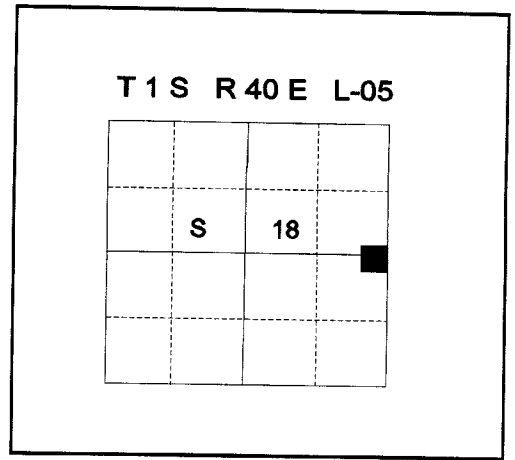

No record of subsequent monumentation found in Union County survey records.

**DESCRIPTION OF CORNER EVIDENCE FOUND:**

No evidence of the bearing trees or the line tree called to the South was found.

See Union County Survey 025-1996

**DESCRIPTION OF MONUMENT AND ACCESSORIES I ESTABLISHED**

**TO PERPETUATE THE ORIGINAL LOCATION OF THIS CORNER:**

At the proportioned position I set a 2½" x 30" aluminum pipe with aluminum cap marked as shown below, 24" in the ground, from which:

- A 25" Ponderosa Pine bears N50°E, 4.30 feet, marked 1/4 S17 BT.
- A 11" White Fir bears S24°E, 58.16 feet, marked 1/4 S17 BT.
- A 14" Ponderosa Pine bears S47°W, 31.37 feet, marked 1/4 S18 BT.
- A 14" White Fir bears N22°W, 34.67 feet, marked 1/4 S18 BT.

I hereby certify that the corner was monumented on June 24, 1996.  
 Witness: Mark Durbin, Jeff Madsen

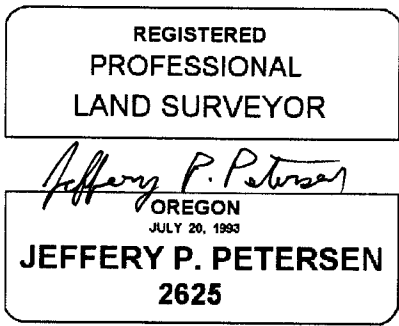

*Renewal Date: December, 31 1996*

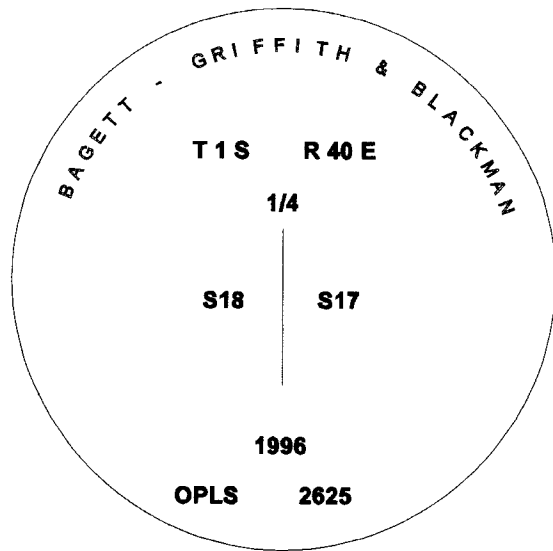

**UNION COUNTY SURVEYOR**

Date Received 7-30-96

Date Filed 7-31-96

Filed By R. ROBINSON, DEPUTY

File Number 082-1996R

I used a steel tape and magnetic compass in the establishment of the new accessories. I used 18° East declination, the distances are to a 60d spike driven into the right side of the root crown of the bearing trees. A brass washer marked OPLS 2625 is attached to the bearing tree blaze.

**CERTIFIED RECORD OF LAND CORNER MONUMENTATION**

**HISTORY OF ORIGINAL CORNER ESTABLISHED:**

Corner originally established by Henry Meldrum under GLO contract number 450 dated June 11<sup>th</sup>, 1882. Surveyor General field notes state:

Set a post 3 ft. long, 3 ins. sqr. 24 ins. in ground for 1/4 section corner marked 1/4 on W face, from which:

A Pine 40 ins. diam bears S 47° W 120 lks dist. marked 1/4 S BT

A Pine 20 ins. diam bears S 42° E 43 lks dist. marked 1/4 S BT

In 1996 Jeffery Peterson set an aluminum pipe at proportion position as per Union County Survey 025-1996.

Union County Monumentation Record 082-1996R states:

At the proportioned position, I set a 2 1/2" x 30" aluminum pipe with aluminum cap marked as shown below, 24" in the ground, from which:

A 25" Ponderosa Pine bears North 50° East a distance of 4.30 ft., marked 1/4 S17 BT.

An 11" White Fir bears South 24° East a distance of 58.16 ft., marked 1/4 S17 BT.

A 14" Ponderosa Pine bears South 47° West a dist. of 31.37 ft., marked 1/4 S18 BT.

A 14" White Fir bears North 22° West a dist. of 34.67 ft., marked 1/4 S18 BT.

T 1 S R 40 E L-05

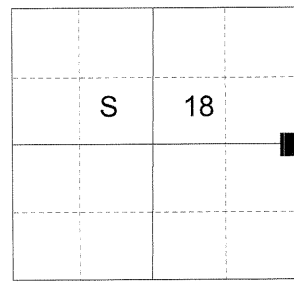

**DESCRIPTION OF CORNER EVIDENCE FOUND:**

A 2 1/2" aluminum pipe with 2 1/2" aluminum cap marked as shown below, 6" above ground, in a 2' diam. mound of stone, from which:

A 30" Ponderosa Pine bears North 50° East a distance of 4.30 ft., dead and standing 7' with scribes visible on partially healed blaze.

A 14" White Fir bears South 24° East a distance of 58.16 ft., dead and standing 5' with healed blaze.

A 16" Ponderosa Pine bears South 47° West a dist. of 31.37 ft., dead and standing 7' with scribes visible on partially healed blaze.

A 19" White Fir bears North 22° West a dist. of 34.67 ft., dead and standing 6' with healed blaze.

A fence post bears approx. 1' South

**DESCRIPTION OF MONUMENT AND ACCESSORIES I ESTABLISHED TO PERPETUATE THE ORIGINAL LOCATION OF THIS CORNER:**

**NEW BEARING OBJECTS:**

A 9" Douglas Fir bears North 12° East a dist. of 41.65 ft., marked 1/4 S17 BT.

A 5" Douglas Fir bears South 82° East a dist. of 31.00 ft., marked X BT.

A 7" Douglas Fir , bears South 10° West a dist. of 44.75 ft., marked 1/4 S18 BT.

A 5" Douglas Fir bears North 61° West a dist. of 27.75 ft., marked 1/4 S18 BT.

Falls approx. 4' West of old North/South bearing fence line.

I hereby certify that the corner was perpetuated on April 20, 2020.

Witness: Kyle A. Tucker

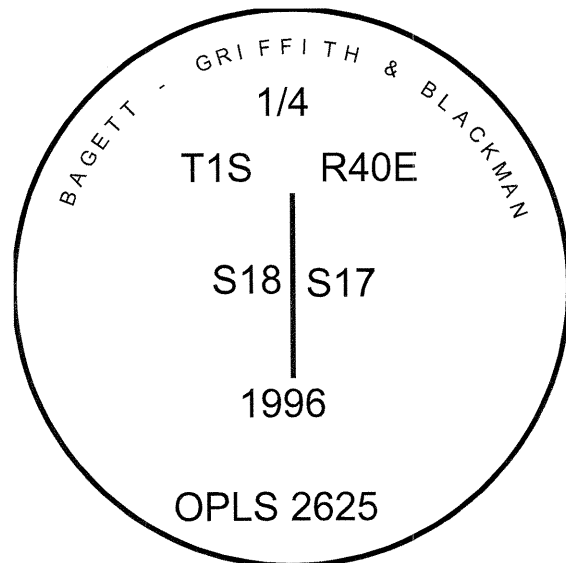

Renewal Date: June 30, 2021

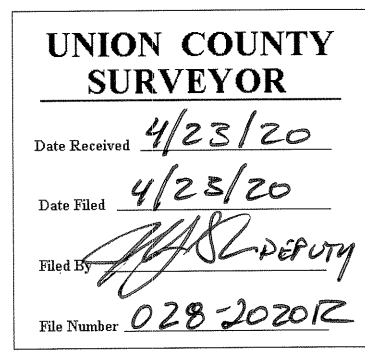

I used a steel tape and magnetic compass in the establishment of the new accessories. I used 14° East declination, the distances are to a 60d spike driven into the right side of the root crown of the bearing trees. A brass washer marked OPLS 83571 is attached to the BT blaze of the new bearing trees.

**HORIZONTAL CONTROL DATA**  
**UNION COUNTY, OREGON**  
**OREGON STATE PLANE, NORTH ZONE (3601)**

STA NAME: 2020027

1/4 SECTION CORNER COMMON TO SECTIONS 17 AND 18

TWP. 1 S RGE. 40 E.

GEODETIC COORD: NAD 83(91)

DATE TIED: April 21, 2020

LAT: 45 ° 28 ' 42.38551 " N

SURVEYOR: JEFFREY S. HSU  
OPLS 83571

LONG: 117 ° 51 ' 0.18022 " W

FIRM: BAGETT, GRIFFITH, & BLACKMAN  
2006 ADAMS AVENUE  
LAGRANDE, OR 97850  
(541) 963-6092

SP. COOR: NAD 83(91)

N: 671672.443 INT FT.

E: 8881686.419 INT FT.

TYPE: GPS

THETA: 1 ° 52 ' 45.5 "

ORDER: SECOND CLASS: 1

SCALE FACTOR: 0.9999091692

ELEV: 3778.25 US FT.

ELEV: DATUM: NGVD 29

COMMENTS:

2 1/2" aluminum pipe with 2 1/2" aluminum cap  
marked as shown, 6" above ground

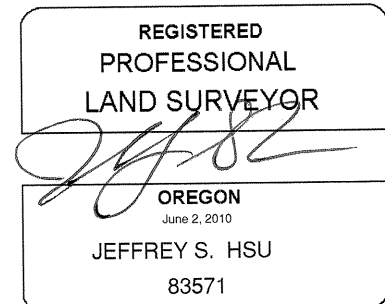
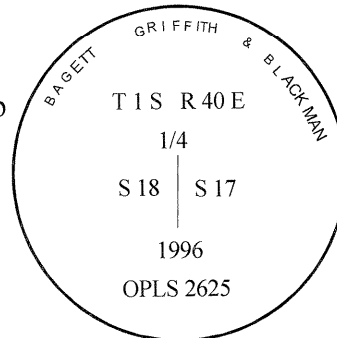

Renewal Date: June 30, 2021

1 METER = 3.280833333... US FEET = 39.37 INCHES

1 METER = 3.280839895 INT'L FEET OR 1 INCH = 2.54 CM

TO CALCULATE ELEVATION FACTOR ( IN THE NORTH AMERICAN CONTINENT)

DIVIDE 20,906,000 BY (20,906,000 + ELLIPSOID ELEV. IN FEET)