

**CERTIFIED RECORD OF LAND CORNER MONUMENTATION**

**History of original corner establishment:**

Corner originally established by Timothy W. Davenport under GLO contract Number 102, dated July 20, 1863. Surveyor General record states: Set post from which:  
 A Pine 30" dia. bears S20°E, 274 lks.  
 A Pine 40" dia. bears S42°W, 427 lks.

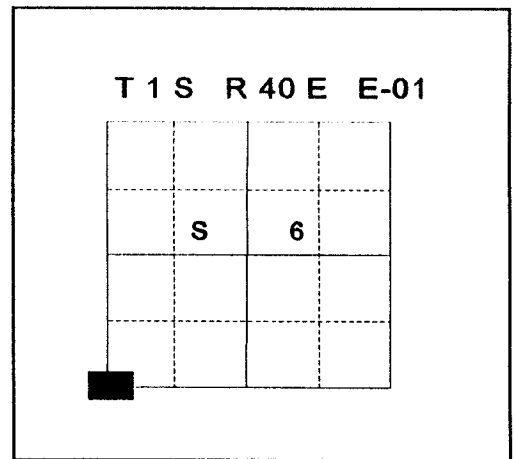

Union County survey 53-74 calls "Found 2 stumps of correct size and location".

No record of subsequent monumentation found in Union County survey records.

**Description of corner evidence found:**

Found large rotted Pine stumps at the record calls as per GLO notes.

See Union County Survey 025-1996

**Description of monument and accessories I established to perpetuate the original location of this corner:**

At record bearing and distance from the found BT stumps I set a 2½" x 30" aluminum pipe with aluminum cap marked as shown below, 36" in the ground, 6" under the surface of Indian Creek Road, from which:

- A 5/8" x 30" rebar bears N52°E, 42.26 feet, with 1 1/2" aluminum cap marked UNION COUNTY SURVEYOR NE RP.
- A 37" Ponderosa Pine bears S51°E, 34.13 feet, marked T1S R40E S7 BT.
- A 10" Ponderosa Pine bears S20°W, 118.94 feet, marked T1S R39E S12 BT.
- A 5/8" x 30" rebar bears N54°W, 51.12 feet, with 1 1/2" aluminum cap marked UNION COUNTY SURVEYOR NW RP.

I hereby certify that the corner was monumented on June 21, 1996.  
 Witness: Mark Durbin, Jeff Madsen

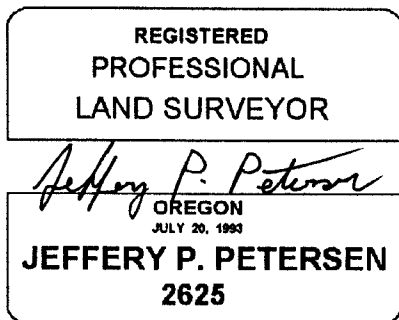

Renewal Date: December, 31 1996

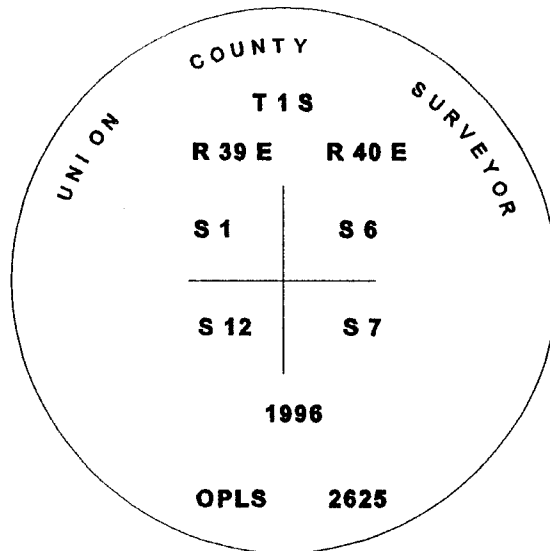

**UNION COUNTY SURVEYOR**

Date Received 7-3-96

Date Filed 7-3-96

Filed By R. ROBINSON, Deputy

File Number 058-1996R

I used a steel tape and magnetic compass in the establishment of the new accessories. I used 18° East declination, the distances are to a 60d spike driven into the right side of the root crown of the bearing trees or to the center of the caps on the reference pins.

**CERTIFIED RECORD OF LAND CORNER MONUMENTATION**

**HISTORY OF ORIGINAL CORNER ESTABLISHED:**

Corner originally established by Timothy W. Davenport under GLO contract Number 102, dated July 20, 1863. Surveyor General record states:  
Set post from which:  
A Pine 30" dia. bears S20°E, 274 lks.  
A Pine 40" dia. bears S42°W, 427 lks.

T 1 S R 40 E E-01

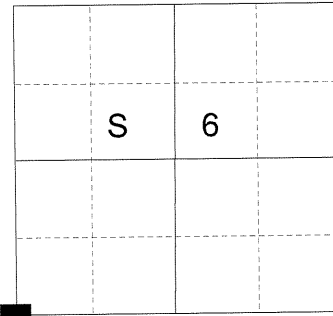

Union County survey 53-74 calls "Found 2 stumps of correct size and location".

In 1996, Jeffery P. Petersen brings this corner up to modern standards, at record bearing and distance from found original bearing tree remains.

Union County Monumentation record 058-1996R states:  
I set a 2 1/2" x 30" aluminum pipe with aluminum cap, 36" in the ground, 6" under the surface of Indian Creek Road, from which:

- A 5/8" x 30" rebar bears N52°E, 42.46 feet, with 1 1/2" aluminum cap marked UNION COUNTY SUREVEYOR NE RP.
- A 37" Ponderosa Pine S51°E, 34.14 feet, marked T1S R40E S7 BT.
- A 10" Ponderosa Pine bears S20°W, 118.94 feet, marked T1S R39E S12 BT.
- A 5/8" x 30" rebar bears N54°W, 51.12 feet, with 1 1/2" aluminum cap marked UNION COUNTY SURVEYOR NW RP.

**DESCRIPTION OF CORNER EVIDENCE FOUND:**

A 2 1/2" aluminum cap marked as shown below, 3" below road surface, from which:

- A 5/8" iron pin bears North 52° East, a distance of 42.26 feet, with a 1 1/2" aluminum cap marked UNION COUNTY SURVEYOR NE RP.
- A deteriorated Ponderosa Pine dead and down, the stump which bears South 51° East, a distance of 34.14 feet, with scribe marks visible on open blaze on stump.
- A 19" Ponderosa Pine bears South 20° West, a distance of 118.94 feet, alive and vigorous with a healed blaze.
- A 5/8" iron pin bears North 54° West, a distance of 51.12 feet, missing the aluminum cap.

**DESCRIPTION OF MONUMENT AND ACCESSORIES I ESTABLISHED TO PERPETUATE THE ORIGINAL LOCATION OF THIS CORNER:**

From the aluminum pipe monument,

**NEW BEARING OBJECTS:**

- A 5/8" iron pin bears South 41° East, a distance of 31.00 feet, with a 1 1/2" aluminum cap marked UNION COUNTY SURVEYOR SE RP.
- I add a 1 1/2" aluminum cap marked UNION COUNTY SURVEYOR NW RP, to the existing Northwest iron pin bearing object.

I hereby certify that this corner was perpetuated on June 11, 2015.

Witness: Thomas J. Kopp



Renewal Date: June 30, 2017

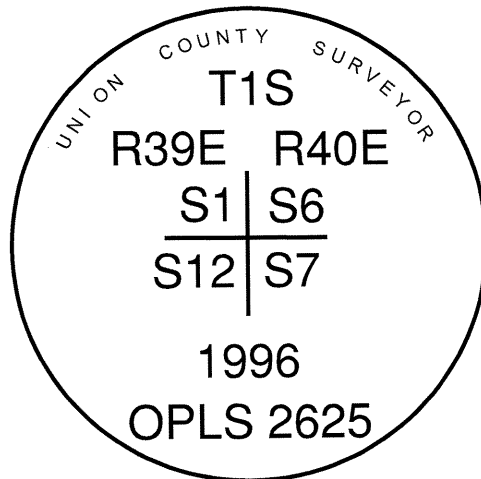

**UNION COUNTY SURVEYOR**

Date Received 6/18/15

Date Filed 6/18/15

Filed By [Signature]

File Number 109-2015R

I used a steel tape and magnetic compass in the establishment of the new pin accessory. Bearings and distances are to the center of the aluminum cap. Magnetic declination is 16° East.

# HORIZONTAL CONTROL DATA

## UNION COUNTY, OREGON

### OREGON STATE PLANE, NORTH ZONE (3601)

STA NAME: 201521

SECTION CORNER COMMON TO SECTIONS 1, 6, 7 and 12

TWP. 1 S. RGE. 39 & 40 E. GEODETIC COORD: NAD 83(91)

DATE TIED: June 11, 2015 LAT: 45 ° 30 ' 1.02982 " N

SURVEYOR: RICK G. ROBINSON OPLS 2219 LONG: 117 ° 52 ' 13.55862 " W

FIRM: BAGETT, GRIFFITH, & BLACKMAN SP. COOR: NAD 83(91)

2006 ADAMS AVENUE

LAGRANDE, OR 97850

(541) 963-6092

N: 679462.441 INT FT.

E: 8876201.829 INT FT.

TYPE: GPS THETA: 1 ° 51 ' 53.4678568 "

ORDER: SECOND CLASS: 1 SCALE FACTOR: 0.9999113017

ELEV: 3071.57 US FT.

ELEV: DATUM: NGVD 29

COMMENTS:

2 ½" Aluminum monument in  
Indian Creek Road 6" below surface

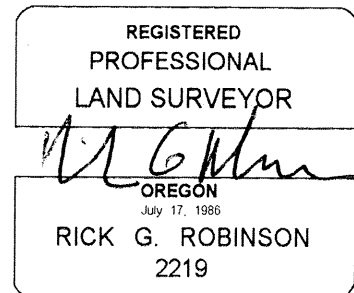
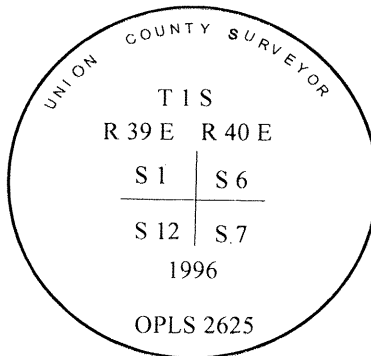

Renewal Date: December 31, 2016

1 METER = 3.2808333333... US FEET = 39.37 INCHES

1 METER = 3.280839895 INT'L FEET OR 1 INCH = 2.54 CM

TO CALCULATE ELEVATION FACTOR ( IN THE NORTH AMERICAN CONTINENT)

DIVIDE 20,906,000 BY (20,906,000 + ELLIPSOID ELEV. IN FEET)