

CERTIFIED RECORD OF LAND CORNER MONUMENTATION

HISTORY OF ORIGINAL CORNER ESTABLISHED:

Corner originally established by Henry Meldrum under GLO contract 450, dated June 11, 1882. Surveyor General field notes state:

Intersect Base Line 125 lks. West of Cor. to secs 31 and 32 on point of rock above Clark Creek. Set Basalt stone 16x12x5 on Rocky point - impossible to set stone in ground or to build mound of stone alongside on account of sideling ground - so built mound of stone around corner which is marked CC with 1 notch on W and 5 notches on E edges. No trees convenient.

T 1 S R 40 E A-05

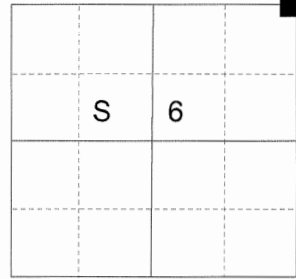

DESCRIPTION OF CORNER EVIDENCE FOUND:

None.

SEE PARTITION PLAT NUMBER 20160020T

DESCRIPTION OF MONUMENT AND ACCESSORIES I ESTABLISHED

TO PERPETUATE THE ORIGINAL LOCATION OF THIS CORNER:

At record bearing and distance from the SE corner of Section 31 T1N R40E, I set a 5/8" x 30" iron pin monument, with 2 1/2" aluminum cap attached, marked as shown below, 15" in the ground, in a collar of stone, 1 ft. in diameter, from which:

NEW BEARING OBJECTS:

A rock outcrop bears South 69°05' West, a distance of 17.39 feet, marked X BO.
A rock outcrop bears South 38°03' East, a distance of 29.36 feet, marked X BO.
Witness corner to the Standard Cor between Sections 31 and 32, T1N, R40E bears North 89°46'47" East, a distance of 77.50 feet.

No other bearing objects convenient.

I hereby certify that this monument was set October 19, 2016.

REGISTERED
PROFESSIONAL
LAND SURVEYOR

OREGON
June 2, 2010
JEFFREY S. HSU
83571

Renewal Date: June 30, 2017

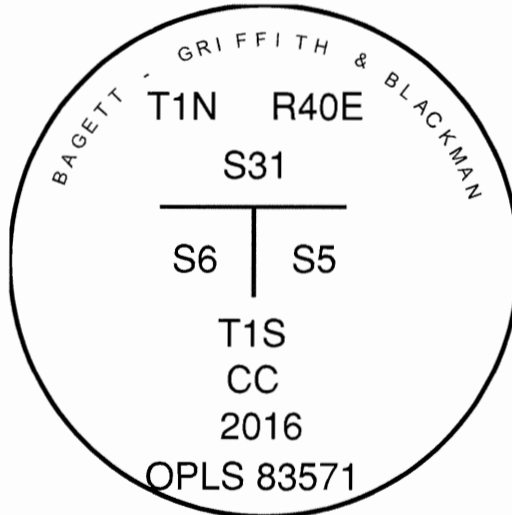

UNION COUNTY SURVEYOR

Date Received 10/31/16

Date Filed 10/31/16

Filed By [Signature]

File Number 044-2016R

I use a RTK GPS unit in the establishment of the accessories. Basis of Bearings is as per Partition Plat for Kent Coppiner filed concurrently. Bearings and distances are to the center of the aluminum caps.

HORIZONTAL CONTROL DATA

UNION COUNTY, OREGON

OREGON STATE PLANE, NORTH ZONE (3601)

STA NAME: 201616

SECTION CORNER COMMON TO SECTIONS 5 AND 6 ONLY

TWP. 1 S. RGE. 40 E.

GEODETIC COORD: NAD 83(91)

DATE TIED: October 27, 2016

LAT: 45 ° 30 ' 53.35581 " N

SURVEYOR: RICK G. ROBINSON
OPLS 2219

LONG: 117 ° 51 ' 0.20253 " W

FIRM: BAGETT, GRIFFITH, & BLACKMAN
2006 ADAMS AVENUE
LAGRANDE, OR 97850
(541) 963-6092

SP. COOR: NAD 83(91)

N: 684929.816 INT FT.

E: 8881249.831 INT FT.

TYPE: GPS

THETA: 1 ° 52 ' 45.4909729 "

ORDER: SECOND CLASS: 1

SCALE FACTOR: 0.9999128013

ELEV: 3179.27 US FT.

ELEV: DATUM: NGVD 29

COMMENTS:

5/8" iron pin with 2 1/2" aluminum cap marked
as shown, in mound of stone

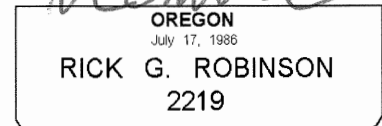
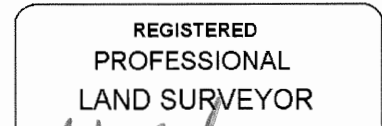
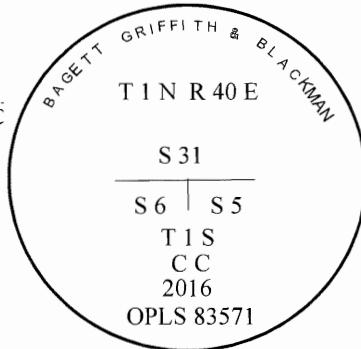

Renewal Date: December 31, 2016

1 METER = 3.2808333333... US FEET = 39.37 INCHES

1 METER = 3.280839895 INT'L FEET OR 1 INCH = 2.54 CM

TO CALCULATE ELEVATION FACTOR (IN THE NORTH AMERICAN CONTINENT)

DIVIDE 20,906,000 BY (20,906,000 + ELLIPSOID ELEV. IN FEET)