

**CERTIFIED RECORD OF LAND CORNER MONUMENTATION**

**HISTORY OF ORIGINAL CORNER ESTABLISHED:**

Corner not originally established. Position originally established by Henry Meldrum under GLO contract 450, dated June 11, 1882.

T 1 S R 40 E A-03

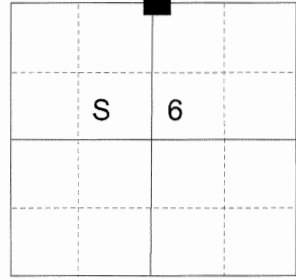

**DESCRIPTION OF CORNER EVIDENCE FOUND:**

None.

SEE PARTITION PLAT NUMBER 20160020T

**DESCRIPTION OF MONUMENT AND ACCESSORIES I ESTABLISHED**

**TO PERPETUATE THE ORIGINAL LOCATION OF THIS CORNER:**

At position determined by survey, I set a 2 ½" x 30" aluminum pipe monument, with 2 ½" aluminum cap attached, marked as shown below, 15" in the ground, in a mound of stone, 5 ft. in diameter, from which:

**NEW BEARING OBJECTS:**

A 5/8"x30" iron pin bears North 41°38" West, a distance of 18.00 feet, with 1 ½" aluminum cap marked BGB SURVEY MARKER NW RP.

A 5/8"x30" iron pin bears South 43°12' West, a distance of 17.14 feet, with 1 ½" aluminum cap marked BGB SURVEY MARKER SW RP.

The South quarter corner of Section 31, T1N, R40E, bears South 89°54'42" East, a distance of 32.98 feet.

A 5/8"x30" iron pin bears South 59°40' East a distance of 38.75 feet, with 1 ½" aluminum cap marked BGB SURVEY MARKER S RP.

I hereby certify that this monument was set October 21, 2016.

**REGISTERED  
PROFESSIONAL  
LAND SURVEYOR**



**OREGON**  
June 2, 2010  
**JEFFREY S. HSU**  
83571

Renewal Date: June 30, 2017

BAGETT - GRIFFITH & BLACKMAN

T1N R40E

---

1/4 S6

T1S

2016

OPLS 83571

**UNION COUNTY  
SURVEYOR**

Date Received 10/31/16

Date Filed 10/31/16

Filed By [Signature]

File Number 045-2016R

I use a RTK GPS unit in the establishment of the accessories. Basis of Bearings is as per Partition Plat for Kent Coppinger filed concurrently. Bearings and distances are to the center of the aluminum caps.

**HORIZONTAL CONTROL DATA**  
**UNION COUNTY, OREGON**  
**OREGON STATE PLANE, NORTH ZONE (3601)**

STA NAME: 201612

1/4 SECTION CORNER COMMON TO SECTION 6 ONLY

TWP. 1 S. RGE. 40 E.

GEODETIC COORD: NAD 83(91)

DATE TIED: October 21, 2016

LAT: 45 ° 30 ' 53.26400 " N

SURVEYOR: RICK G. ROBINSON  
OPLS 2219

LONG: 117 ° 51 ' 36.92014 " W

FIRM: BAGETT, GRIFFITH, & BLACKMAN  
2006 ADAMS AVENUE  
LAGRANDE, OR 97850  
(541) 963-6092

SP. COOR: NAD 83(91)

N: 684834.950 INT FT.

E: 8878637.094 INT FT.

TYPE: GPS

THETA: 1 ° 52 ' 19.4513528 "

ORDER: SECOND CLASS: 1

SCALE FACTOR: 0.9999127986

ELEV: 3216.78 US FT.

ELEV: DATUM: NGVD 29

COMMENTS:

2 1/2" aluminum monument with cap marked  
as shown, in mound of stone

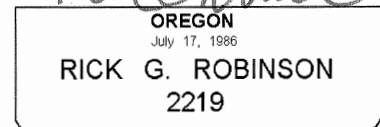
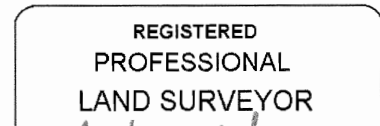

Renewal Date: December 31, 2016

1 METER = 3.2808333333... US FEET = 39.37 INCHES

1 METER = 3.280839895 INT'L FEET OR 1 INCH = 2.54 CM

TO CALCULATE ELEVATION FACTOR ( IN THE NORTH AMERICAN CONTINENT)

DIVIDE 20,906,000 BY (20,906,000 + ELLIPSOID ELEV. IN FEET)